

30 Revit Productivity Enhancements You've Missed!

Jason Boehning
Building Content Manager
Katie Watton
Building Content Specialist

Join the conversation #AU2017



Enter to Win an M3D Micro 3D Printer

When You Activate Your FREE 30-Day Subscription to CADLearning!

Entering is Easy!

Simply activate your FREE 30-Day subscription using your CADLearning poker chip ***no later than 11/30/17.***

By activating your FREE trial, you'll automatically be entered into a drawing to win this M3D Micro 3D Printer!

www.cadlearning.com/free30daytrial



*Poker chips are limited in availability.



Winner will be announced on December 1, 2017.

Introduction

- Many companies are working in multiple versions of Revit



Introduction

- Minor updates get overlooked from year to year



Introduction

- Presentation features:
 - Description of update along with year it was released

30 Enhancements Number

#15 Visibility of Point Clouds ← Update

Update Description

- Control the **Visibility** and **Color Mode** of linked point cloud:
 - Scan Locations
 - Scan Regions

Release

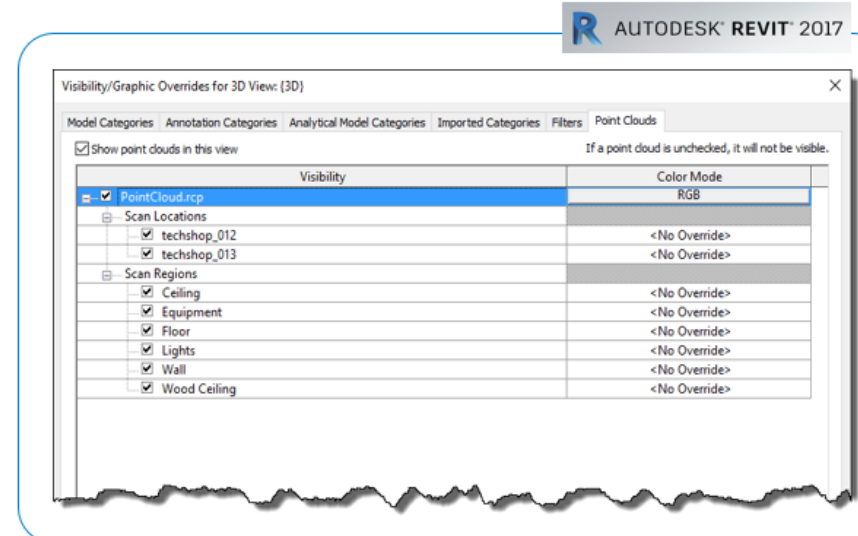

Introduction

- Presentation features:
 - Description of update along with year it was released
 - Live demo for some enhancements
 - All updates persist to most recent release of Revit



#1 Images in Schedules

- Component images can be added to schedules
 - **Image** instance parameter
 - **Type Image** parameter

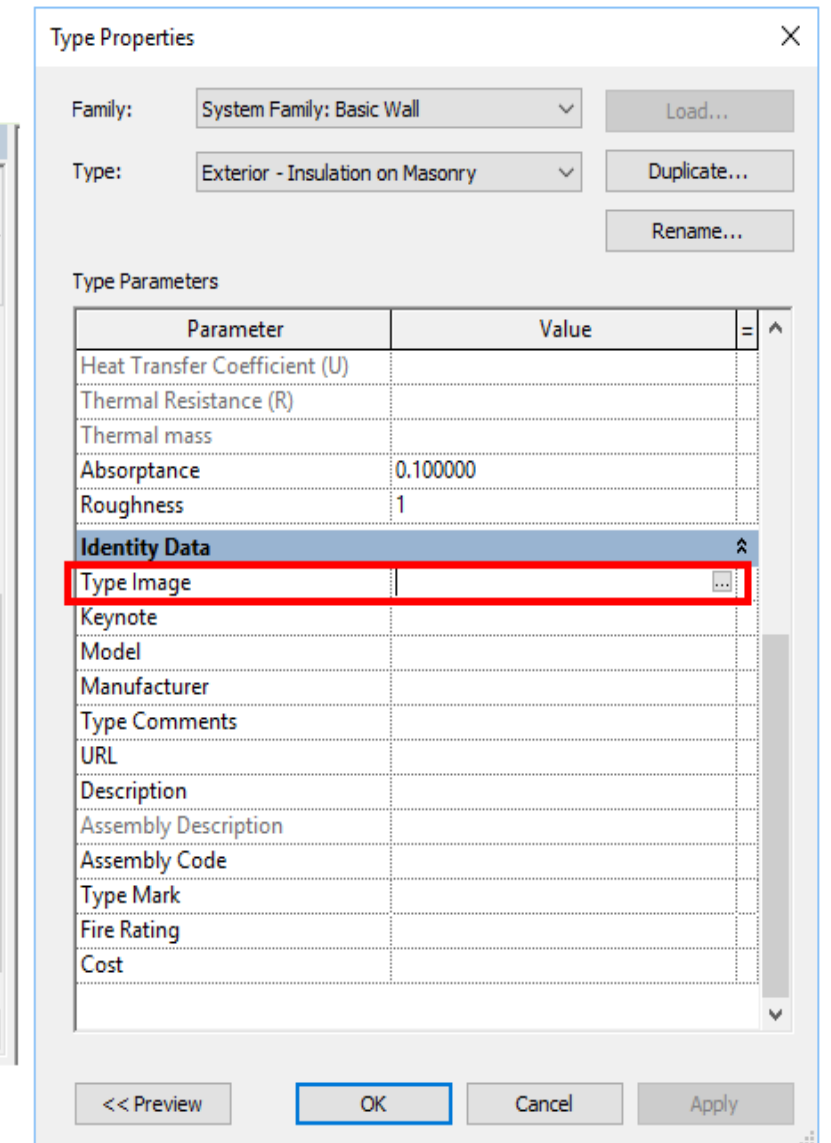
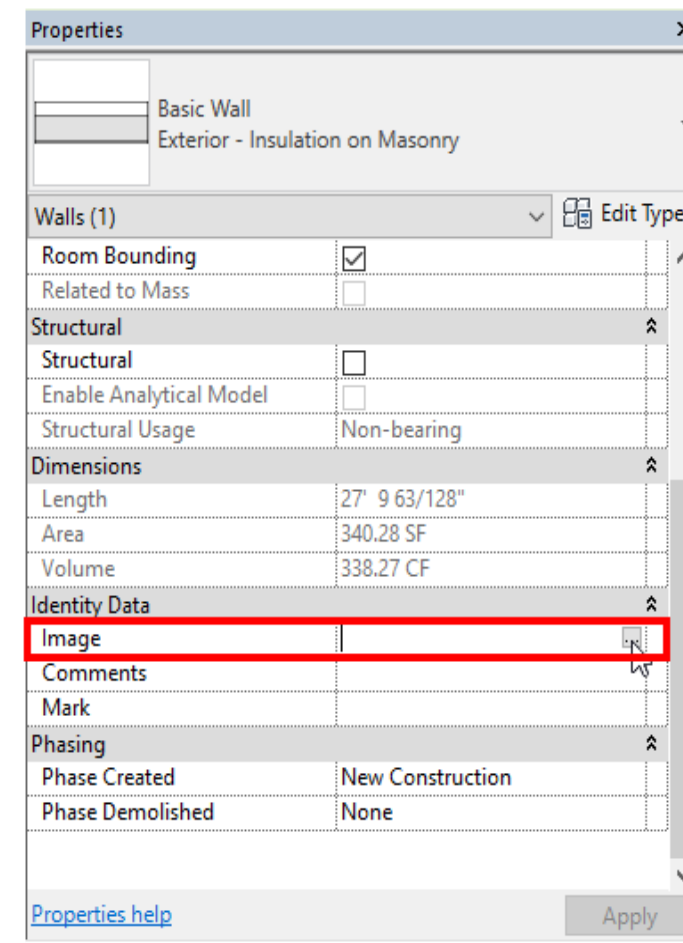
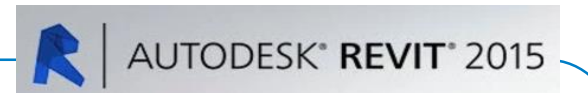

#2 Add Links in Manage Links Dialog

- Quickly link additional:
 - Revit models
 - IFC Files
 - CAD formats
 - Point clouds

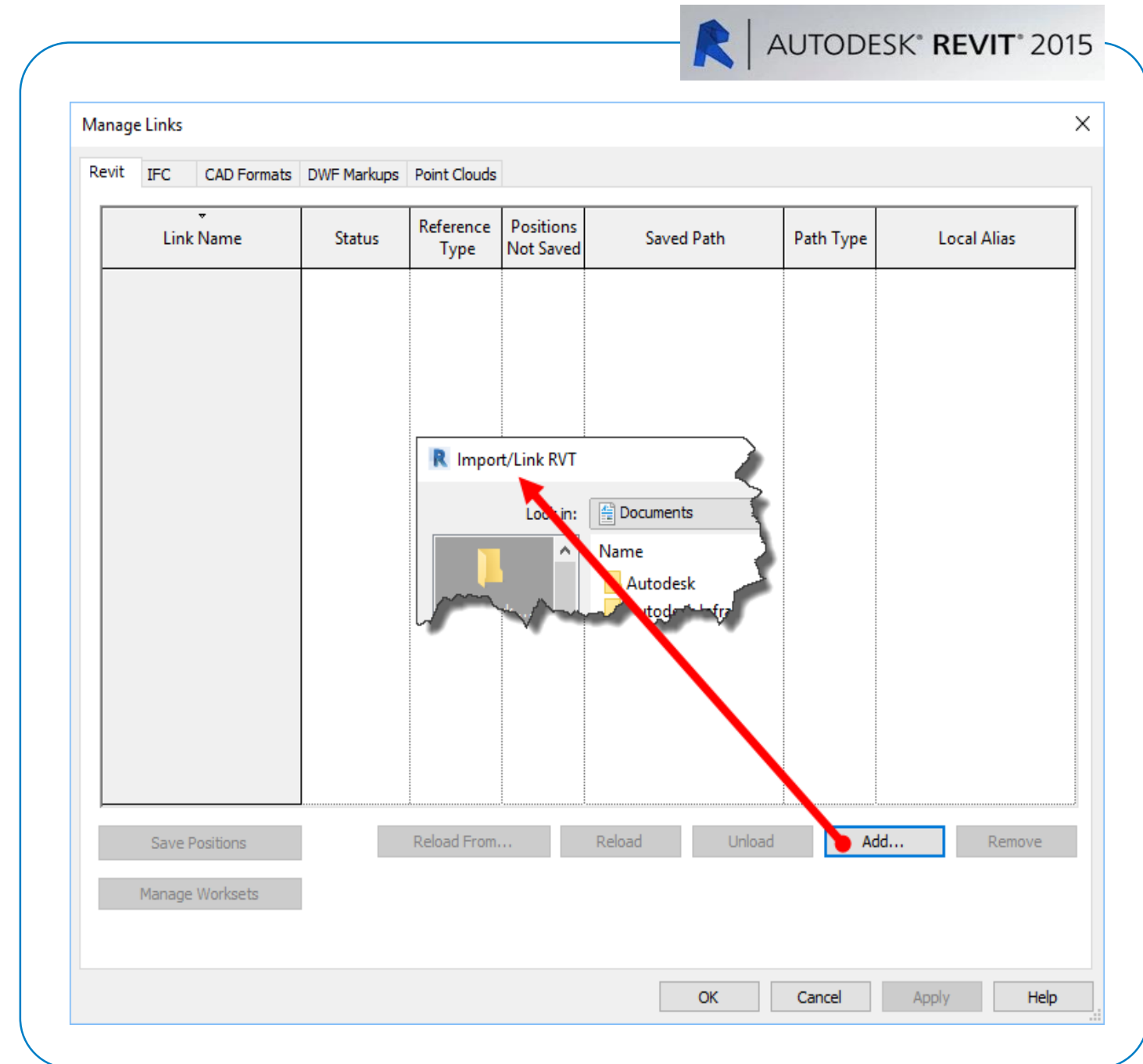

#3 PDF Export

- Table of contents
- View tags are hyperlinked



AUTODESK® REVIT® 2015 R2

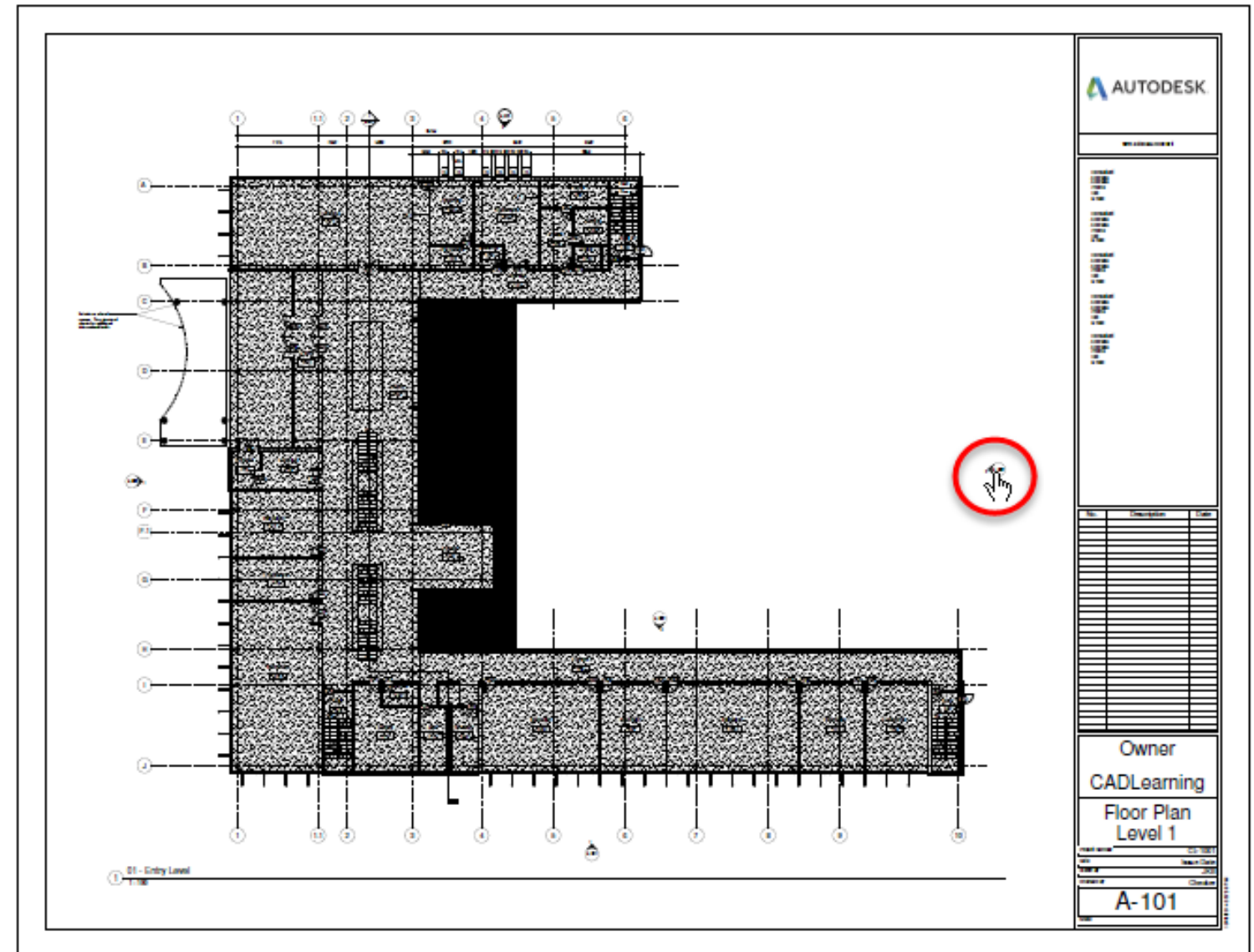

#4 Search Feature for Type Selector and Other Drop-downs

- Type a keyword in the **Search** field
- List will filter based on the keyword

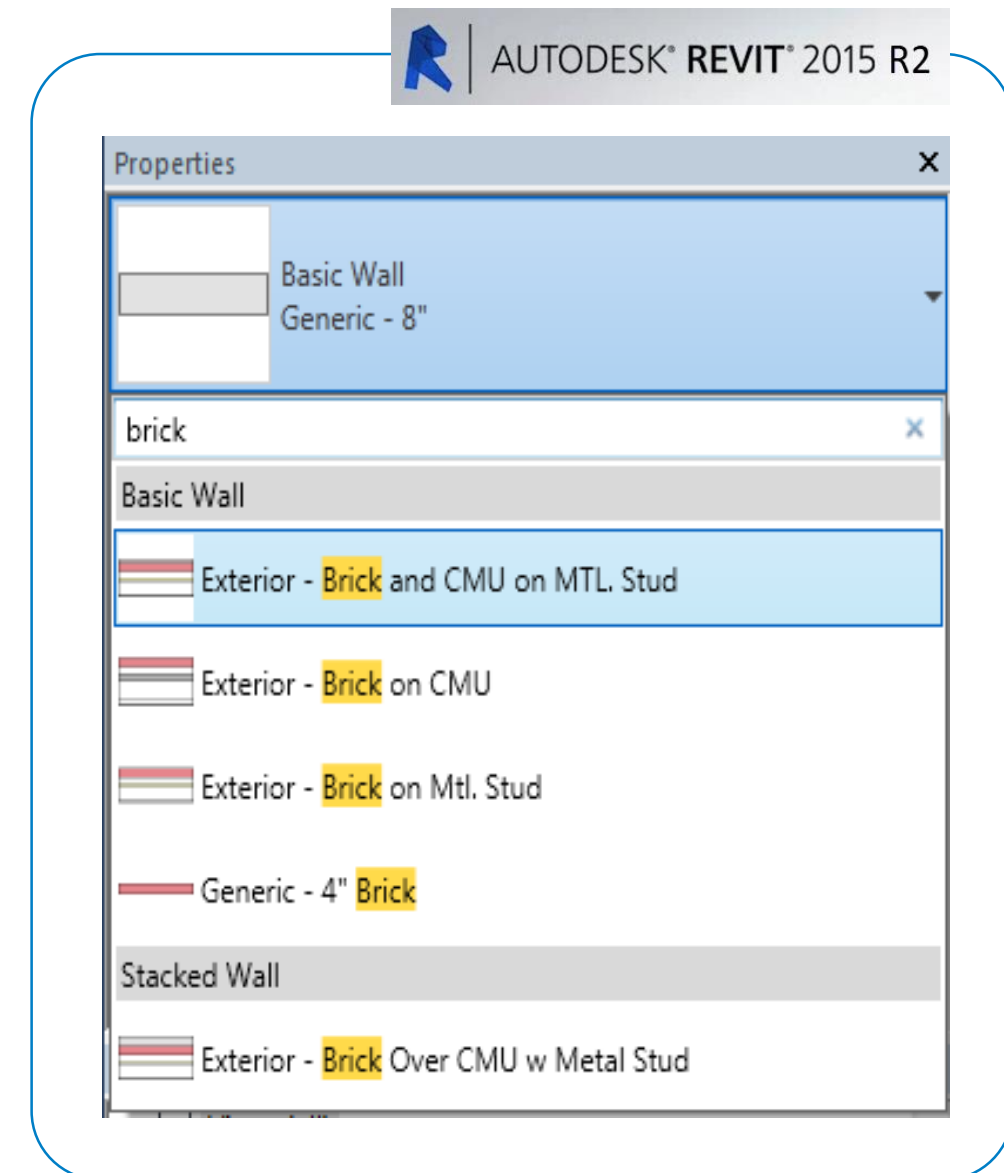

#4 Search Feature for Family Types Dialog

- Search for a parameter you want to modify in the **Family Types** dialog
- As you type, the list of parameters are filtered

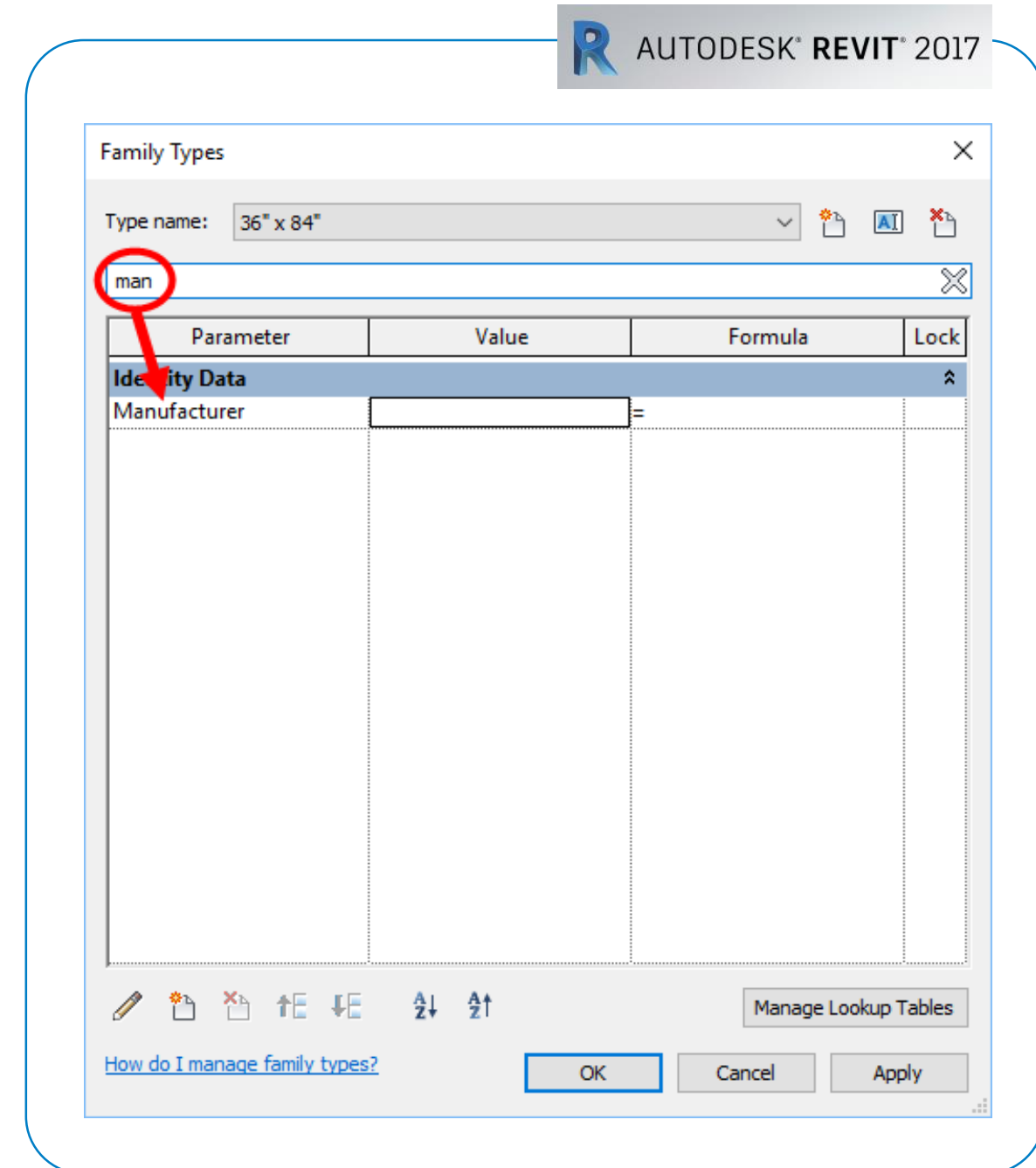

#5 Background Color

- Select any color background for the drawing area

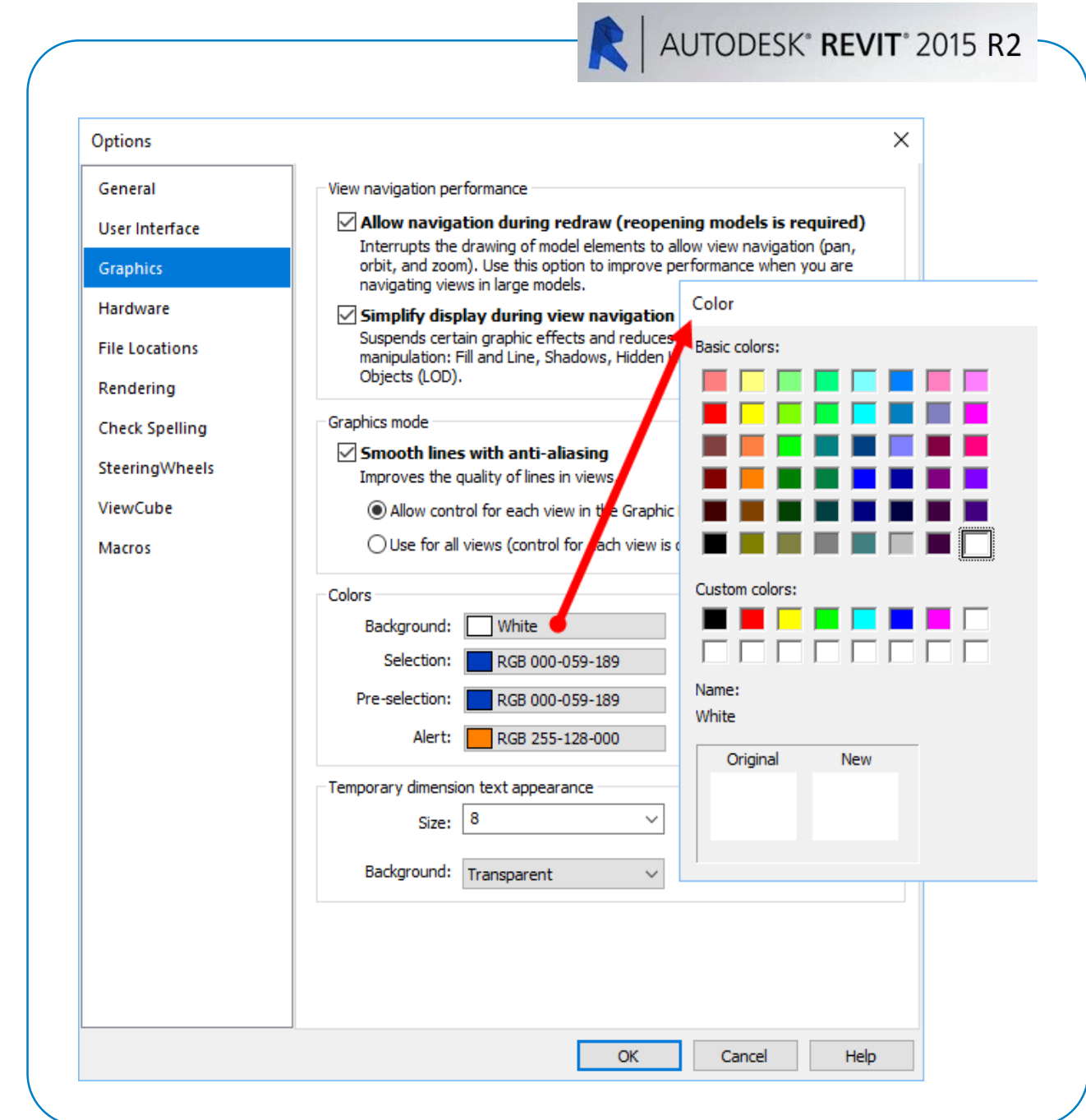

#6 Open Sheet Option for Views

- Right-click a view in the **Project Browser – Open Sheet** available to open the sheet the view is placed on

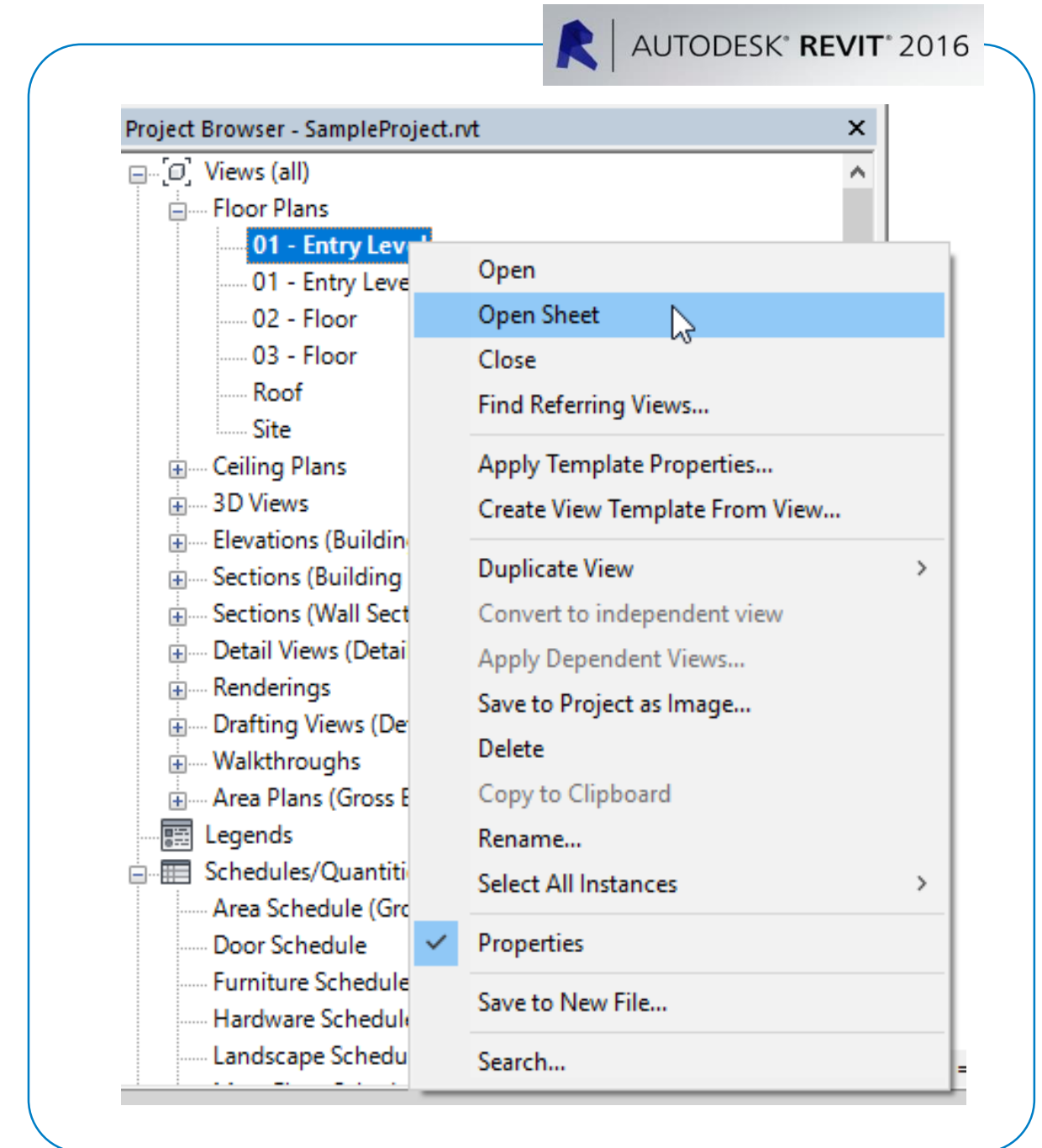

#7 Selection Boxes

- Quickly isolate selected elements in a 3D view

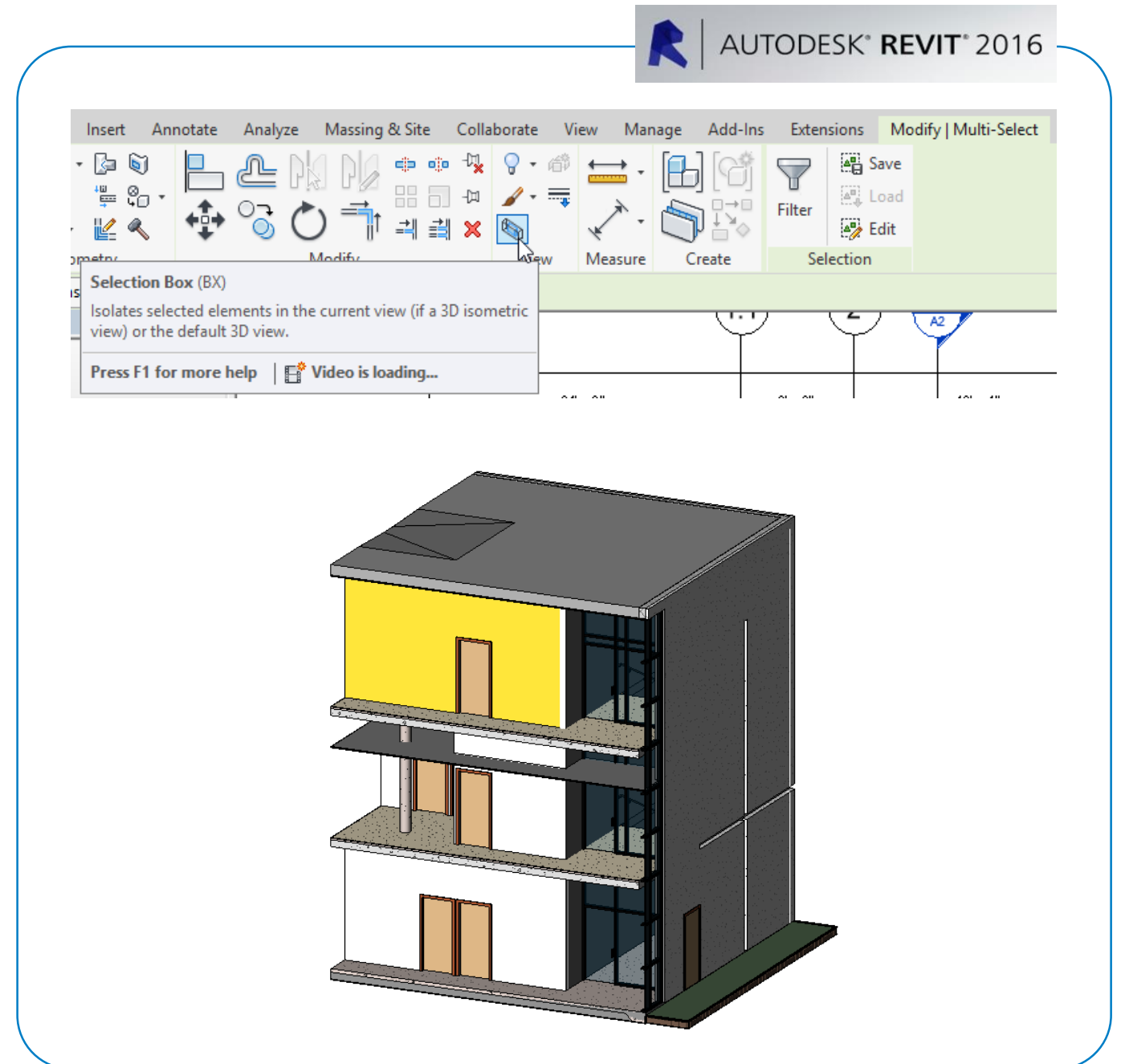

#8 Revision on Sheet Dialog

- Control which revisions appear in the revision schedule
- Add additional revisions to the revision schedule as needed

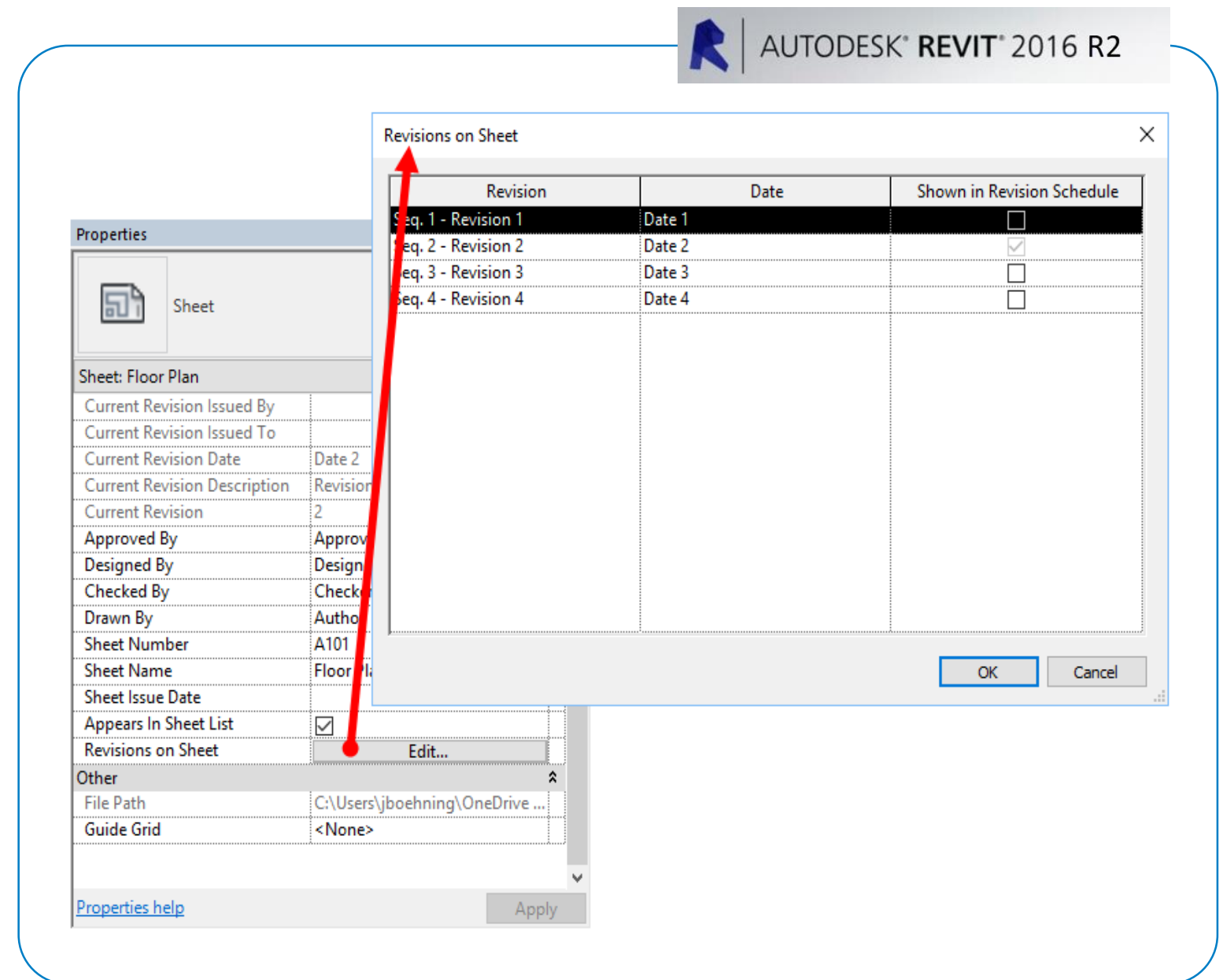

#9 Reposition Revit Links

- Once a Revit model is linked to another model, you can reposition the link
- Two reposition options are available:
 - **Reposition to Project Base Point**
 - **Reposition to Internal Origin**

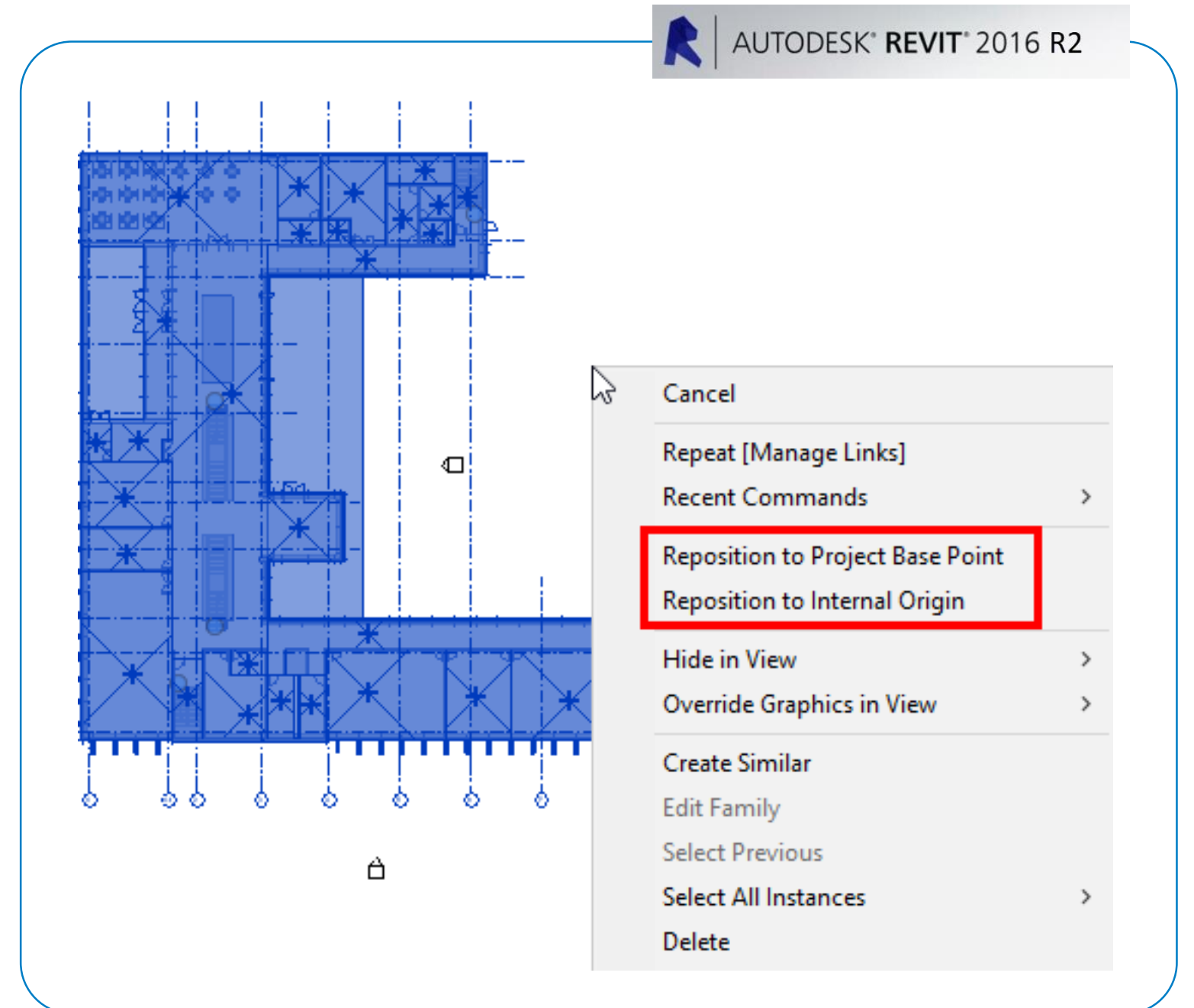

#10 Unloading Links in Workshared Projects

- Unload links for all users or just for a local copy

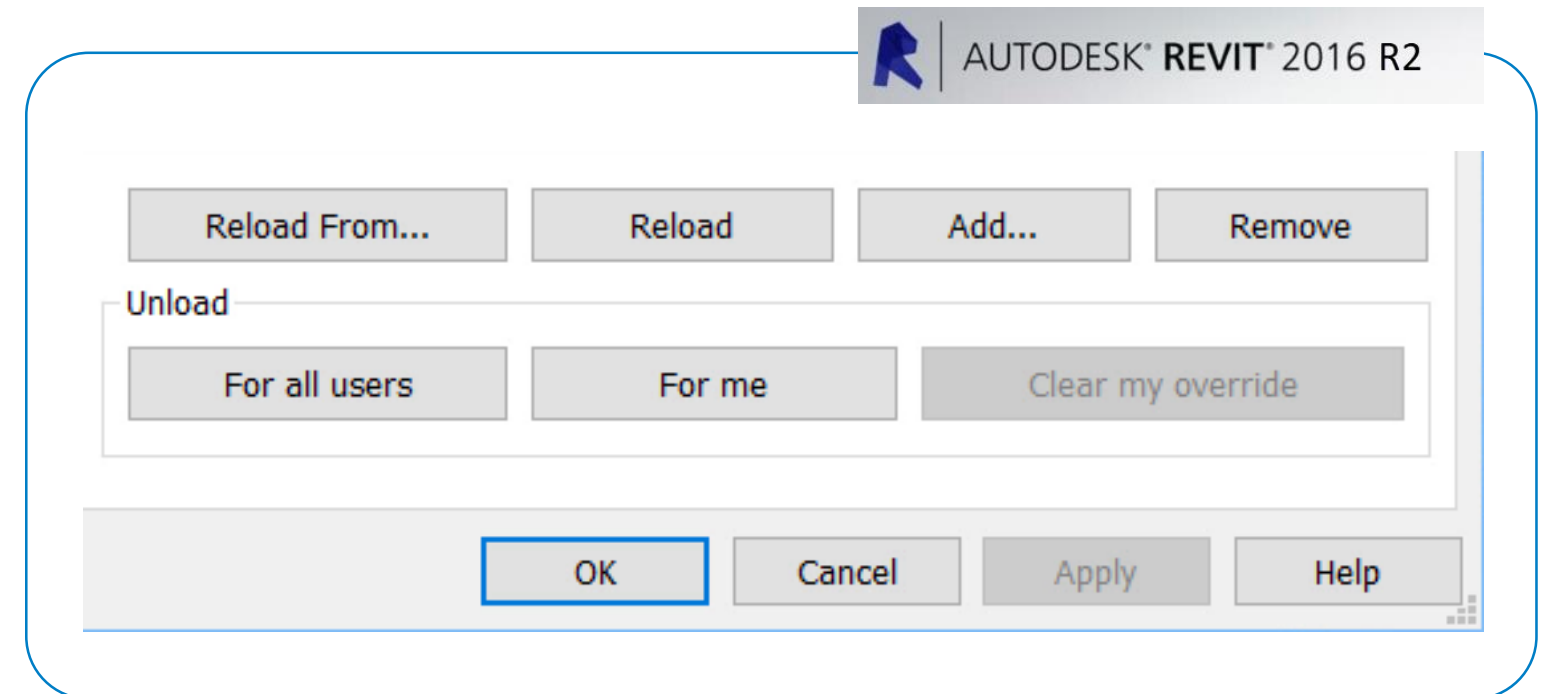

#11 Family Visibility Preview

- Preview how geometry will appear in the project environment

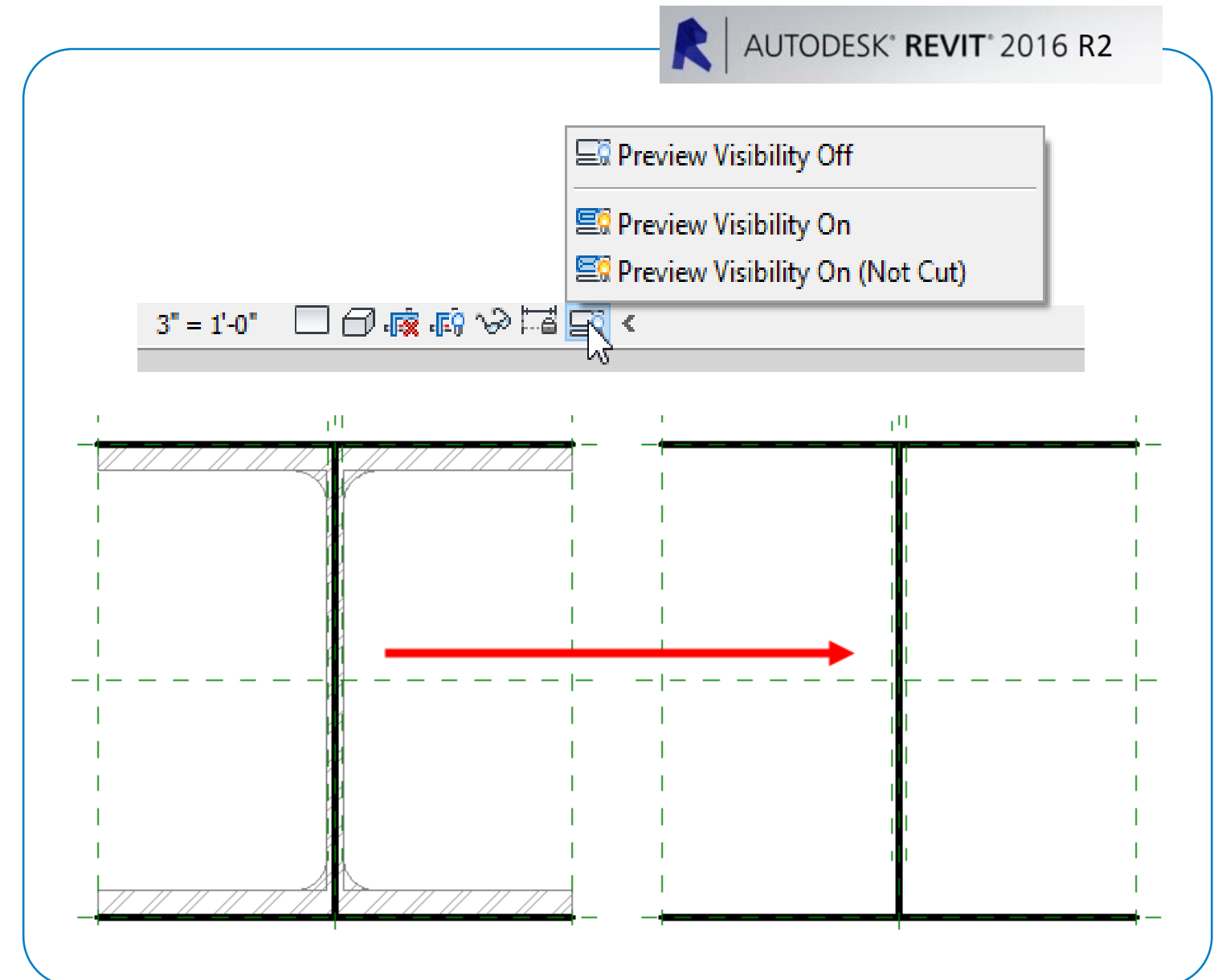

#12 Cancel Print/Export

- Cancel the entire operation when printing or exporting multiple views and sheets

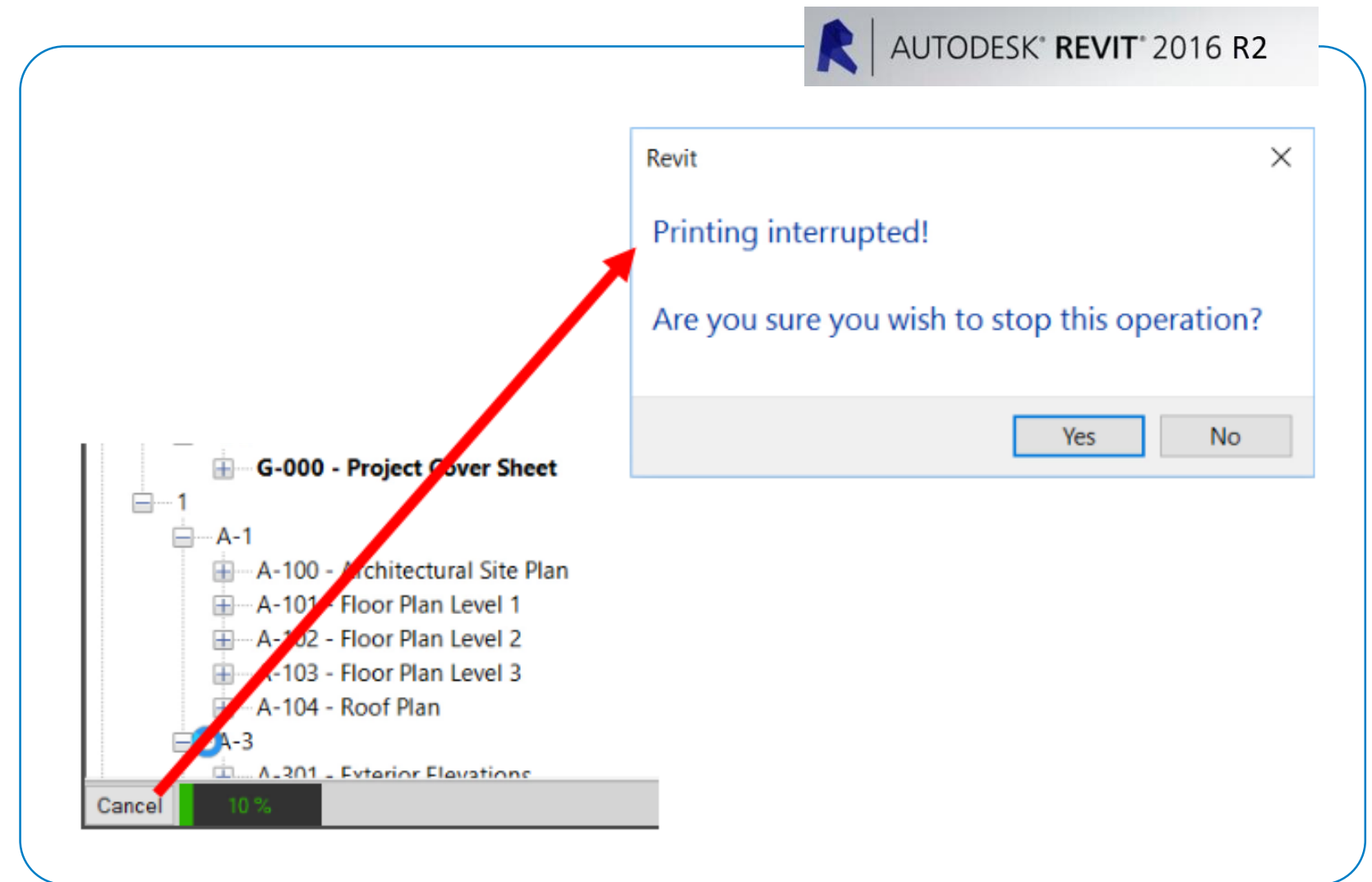

#13 Calculate Options for Schedule Columns

- Report minimum values, maximum values, or both for numerical fields

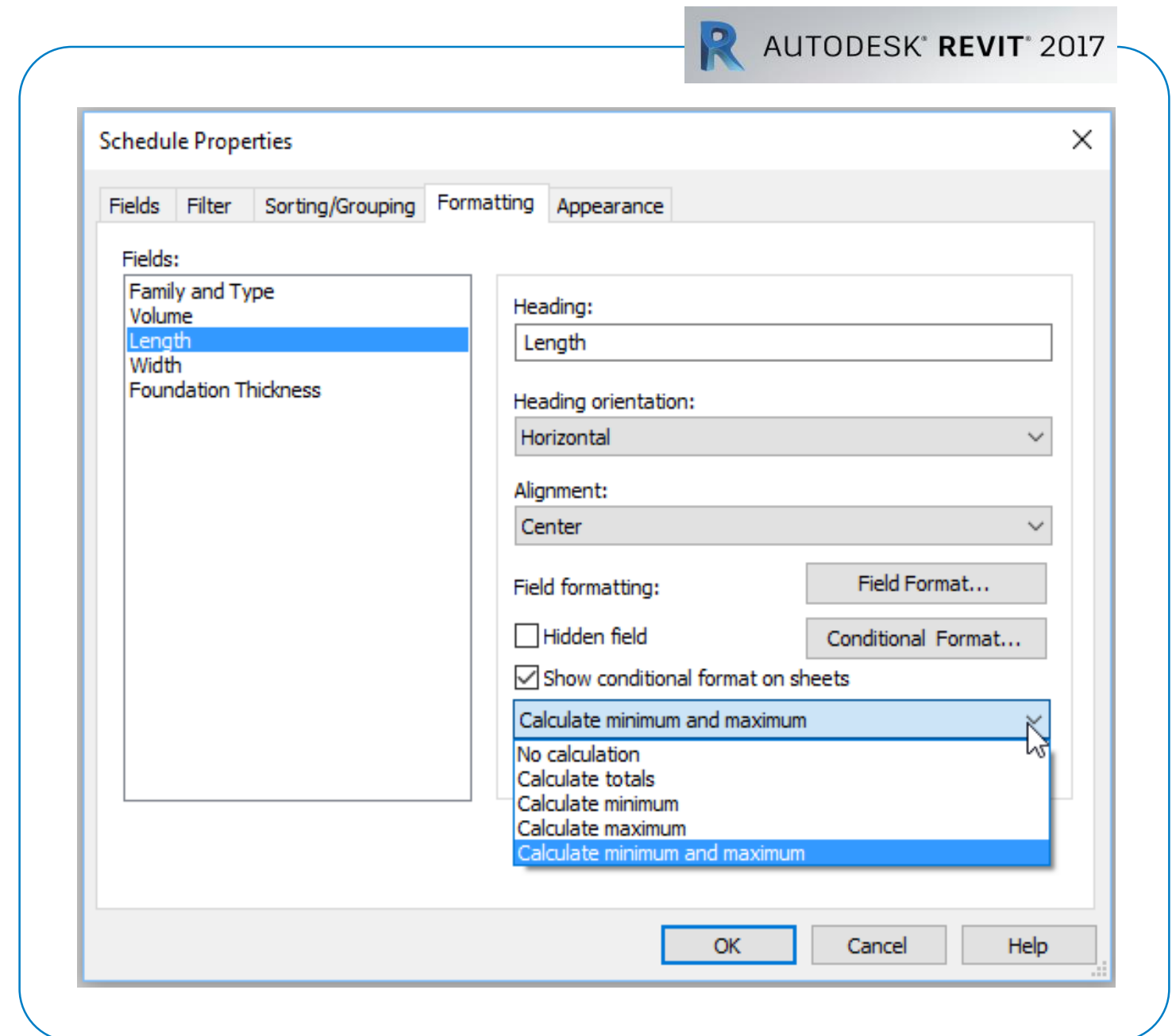

#14 Calculated Values in Tags

- Add formulas to tags
- Formulas are added in the tag family

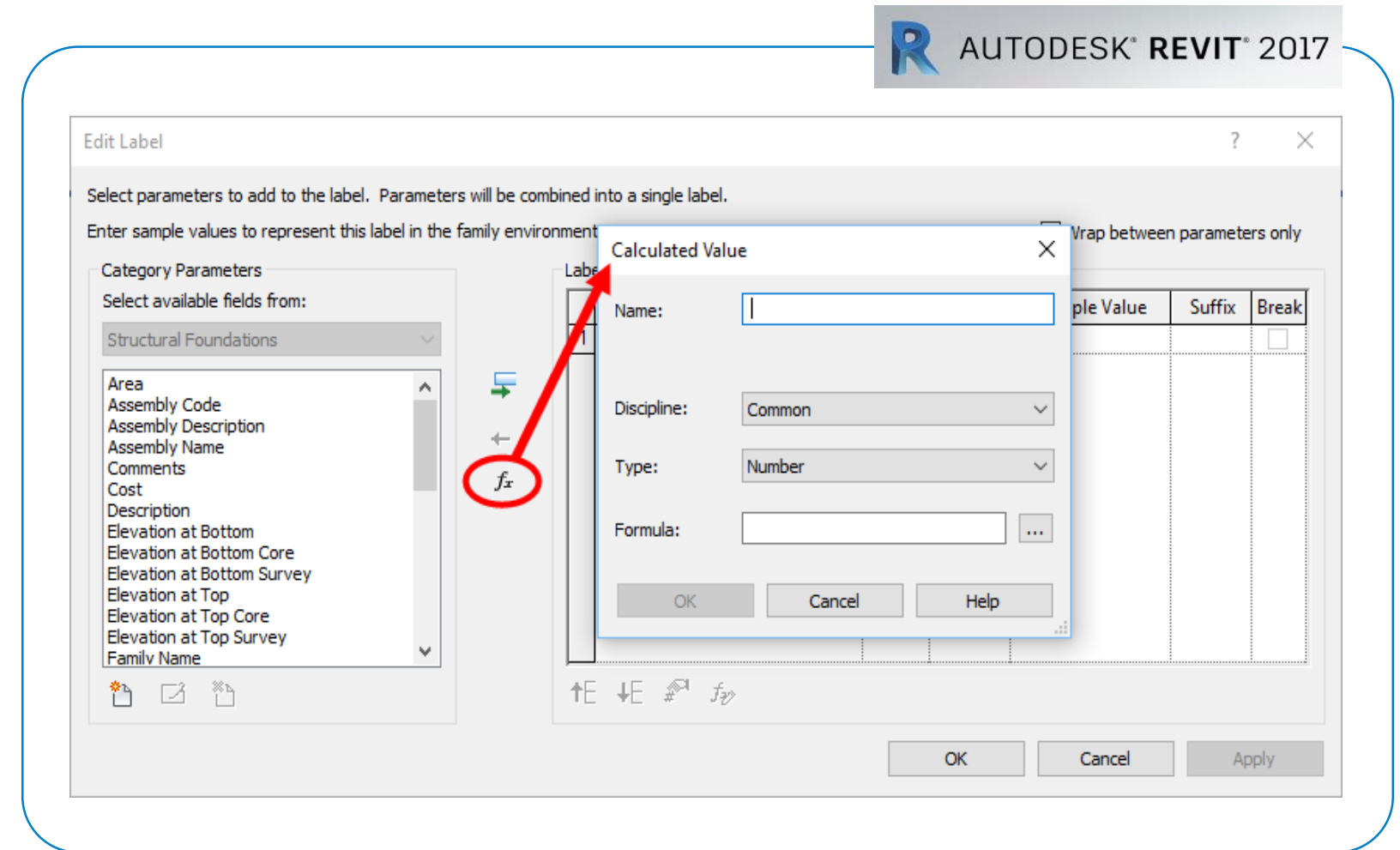

#15 Visibility of Point Clouds

- Control the **Visibility** and **Color Mode** of linked point cloud:
 - Scan Locations
 - Scan Regions

 AUTODESK® REVIT® 2017

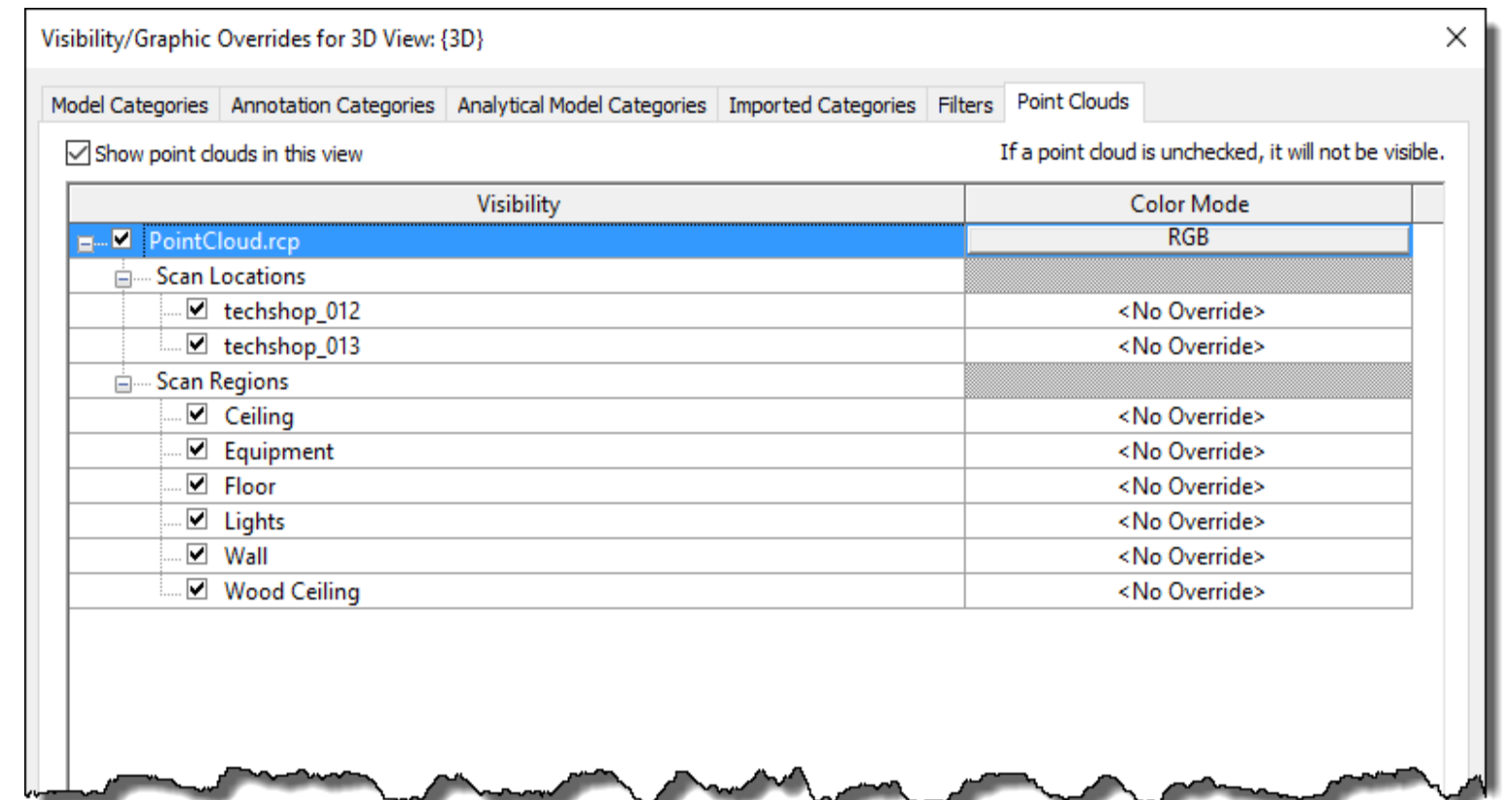

#16 Filtering Schedules with Global Parameters

- Filter a schedule based on global parameter association by selecting:
 - Is associated with
 - Is not associated with
- Helps identify instances that should or should not have an association

 AUTODESK® REVIT® 2017

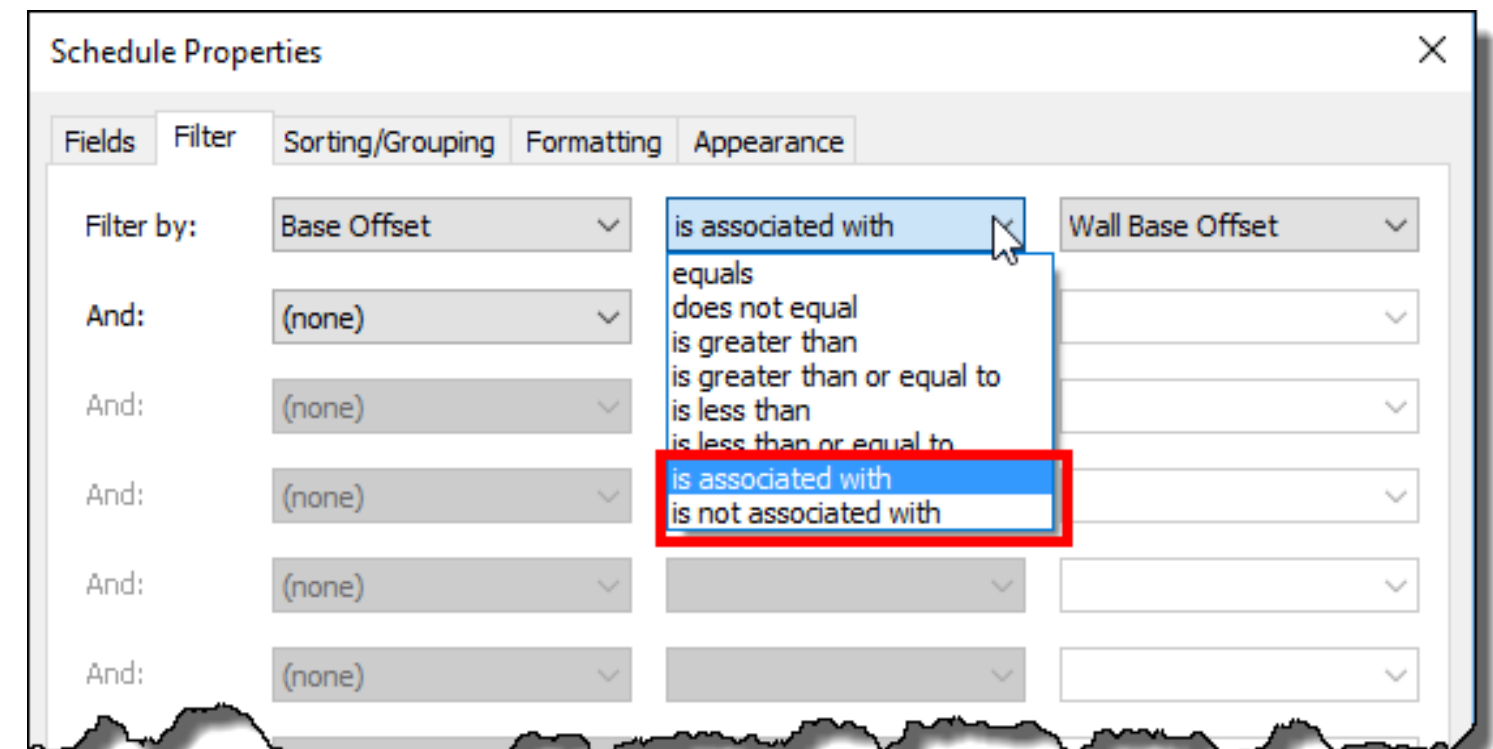

#16 Show Global Parameter Label for Dimensions

- Display global parameter label in dimensions

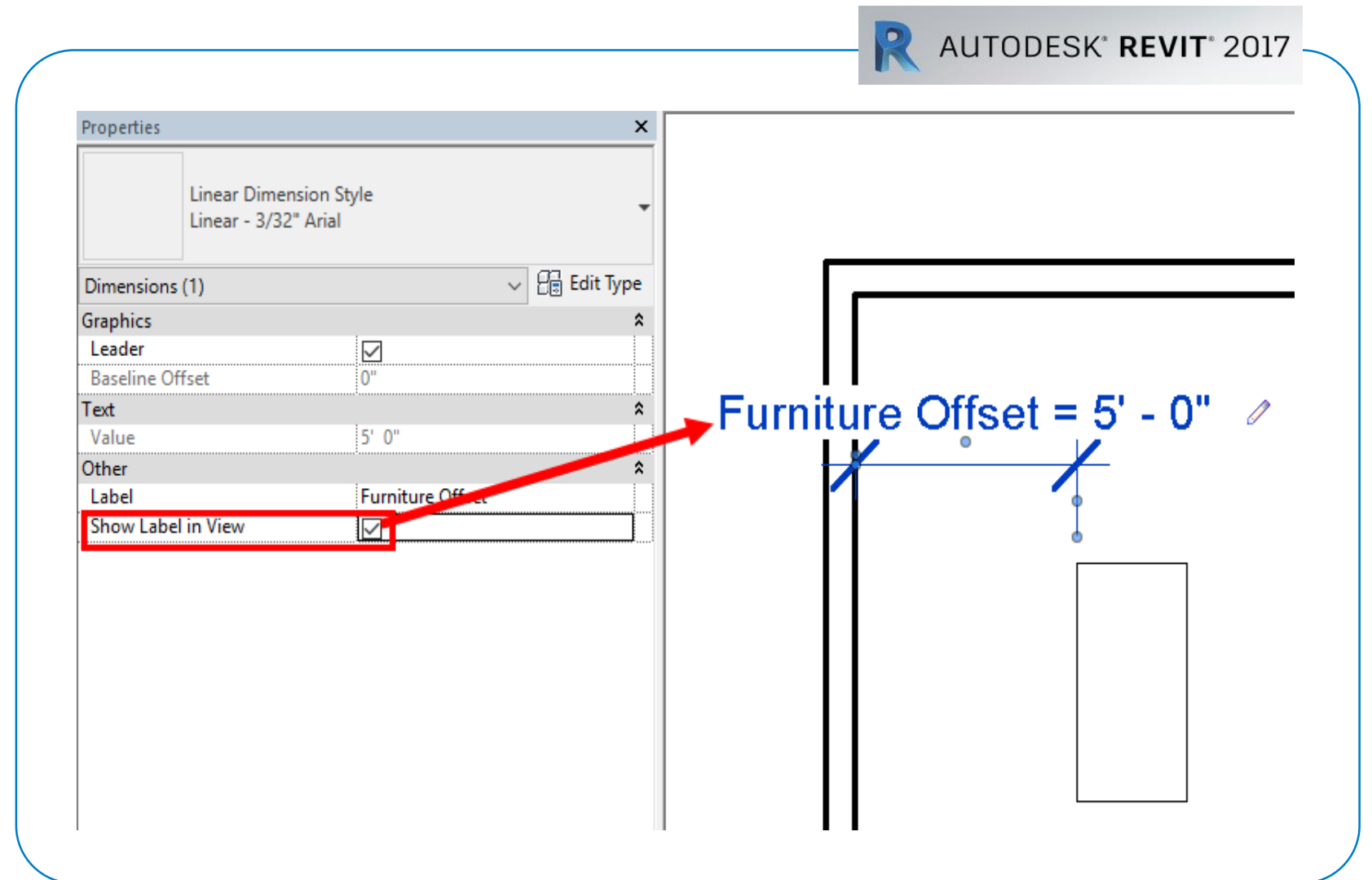

#17 Insight Integration for Energy Analysis

- Insight allows you to quickly see which factors affect the EUI

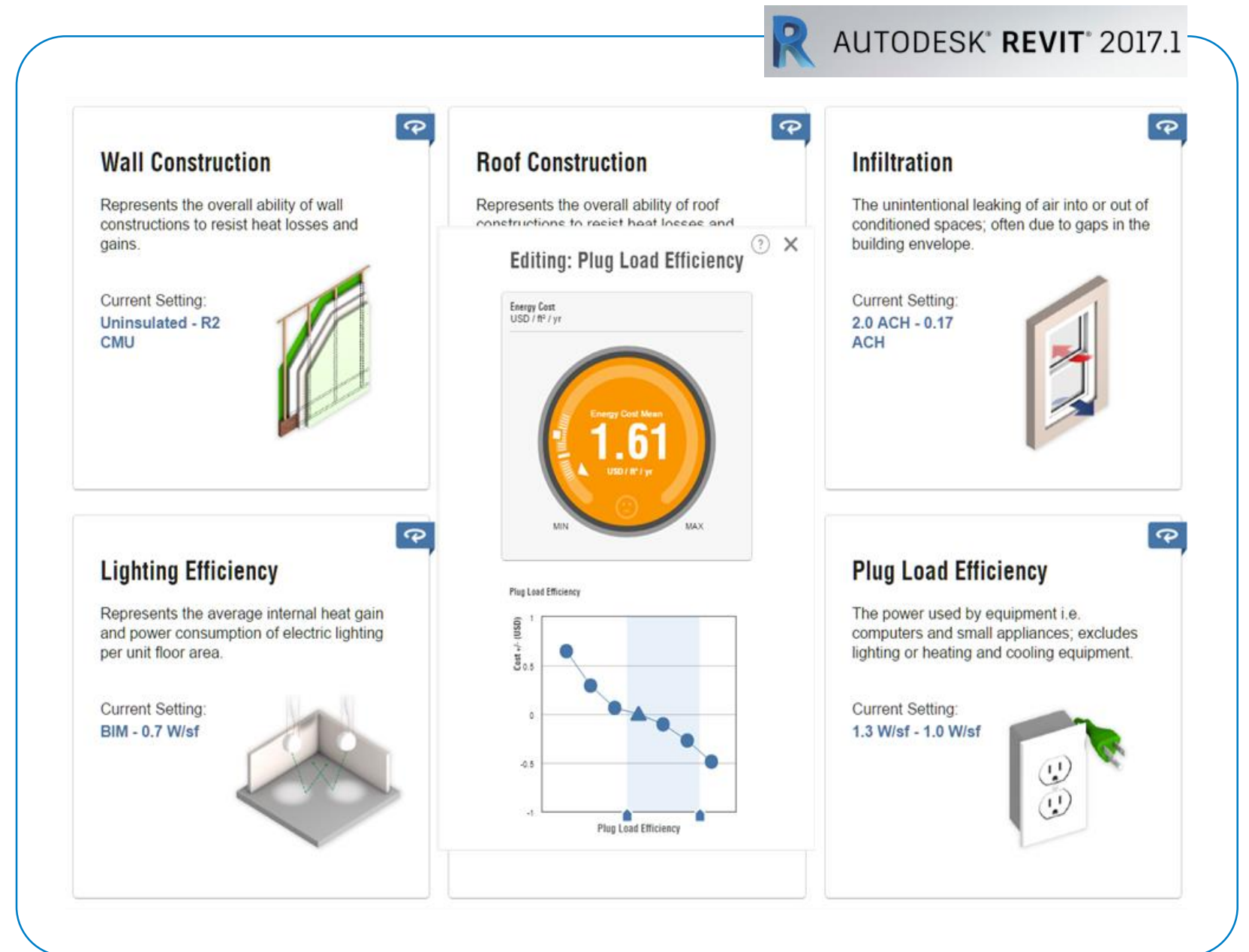

#18 Import 3D Shapes

- Rhino files can be imported
- Assign a category to the imported geometry
- Imported geometry will be positioned origin to origin

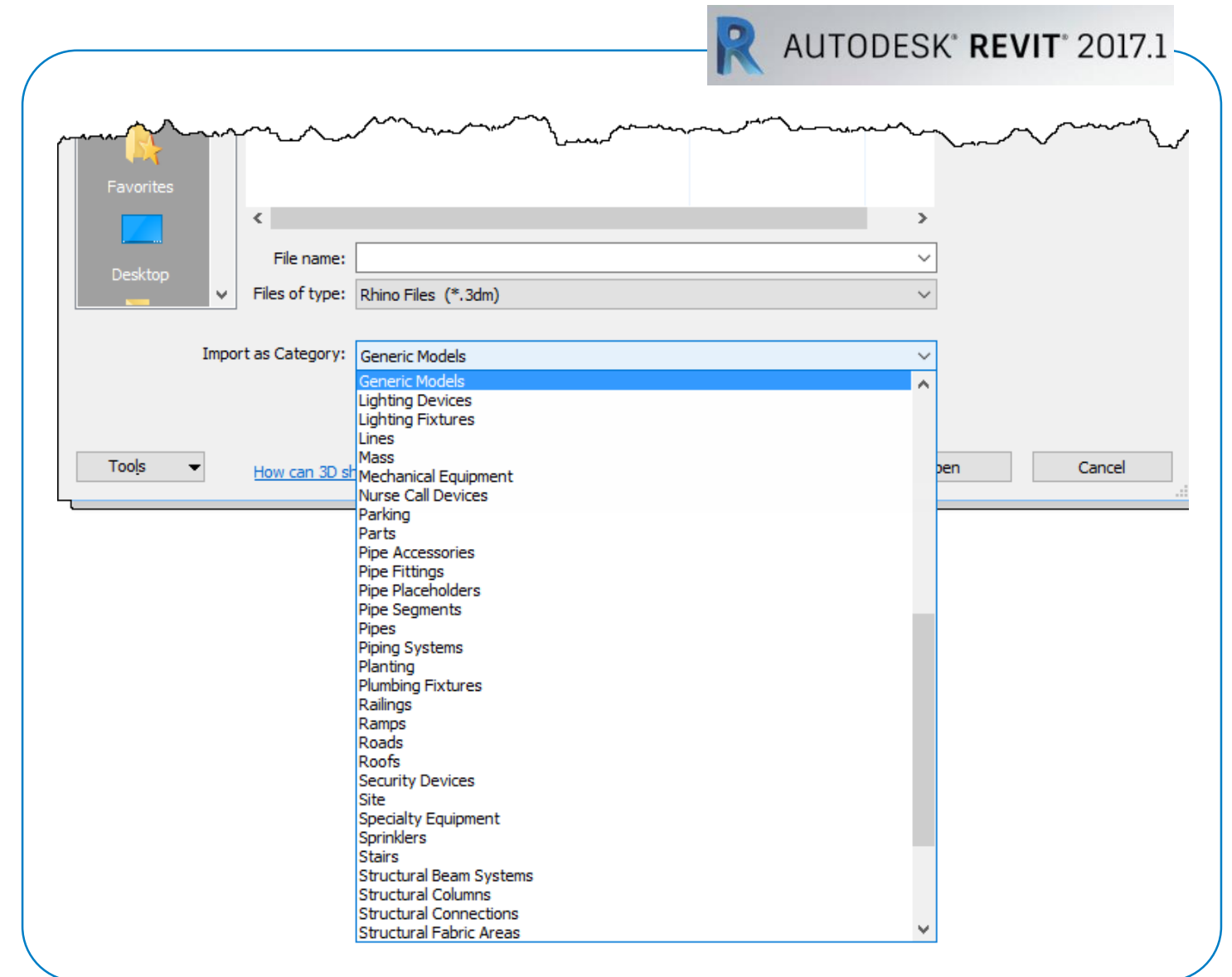

#19 Export Hatch Patterns

- Specify a solid background for the hatch patterns being exported

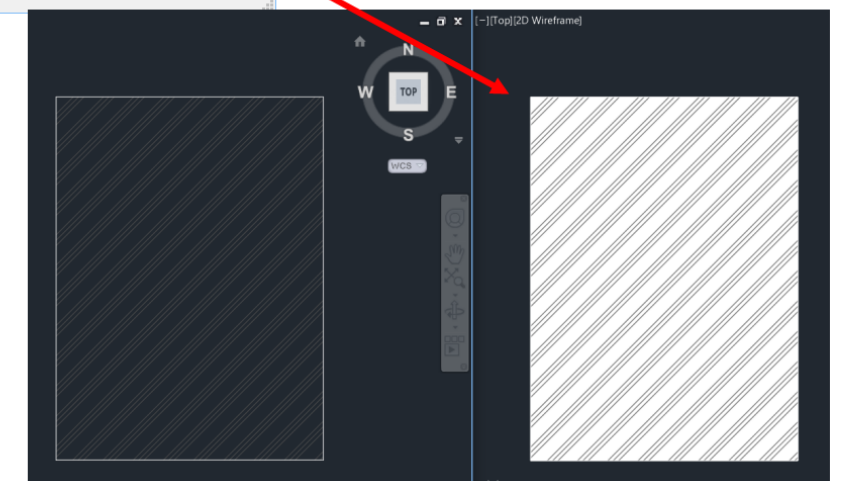
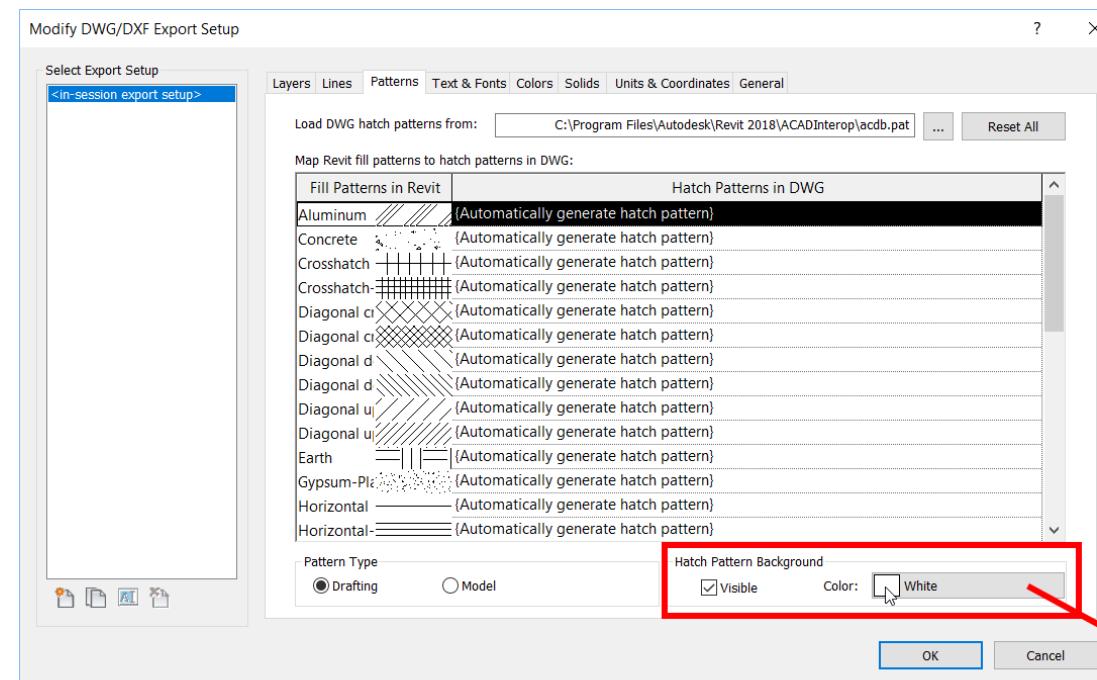

#19 Export Material Colors

- RGB values of assigned material colors can be specified

 AUTODESK® REVIT® 2017.2

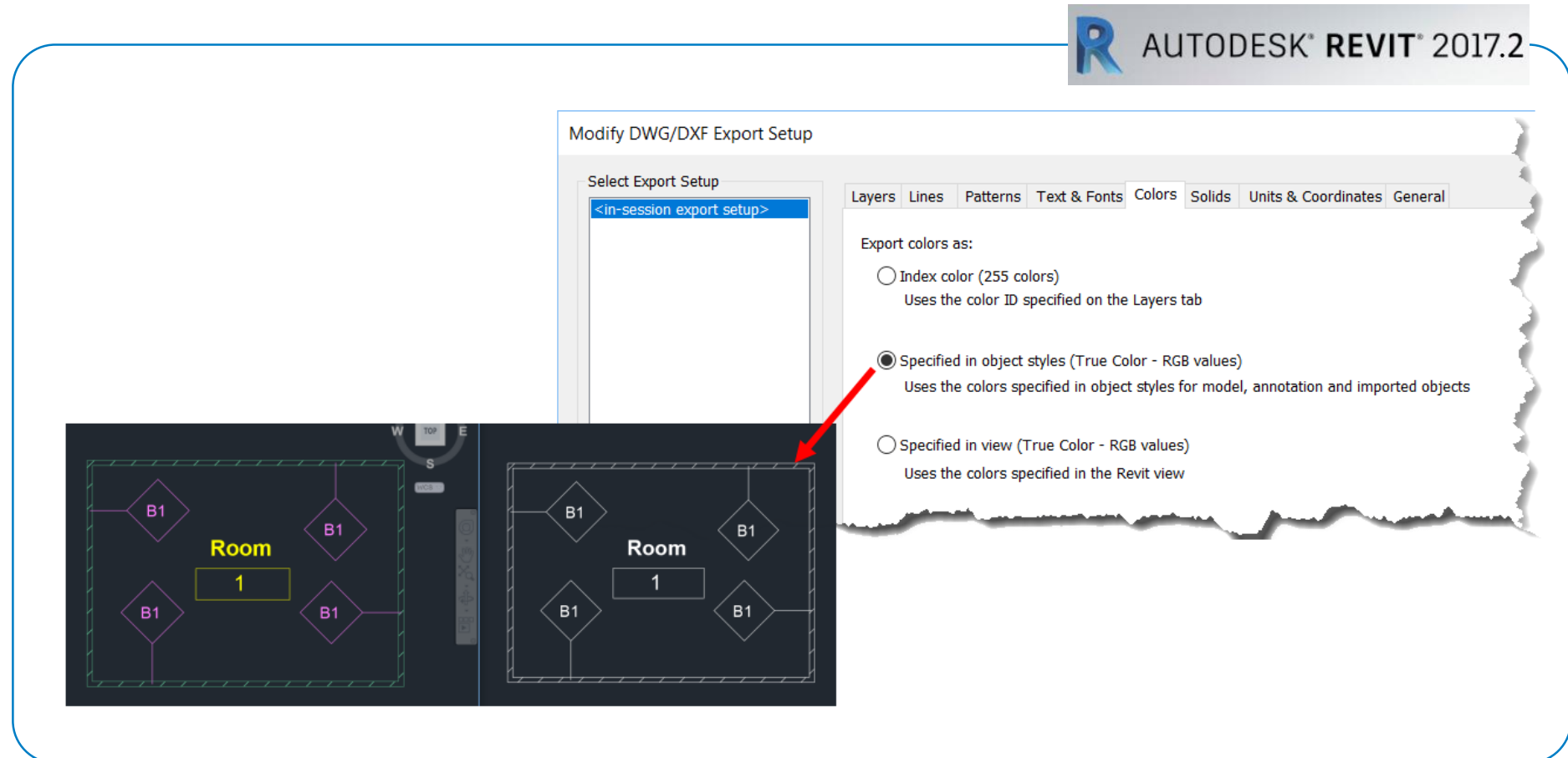

#20 Schedule Model Groups/RVT Links

- Model groups and Revit links can be scheduled
- Create detailed lists for all groups and links within a project.

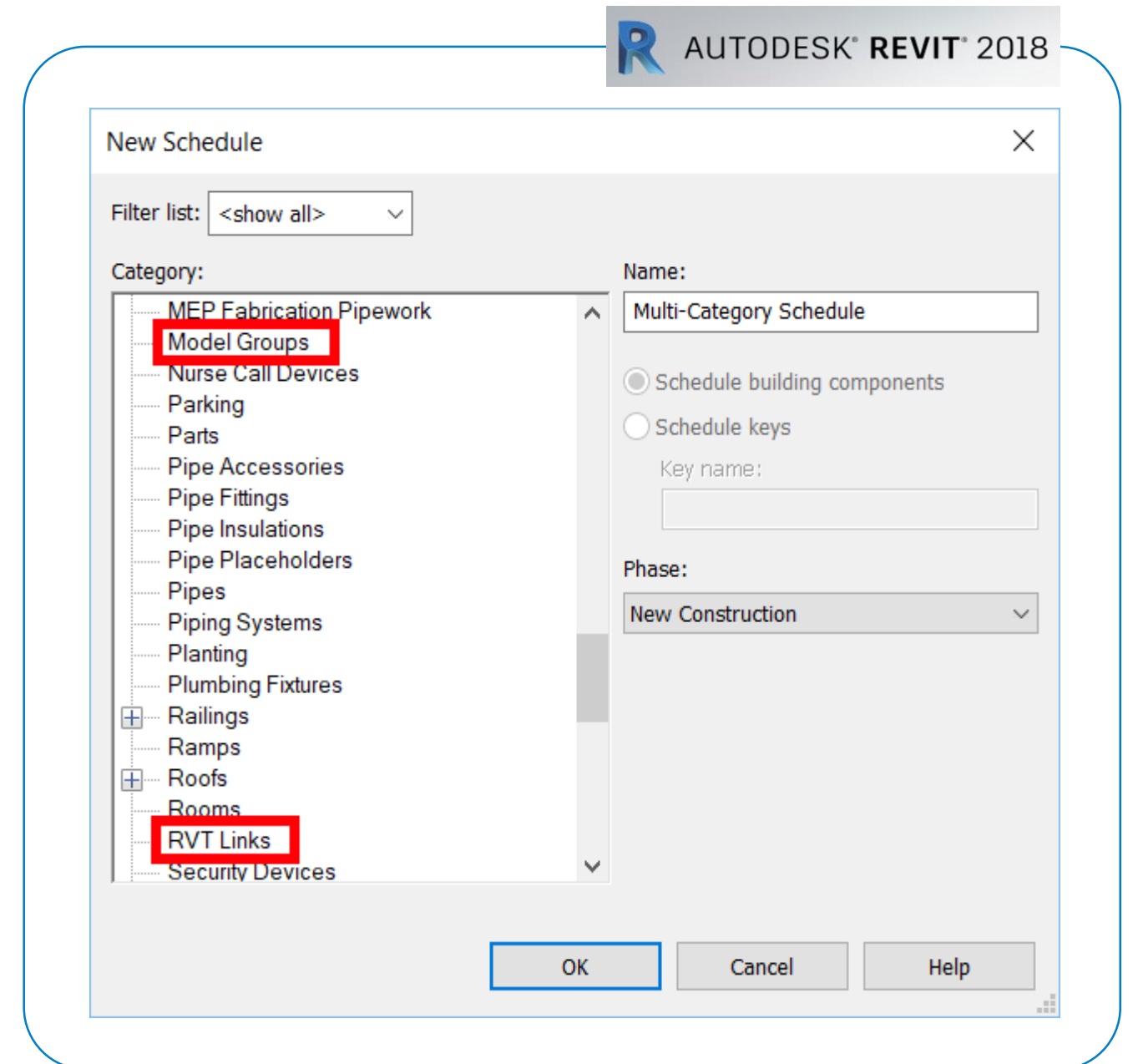

#20 Add Parameters to Model Groups/RVT Links

- Add custom parameters to Model Groups and Revit Links

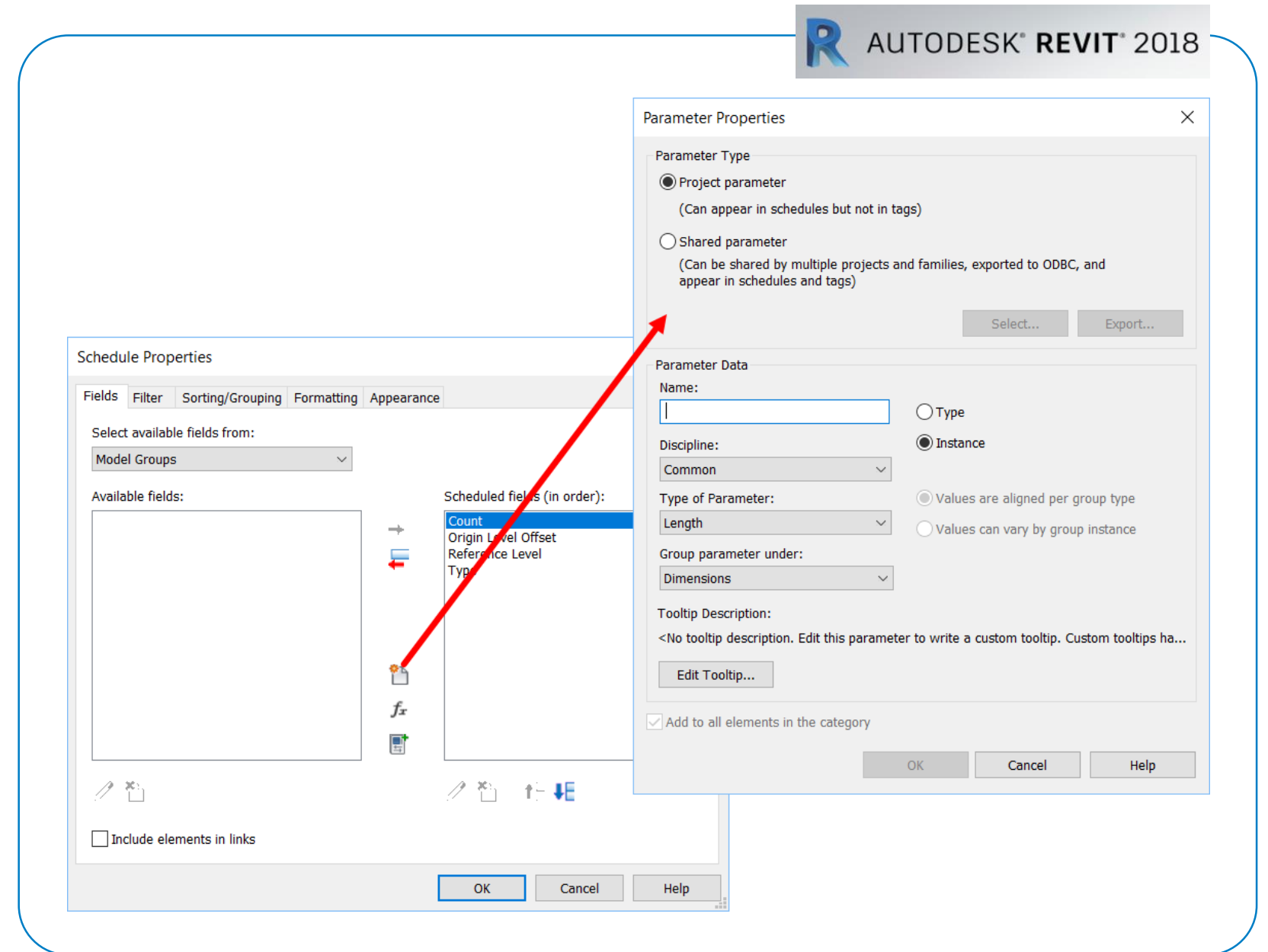

#21 User Definable Building/Space Types

- Create custom building types and space types

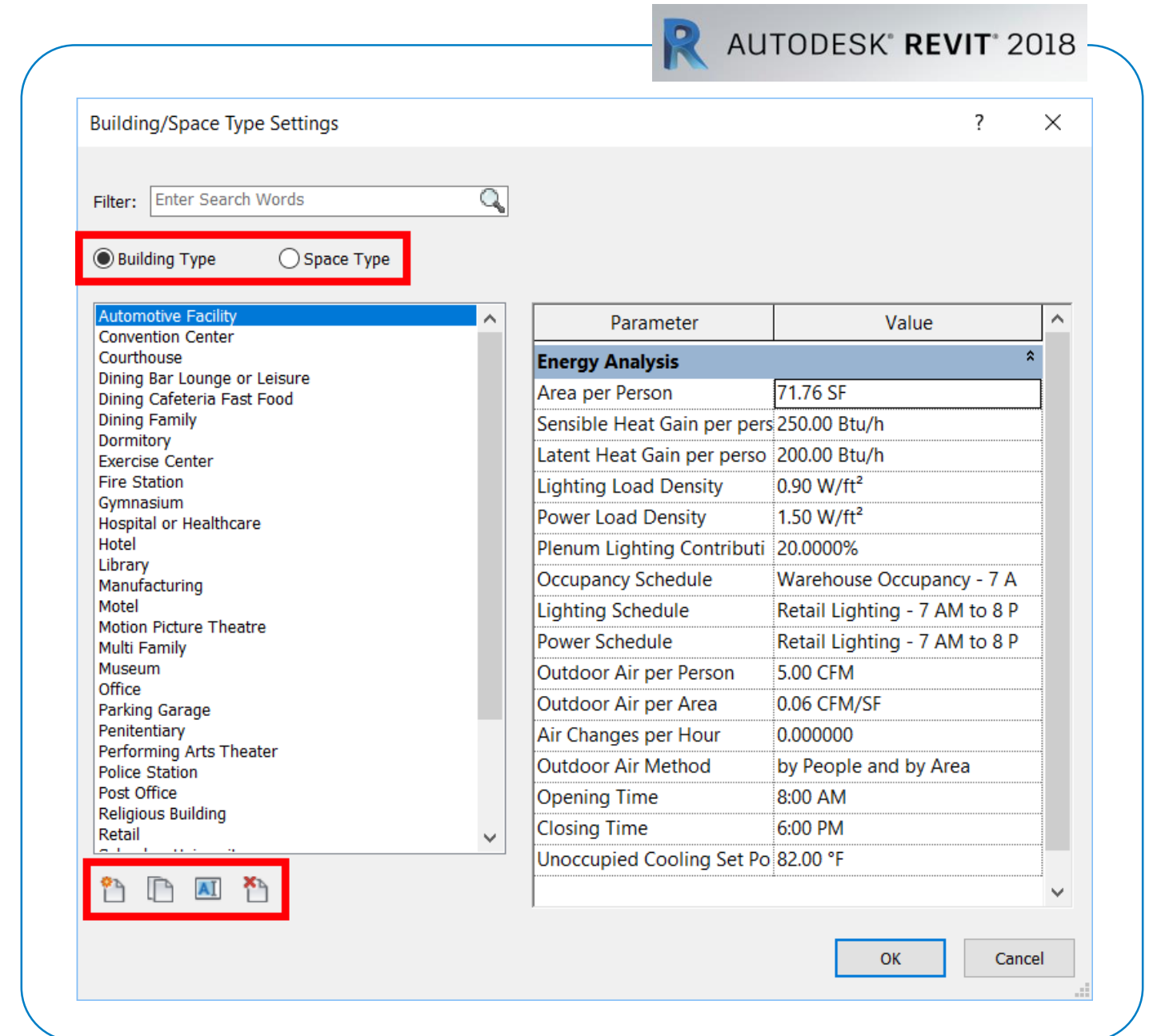

#22 Link Coordination Models

- Link Navisworks models into Revit
- Manage linked coordination models within the **Coordination Model** dialog

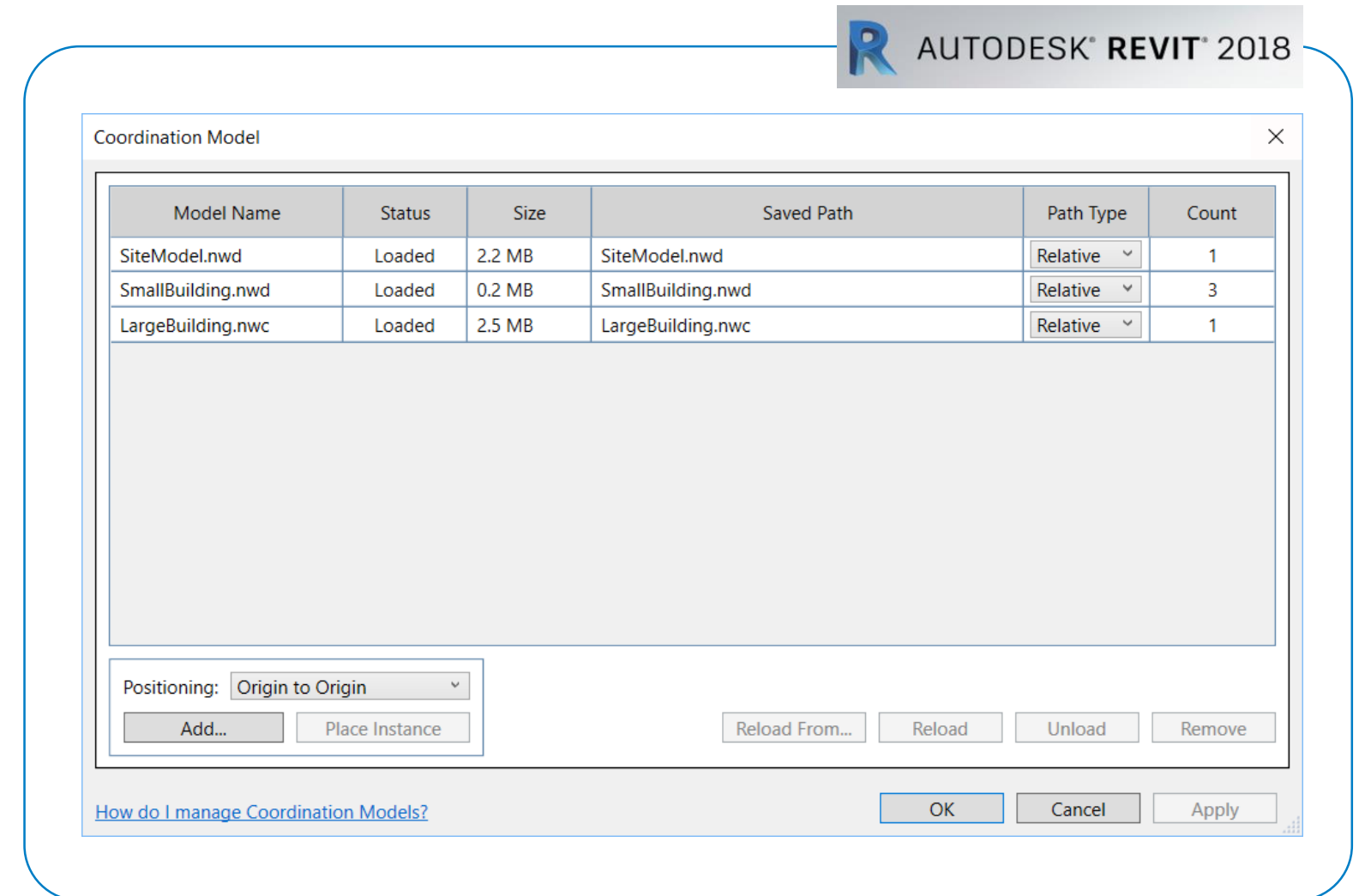

#23 Symbols in Text Notes

- Add symbols to text notes by using a shortcut menu
- Click **Other...** to open the **Character Map**

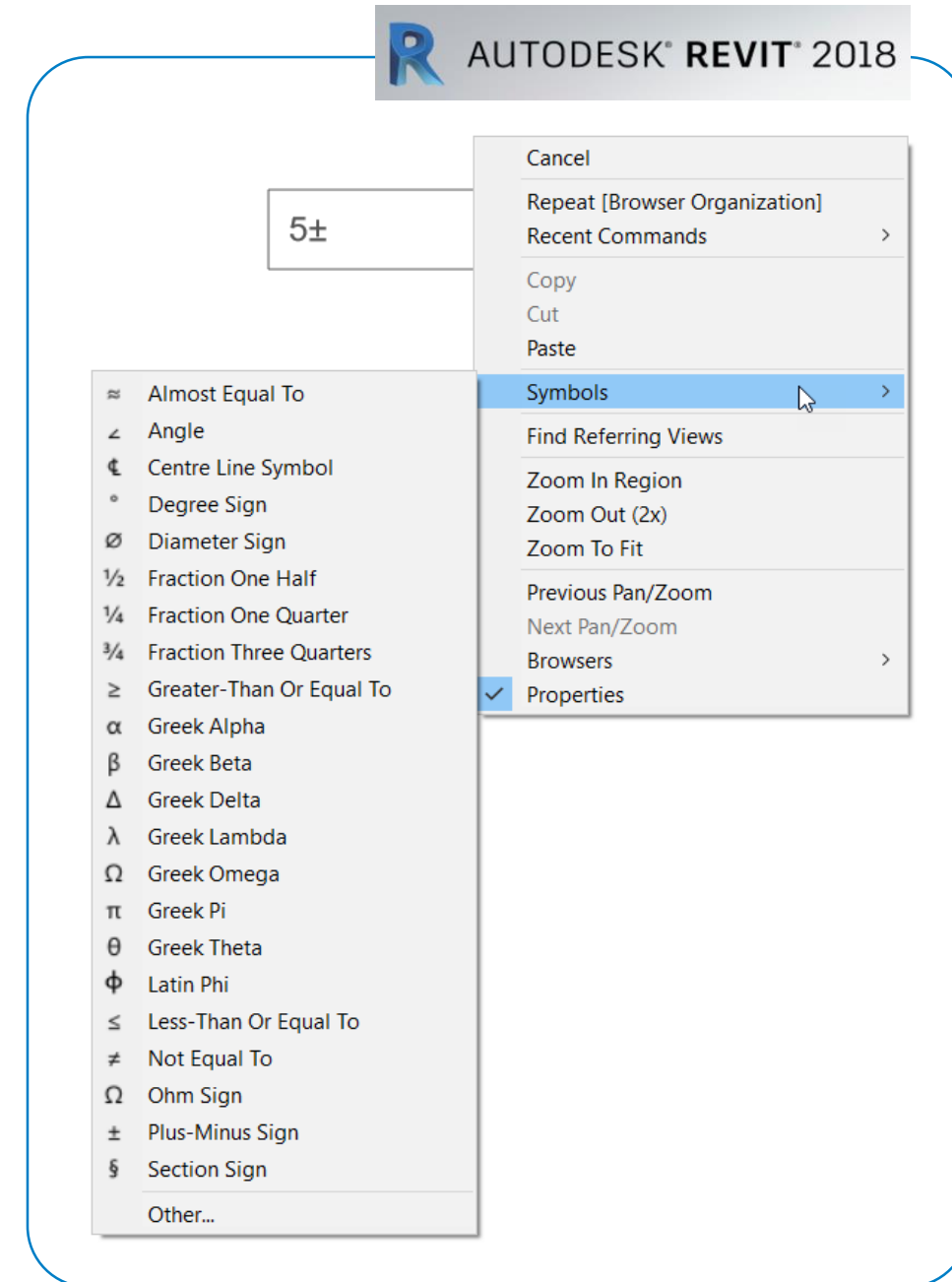

#24 Browser Organization for Schedules

- Filter, group, and sort schedules in the **Project Browser**
- Allows for better organization within the **Project Browser**

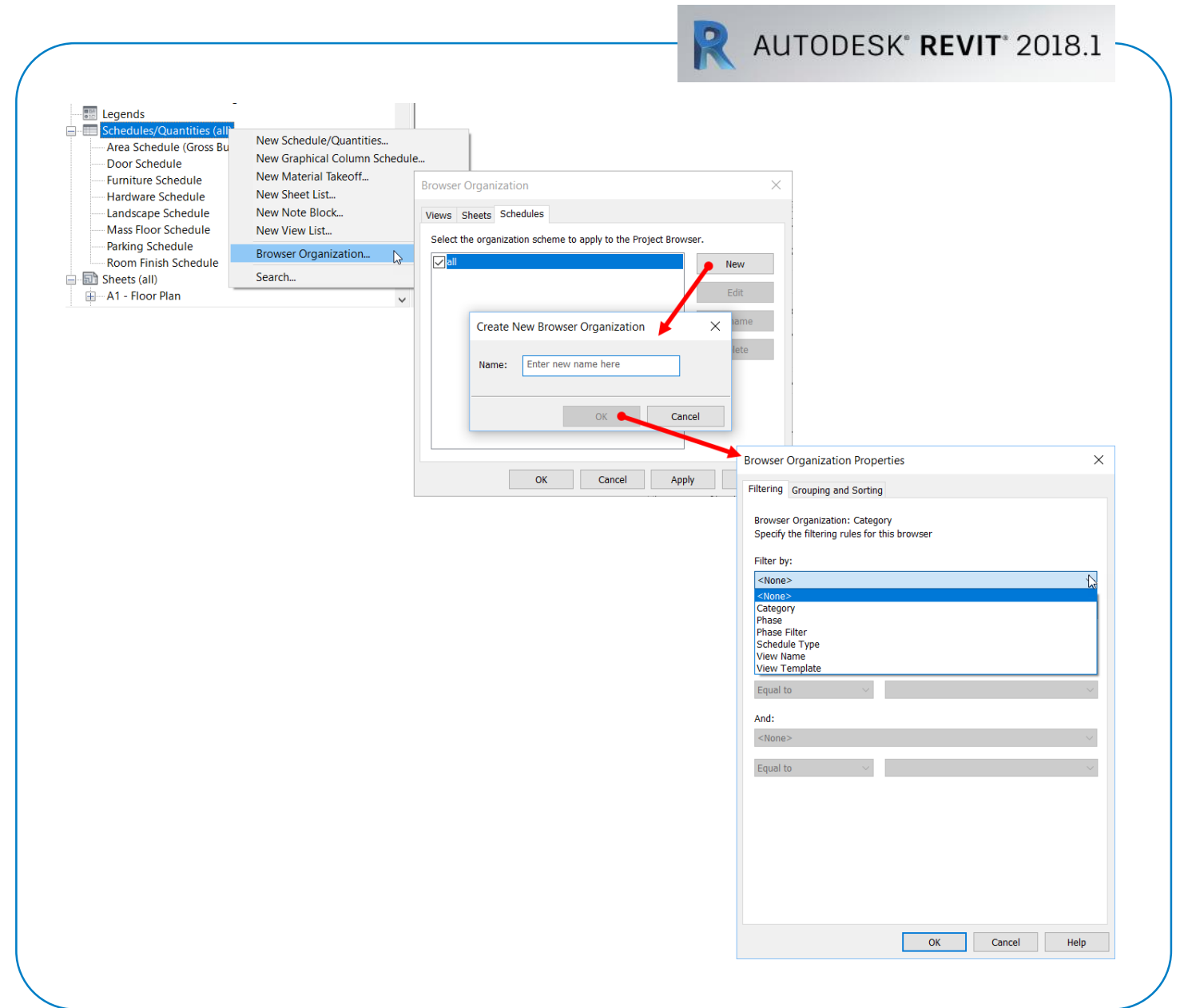

#25 Dynamo Player Inputs for Scripts

- Change input values directly in Dynamo Player

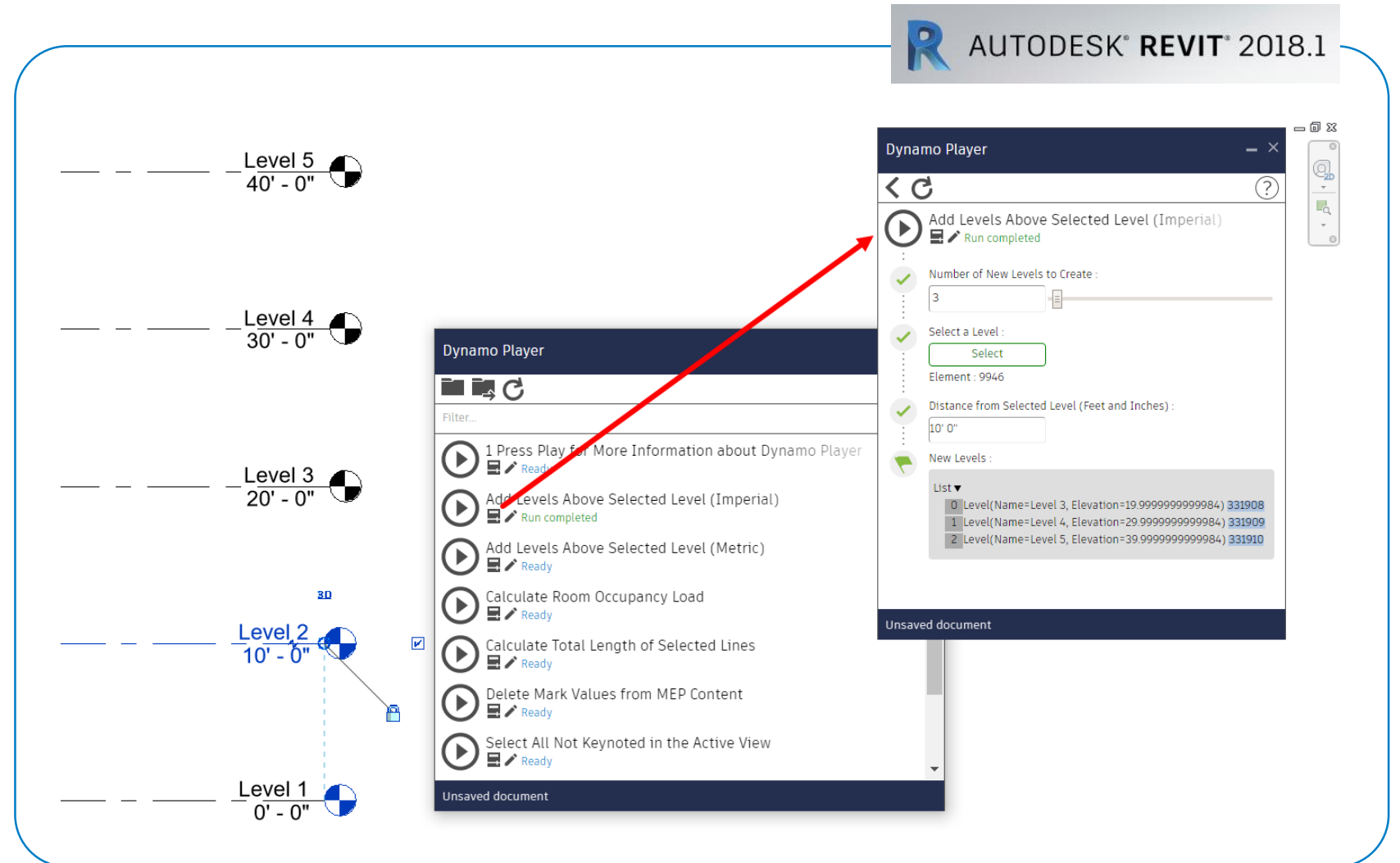

#26 Updated Graphics and Hardware Options

- A **Hardware** tab has been added to the **Options** dialog
 - Check for information about the graphics card
- The **Graphics** tab has a new area called **View Navigation Performance**
 - Contains an option to **Simplify display during view navigation**

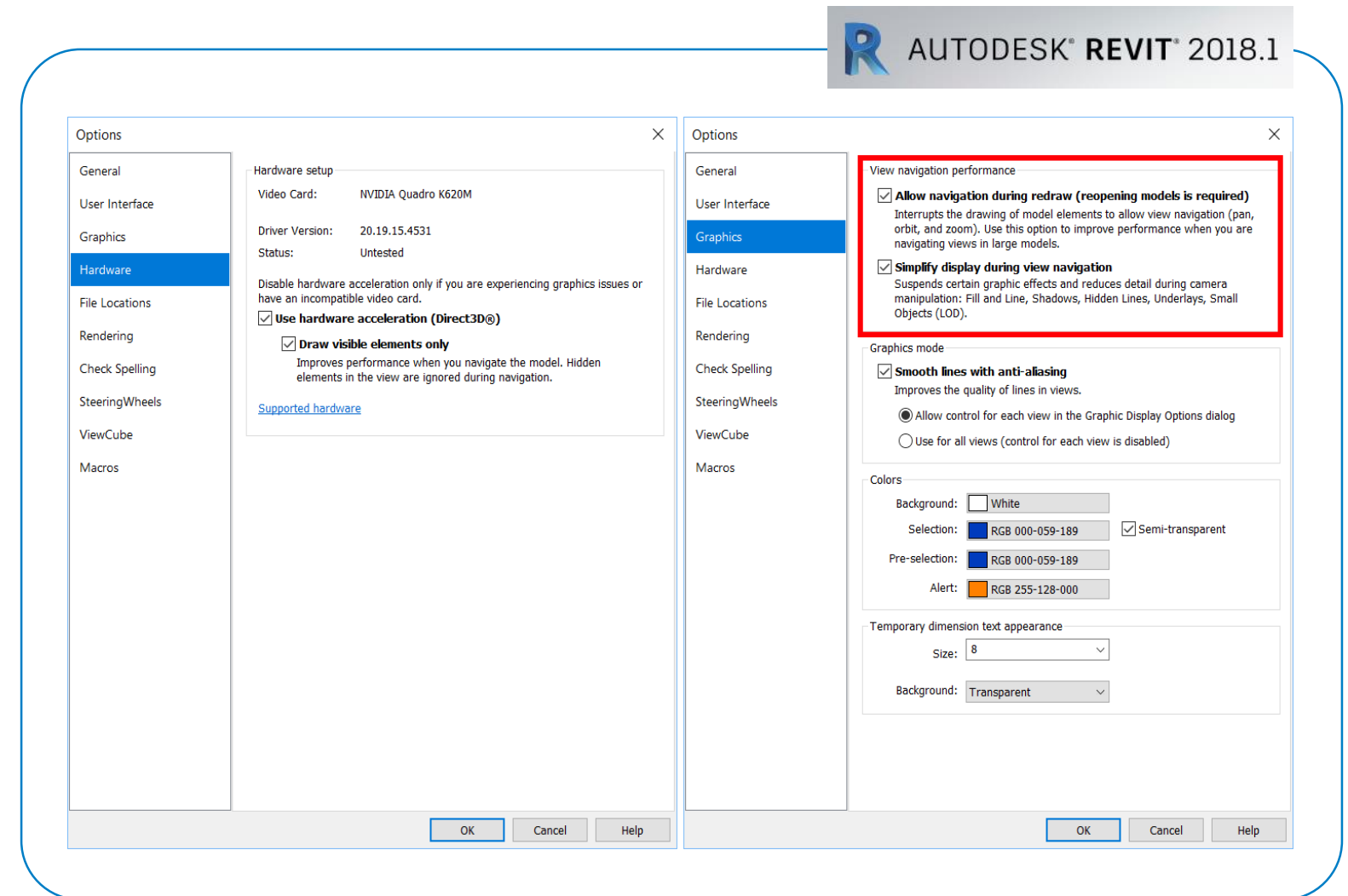

#27 Expand and Collapse the Project Browser

- Additional options are available when you right-click in the **Project Browser**:
 - **Expand Selected**
 - **Expand All**
 - **Collapse Selected**
 - **Collapse All**

 AUTODESK® REVIT® 2018.2

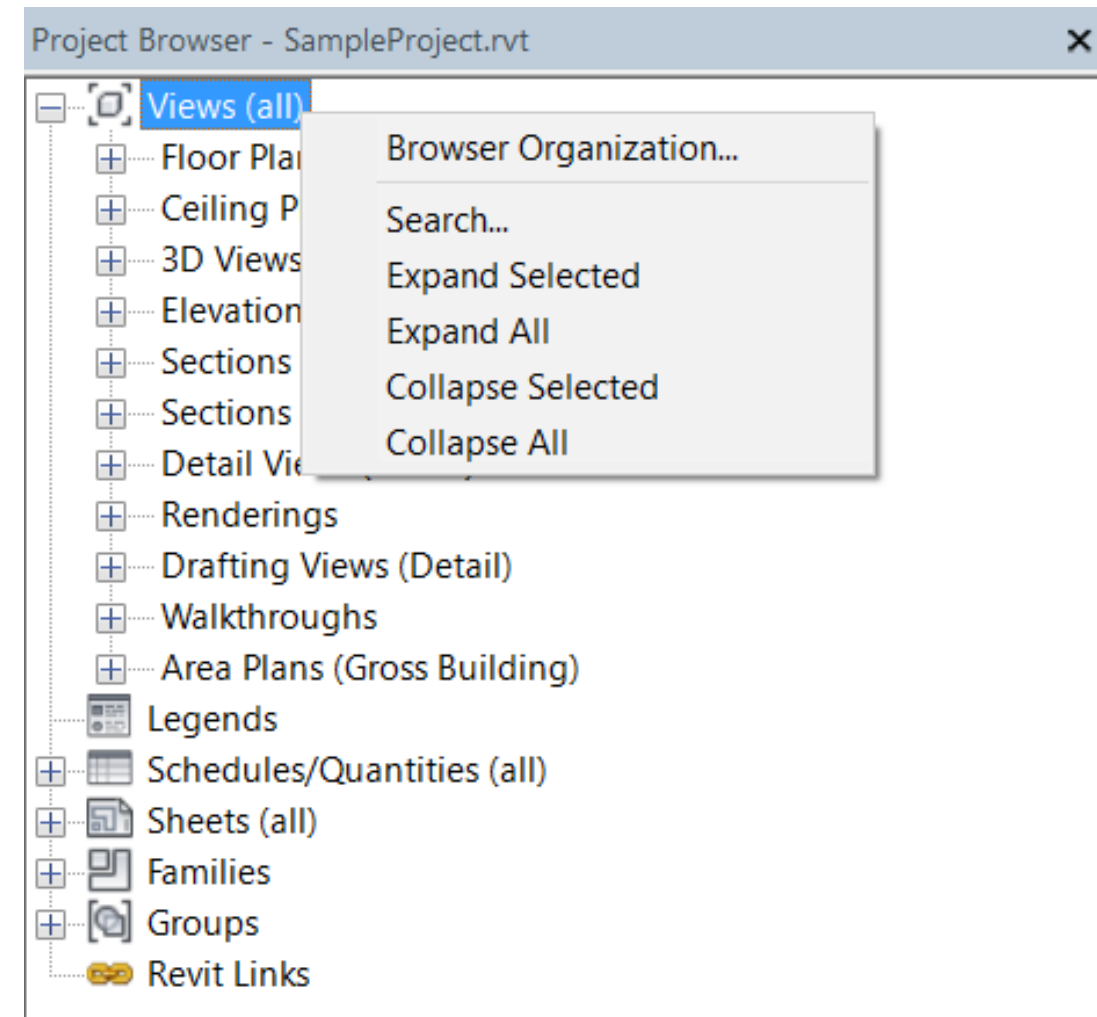

#28 Updates to the Fill Patterns Dialog

- **Solid Fill** pattern relocated
- Select and delete multiple patterns
- Search for a fill pattern
- Rescale custom fill patterns

 AUTODESK® REVIT® 2018.2

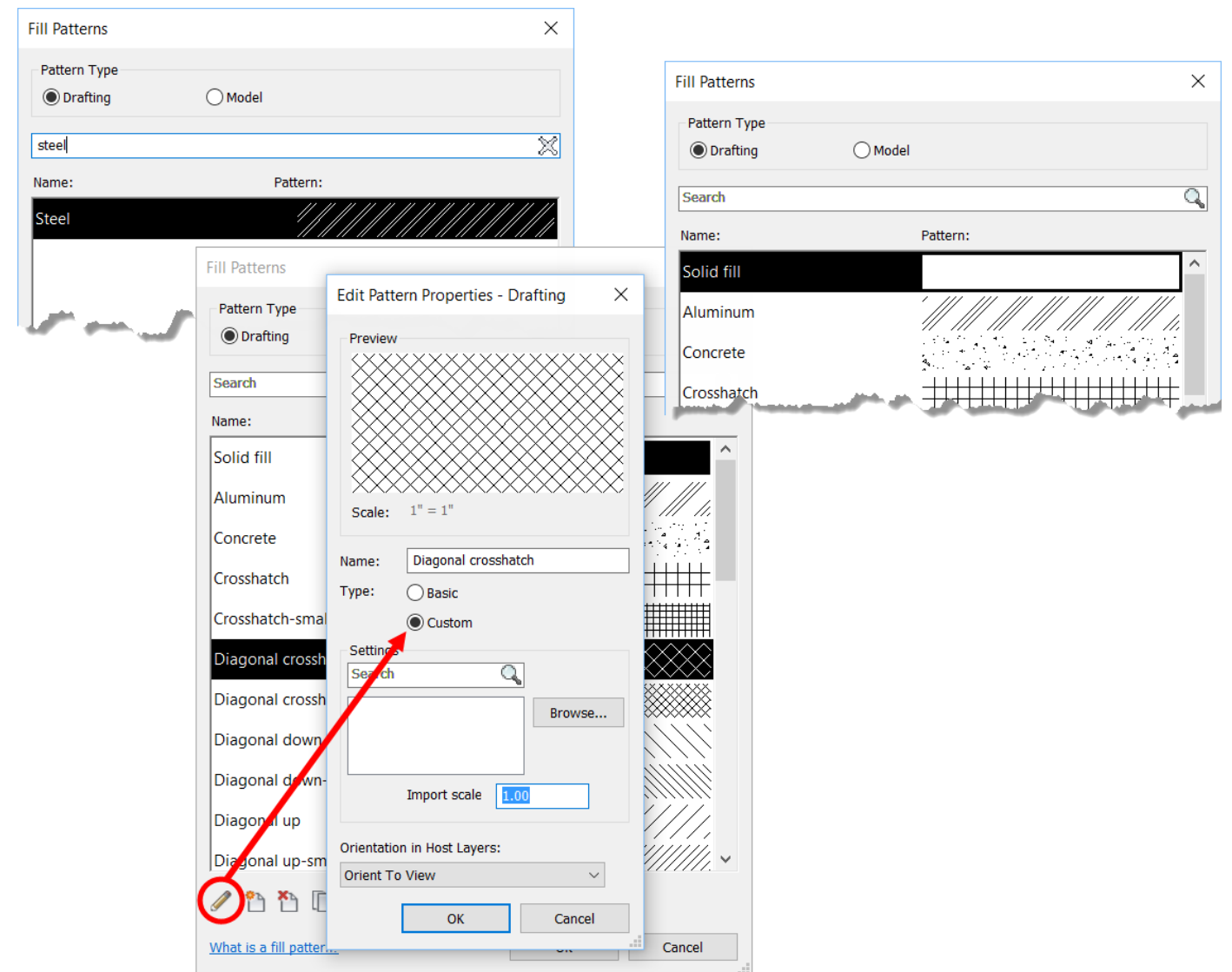

#29 Improved Section Box Controls

- Section box controls are improved
- The cursor will snap to the controls when it's close

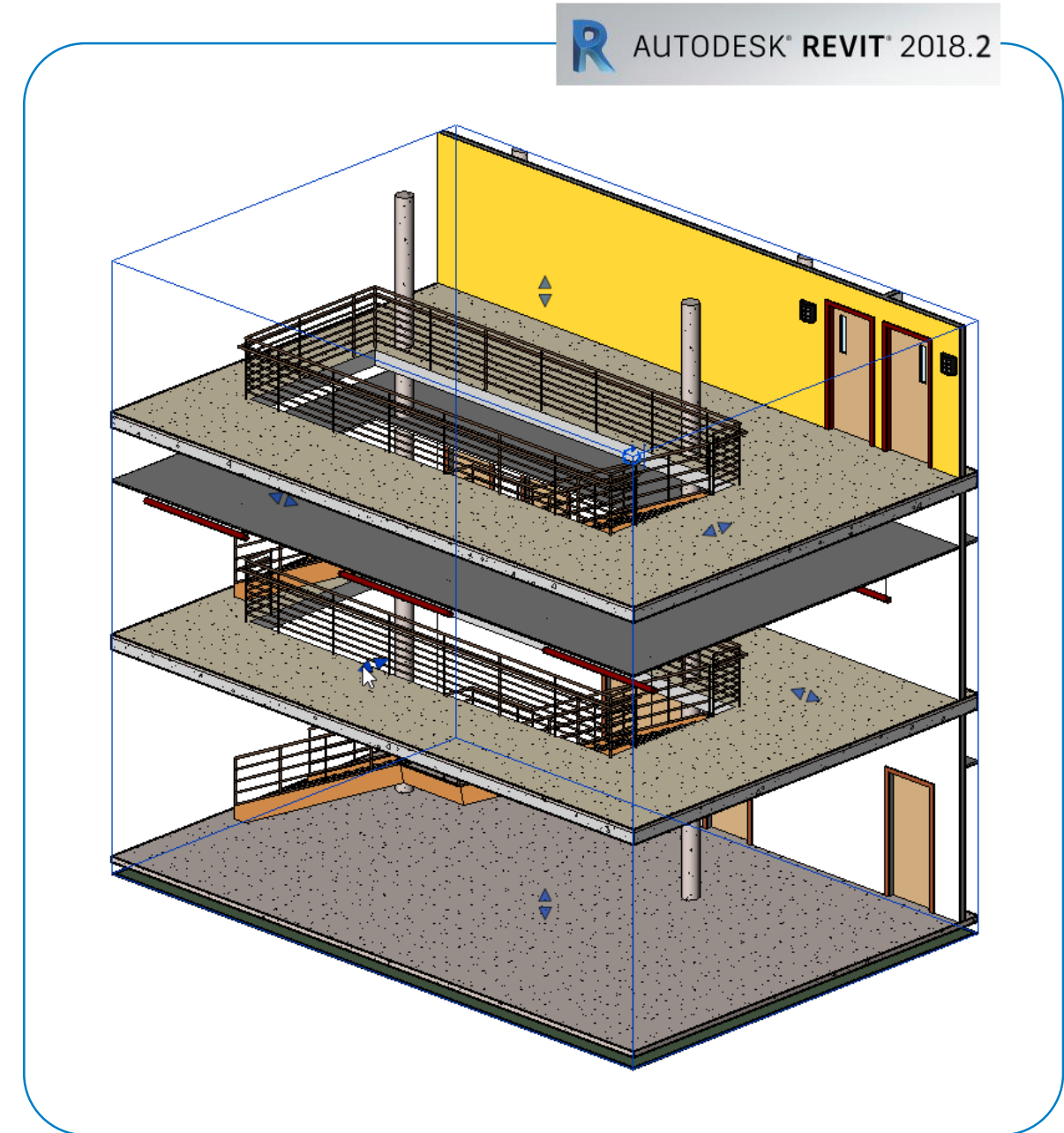

#30 Insight

- Use the Insight plug-in for additional tools
 - Heating and cooling loads
 - Daylighting analysis
 - Solar analysis

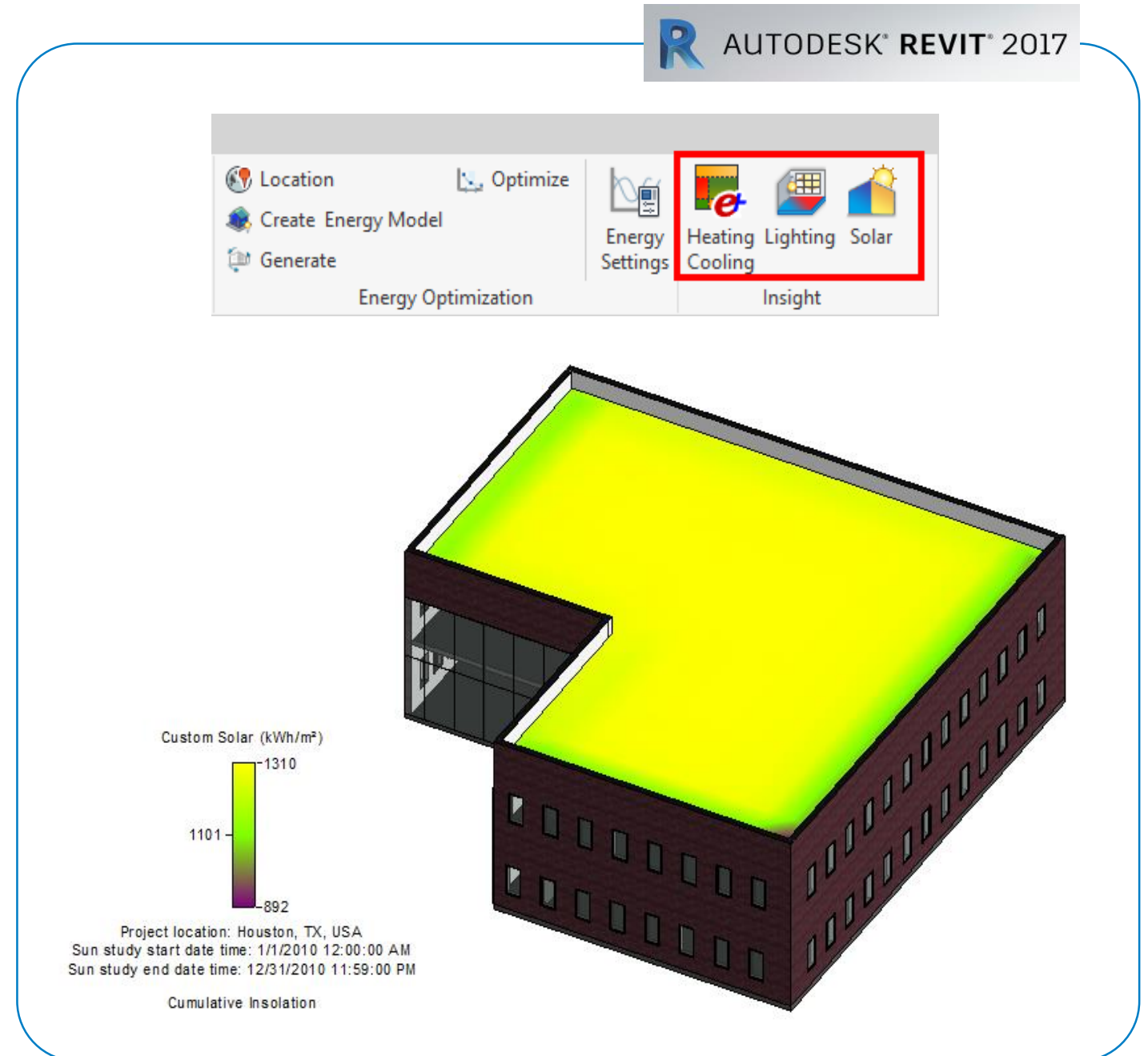

#31 Revit Live

- Real-time rendering program
- Navigate around a model to better visualize the design
- Revit Live is included in the Autodesk AEC collection

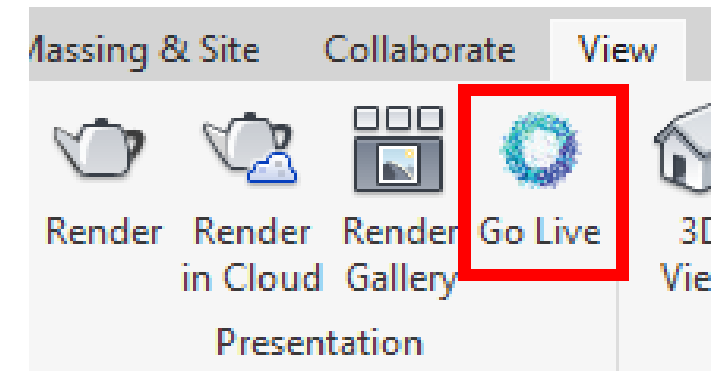

#31 Revit Live



For more information:



www.cadlearning.com



jboehning@cadlearning.com



www.cadlearning.com/about/theblastarchive



www.facebook.com/CADLearning



[@jasonboehning](https://twitter.com/jasonboehning)
[@wattonkatie](https://twitter.com/wattonkatie)



[Linkedin.com/in/jasonboehning](https://www.linkedin.com/in/jasonboehning)
[Linkedin.com/in/katiewatton](https://www.linkedin.com/in/katiewatton)

