

# Facility Management Data, Tracking and Reporting Simplified Using Forge

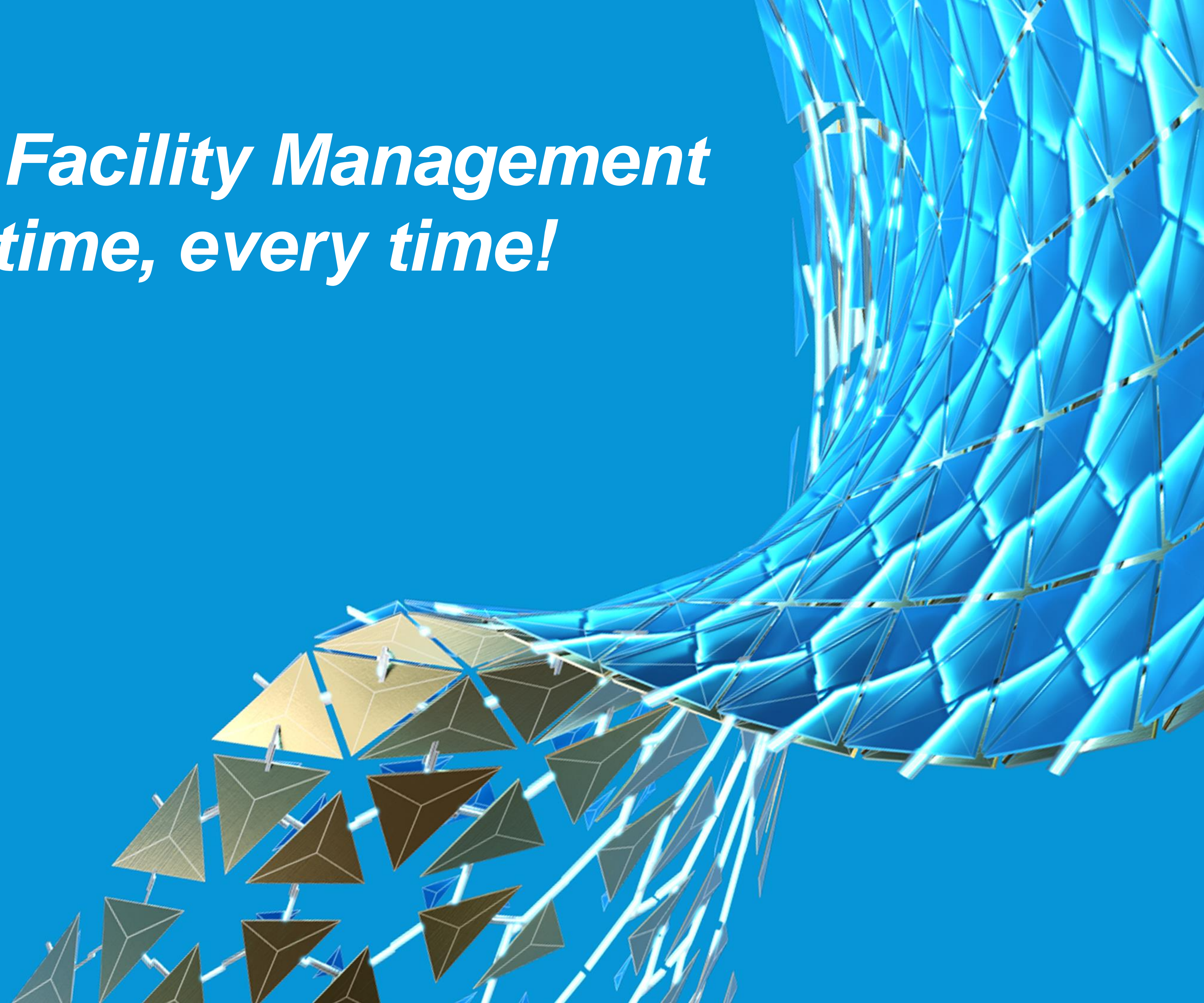

*Facilitate your Facility Management  
anywhere, anytime, every time!*







# Varun Bhartiya

## CEO, and Co-Founder of nCircle Tech

I established this organization to **enable passionate innovators in the AEC and Manufacturing industry to create impactful 3D engineering & construction solutions.** Leveraging our domain expertise in CAD-BIM, we **provide solutions that reduce time to market and meet business goals.** Each of our CAD and BIM software solutions is meant to **provide you ease, convenience, time and cost saving so that you can focus on things that matter more.**





## Bill Kilp

### President, faciliCAD LLC

He established this **software development company specializing in Facility Management software and consulting in 2001**. He supervises **Product Design and Development, Software Implementation, Project Management, Technical Support, Sales** and all the daily business activities. Bill has been **consulting, training, and implementing Computer Aided Drafting, Space Planning and Facility Management software and solutions** since the beginning of this firm and has **over 30 years of experience in the CAD/ CAFM industry**.

# What Will You See In This Class

- **Find and move employees**
- **Screen the data on the basis of**
  - Occupancies
  - Layers
  - Types of rooms
- **Quick and easier way to generate and print a report in the tabular format**
- **End to end workflow**

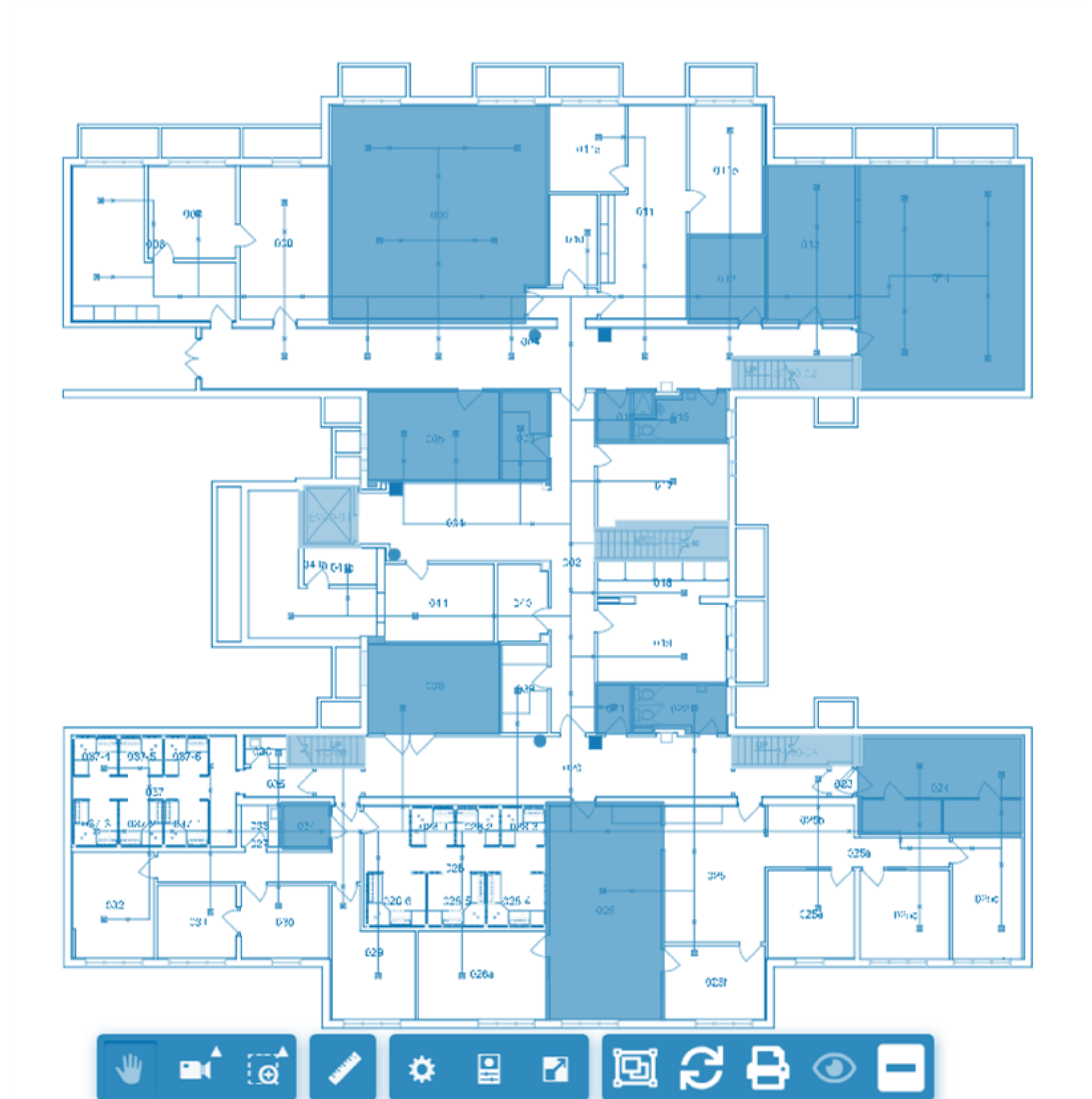

# Why cloud based CAFM solution?

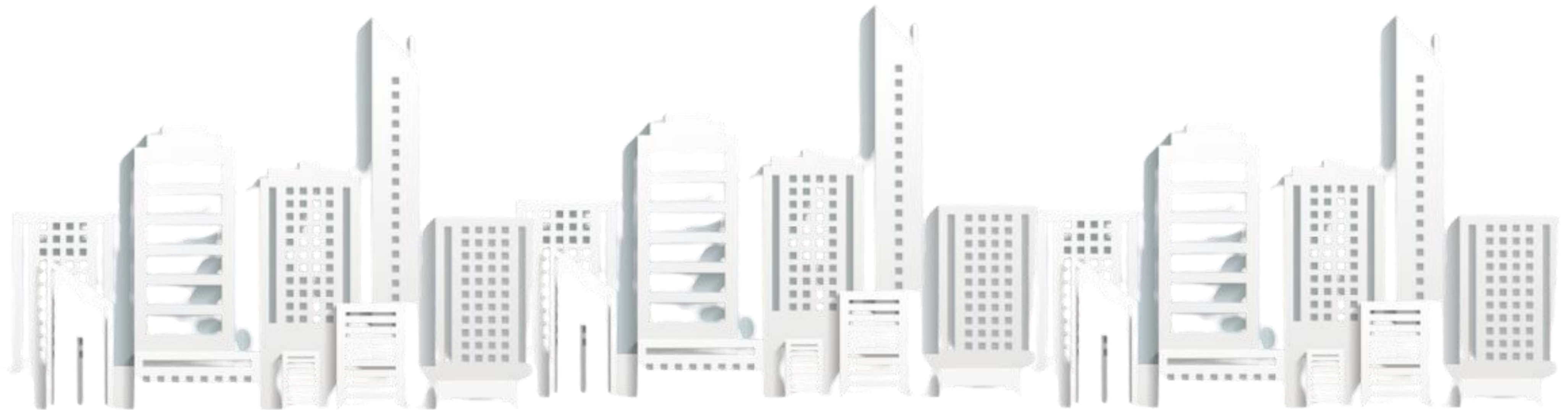



# Why cloud based CAFM solution?

- **No Experience Required**
  - In a Web based CAFM solution , no CAD experience is required
    - Open, View, Query, Hatch, Print drawings with virtually
- **No IT integration required**
  - No software needs to be installed
    - Eliminate the need for IT coordination
- **Reduces Dependency**
  - Designed for management teams and non-CAD team members
    - Eliminate the need for facilities people to get drawings and reports







*People want to access data and information from anywhere, on any device*



# Its Showtime!

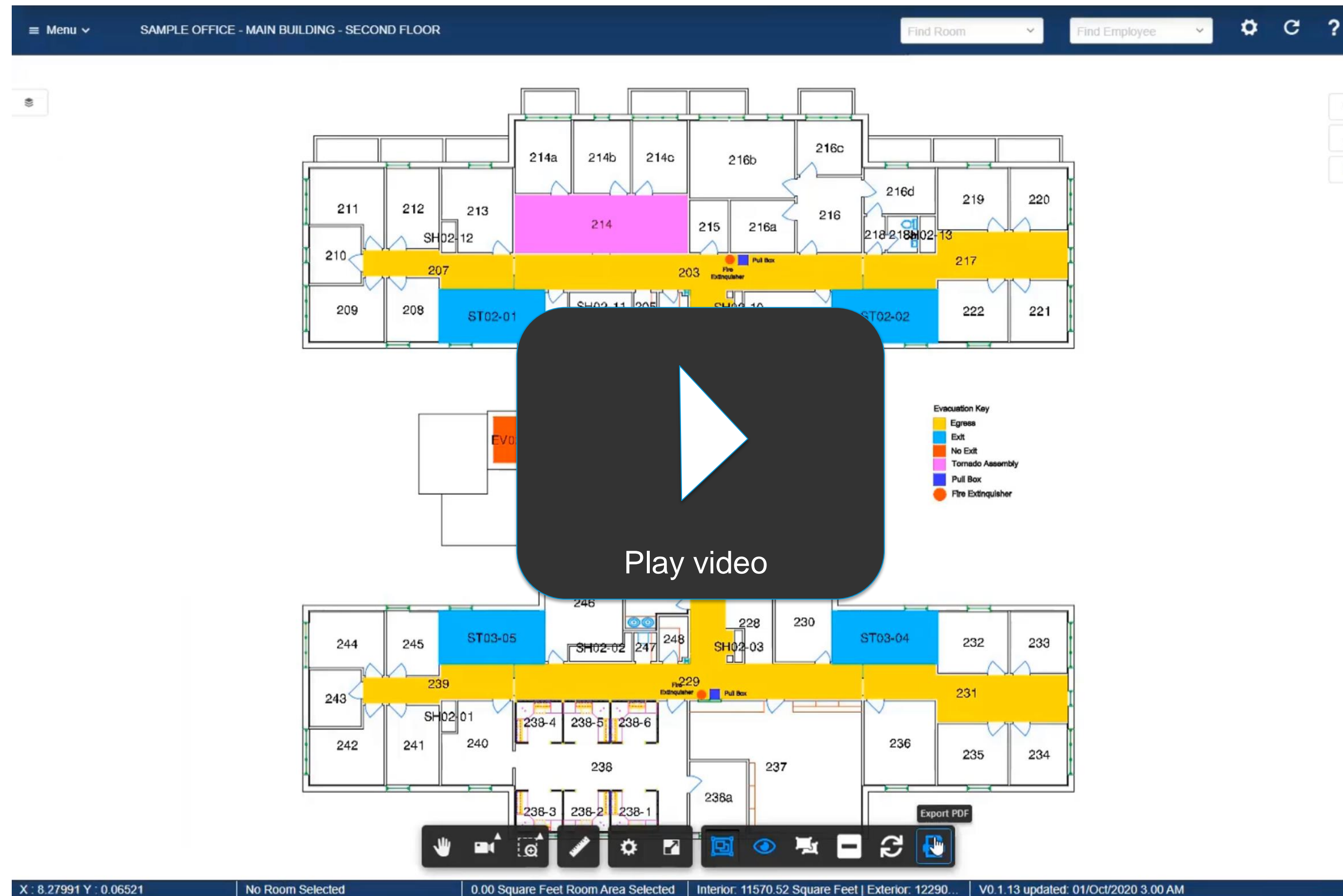

Let's look at the demo to understand this better



# The Steps

## STAGE A



Started from **an**  
**AutoCAD drawing**

## STAGE B



Prepared the **data** for  
**FM**

## STAGE C



In a single click  
**published it for the**  
**web**

## STAGE D



Anyone from within  
the organization can  
**access, operate,**  
**control, and analyze**  
**the data**



# Why you would prefer using CAFM as a solution on cloud

- Access the data from anywhere
- Collaborate across teams, functions and geographies
- Process data with ease through cloud

## How Forge Helped

- Save several months of development time
- Out of the box features
- Accuracy of data





What are the Best Practices?



# Use Your CAFM Solution Right

**Make it**  
COLLABORATIVE

Always think things through in the planning stages so that multiple people can collaborate simultaneously

**Infer from**  
GRAPHICAL DATA

Graphical Visualization of the data is much more effective than tabular information. It's much easier for people to look at

**Sync Data**  
REAL TIME

Access to real-time updated data is crucial for faster decision making

**Standardize**  
DATA INPUT AND  
MANAGEMENT

Enforce those standards by doing things like sync orgs in CAD drawings using defined layer standards



Data integrity and data accuracy  
are very critical for a  
CAFM solution



faciliCAD  
web



the only CAFM  
solution using  
Forge currently  
and truly an  
innovative  
solution and  
workflow





faciliCAD<sub>LLC</sub>

Thank you!





Autodesk and the Autodesk logo are registered trademarks or trademarks of Autodesk, Inc., and/or its subsidiaries and/or affiliates in the USA and/or other countries. All other brand names, product names, or trademarks belong to their respective holders. Autodesk reserves the right to alter product and services offerings, and specifications and pricing at any time without notice, and is not responsible for typographical or graphical errors that may appear in this document.

© 2020 Autodesk. All rights reserved.

