

# Optimizing Assemble using BIM 360

**Anthony IANDIORIO**

BIM-VDC Manager, Graitec Canada

**Eric Bernier**

Technical Director BIM-VDC, Graitec Canada



# Welcome!

- This is a 60 minute industry talk.
- We want it interactive, so login to : **meet.ps/au**
- Please switch mobile devices to silent mode.
- Please save questions for the end and/or type them into **meet.ps**
- Don't forget to fill out our surveys.



## About the speakers

### Anthony IANDIORIO, eng.

- Works in BIM since 2016
- Services provided : Implementation, training, coaching, BIM project management.
- Worked on public buildings, transportation, private real estate development, etc...
- Now BIM Manager at Graitec Canada



## About the speakers

### Eric Bernier, Can BIM CP

- Works with BIM tools since 2002
- Founded the Quebec BIM User Group in 2008
- Founded his own BIM consulting company in 2009 with 14 employees and 2 offices (Montreal and Quebec).
- Services provided : Implementation, training, coaching, BIM project management, BEP, change management.
- Worked on Universities, Hospitals, etc...
- International speaker (USA, Ireland, Canada)
- Now Technical Director at Graitec Canada

# About you!

We want to know about you, please login to participate!

**[meet.ps/au](https://meet.ps/au)**

Raffle at the end for all who participated.

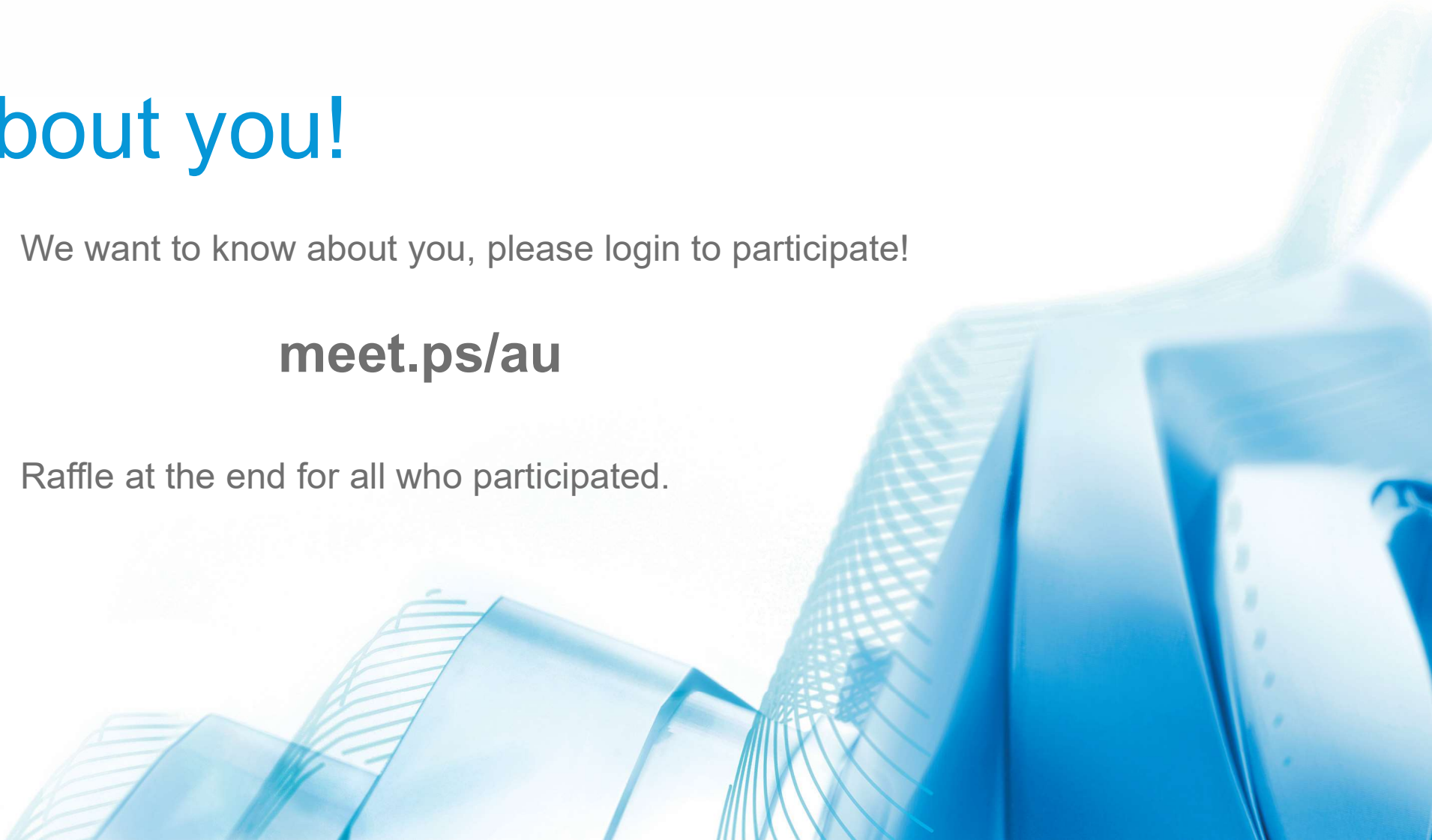

## Course description

This class will cover the simplicity of setting up a project in Assemble and linking it to a BIM 360 account in order to preserve a single source of truth and maximize on the 3Cs in BIM. We'll also cover best practices and offer more tips and tricks that will enable a more fluid workflow.

## Level of the audience

<sup>1</sup>in·ter·me·di·ate  *adjective* \,in-tər-'mē-dē-ət\

: occurring in the middle of a process or series

: relating to or having the knowledge or skill of someone who is more advanced than a beginner but not yet an expert



## Objectives



LEARN HOW TO :

- **CREATE A NEW PROJECT IN ASSEMBLE**

Just to be sure that everyone is on the same page here. How to do it quickly and efficiently.

- **LINK A BIM 360 FILE TO ASSEMBLE**

Mysterious to many, but so simple. Here is how to do it.

- **REORGANIZE DATA PER BUDGET COST CODES**

This is where the magic begins!

- **COMPLETE A COST ESTIMATE ANALYSIS**

And finally, the results we were looking for.



# Introduction

Our main objective is to share our experience with Assemble for all AEC professionals and demonstrate the value that BIM360 adds to simplify your workflows

- First, what roles are affected by BIM?
  - Owner and/or Operator
  - Architect / Engineer
  - Estimator
  - Project Manager

# Introduction – Roles

## OWNER AND/OR OPERATOR

- Key to a project providing vision and capital
- Facilities become enterprise assets
- Operation and maintenance requires data

## ESTIMATOR

- Produce budgets at lightning speed
- Analyze constructability and conformance to client budgets.

## ARCHITECT / ENGINEER

- First in the project development phase
- Design per Owner's needs
- Design per regulatory codes and best practice
- Starting point for BIM

## PROJECT MANAGER

- Ensure that the project is executed according to:
  - Quality specifications
  - Master schedule
  - Established budget

# Introduction – Tying the Knot with BIM

We need information and we need it now: **hello Assemble!**

## OWNER AND/OR OPERATOR

- Holistic view of the digital twin throughout the whole project lifecycle
- Can leverage the data rich environment of a model without extensive training on modeling software such as Revit

## ARCHITECT / ENGINEER:

- Leveraging data rich models to extract quantities quickly for budget presentation
- Link to BIM360 Docs for technical review with design/build team (ie. Tech data sheets, shop drawings, etc...)

# Introduction – Tying the Knot with BIM

We need information and we need it now: **hello Assemble!**

- **CONTRACTORS (*SUBCONTRACTORS AND GENERAL CONTRACTORS*):**
  - Estimators:
    - ✓ Leveraging data rich models to extract quantities quickly for budget prep / analysis
    - ✓ Use of specialized add-ins such as Excel, Power BI and the desktop Class Editor offering greater flexibility for data presentation / analysis.
  - Project Managers:
    - ✓ Link to BIM360 Docs for technical review with design/build team
    - ✓ Create, track and manage Issues identified in Assemble model viewing



Let's dive in.....

# Create your Account / Login

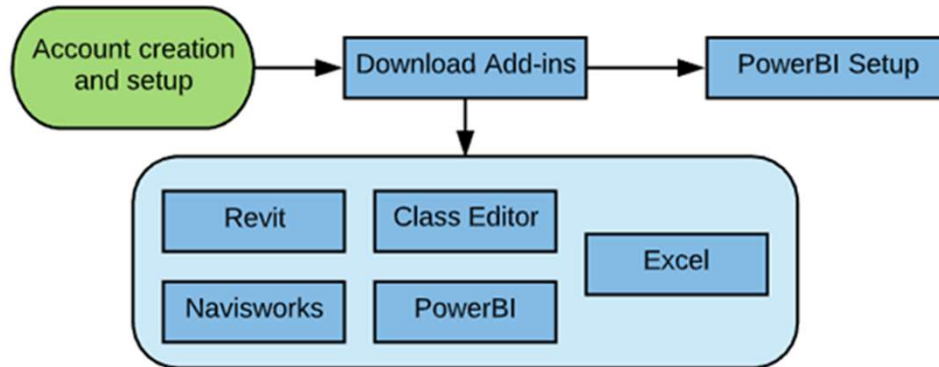

- Very simple now that you could use your Autodesk ID
- Not an Autodesk user yet, just create a new account

**AVAILABLE NOW**

## ASSEMBLE + BIM 360

Access specifications and documents from BIM 360 directly in your Assemble model.

[LEARN MORE](#)

### Assemble Login

Email

Password

[Sign In](#)

[Forgot your password?](#)

---

Got an Autodesk Account?

[Sign In with your Autodesk ID](#)

© 2012-2019 Autodesk Inc. All rights reserved. Version 4.11.1.62

# Download Add-ins

These are the ones we've tested and recommend:

- **Revit plug-in** is a priority for all
- **Class Editor**: Custom calculation
- **PowerBI**: Data viz
- **Excel**: Link your company templates to Assemble

The screenshot shows the Assemble Systems website header with the logo "assemble AN AUTODESK COMPANY" and navigation links: "WHO WE ARE", "WHAT WE DO", "WHO WE SERVE", "RESOURCES", "BLOG", and a "FREE TRIAL" button. A dropdown menu is open under "RESOURCES", listing: "Brochures", "Case Studies", "Customer Testimonials", "Downloads", "Events", "Support & Training", "Webinars", "Whitepapers / Workflows", "Videos", and "Customer FAQ". The main content area has a blue banner with the text "Moving Forward Together" and a sub-header "In addition to BIM solutions, Assemble Systems is committed to providing products and services that help you grow, improve and optimize outcomes for each and every project." Below this, a breadcrumb trail reads "All / Brochures / Case Studies / Downloads / Events / Support & Training / Webinars / White Papers - Workflows". A grid of six download links is displayed, each featuring the Assemble logo and a partner logo. The links are: 1. Assemble + N (Revit plug-in), 2. Assemble + RAC (Class Editor), 3. Assemble + sage (Sage integration), 4. Assemble + ORACLE PRIMAVERA (Class Editor), 5. Assemble + EXCEL (Excel Add-in), and 6. Assemble + POWER BI (Power BI Files). The first three links are in a red-bordered box, and the last three are in a red-bordered box.

 CLASS EDITOR (DOWNLOAD) Class Editor Download ...	 SCHEDULE INTEGRATOR ADD-IN (DOWNLOAD) Schedule Integrator Add-in ...	 EXCEL ADD-IN (DOWNLOAD) Excel Add-in ...
 POWER BI FILES (DOWNLOAD) Power BI Files Download ...		

# Important notes for PowerBI

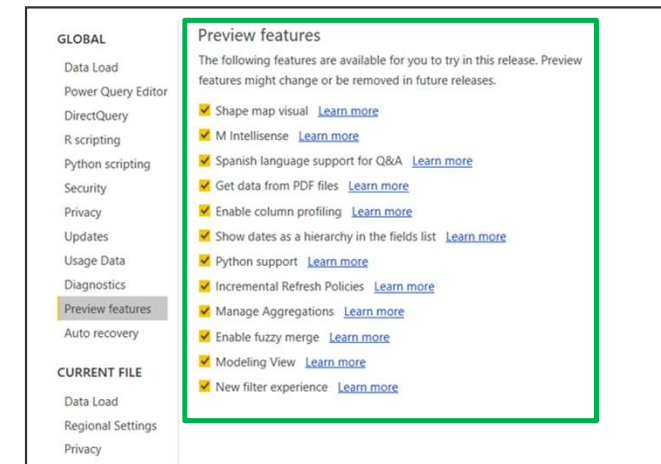
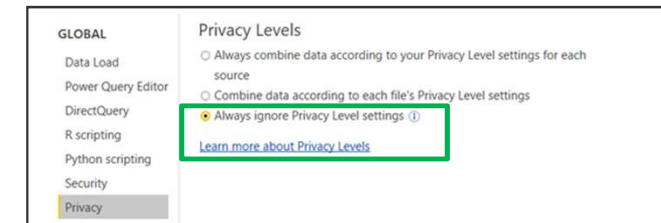
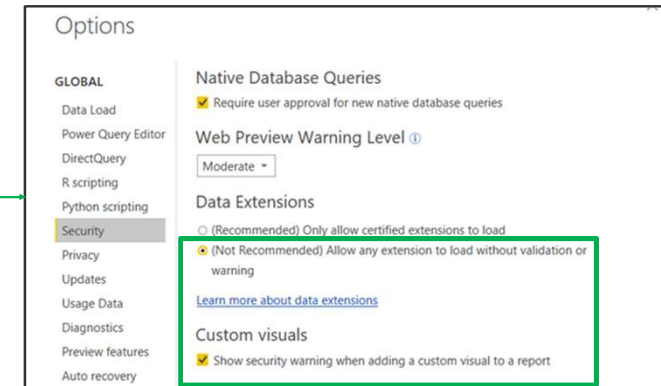
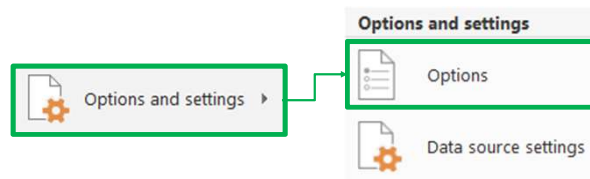
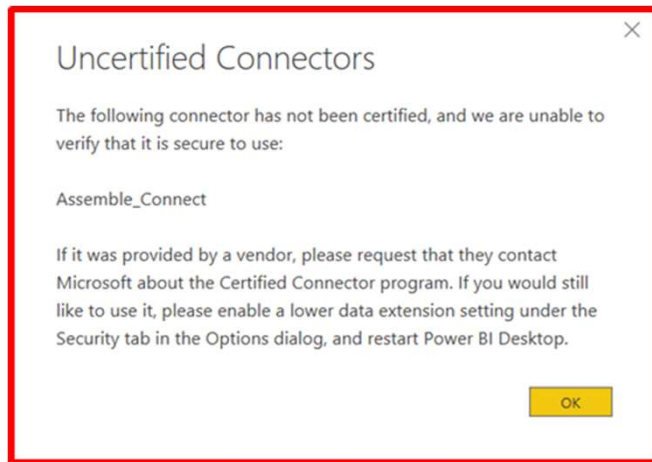

- Adjust your PowerBI security settings before opening the .pbix
- Save PowerBI templates to **PC > Documents > Microsoft Power BI Desktop**



# Create your Account / Login

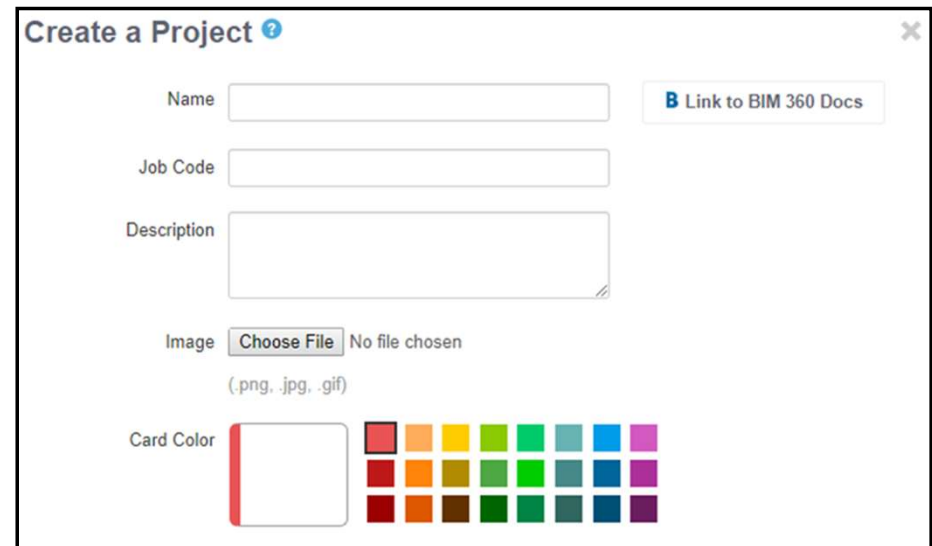
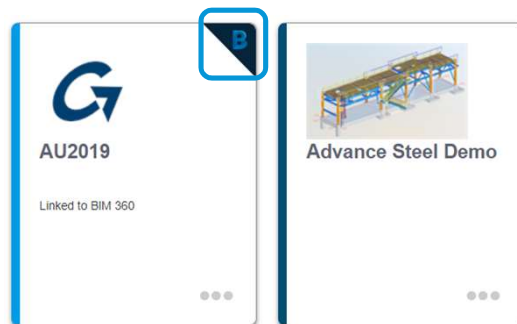
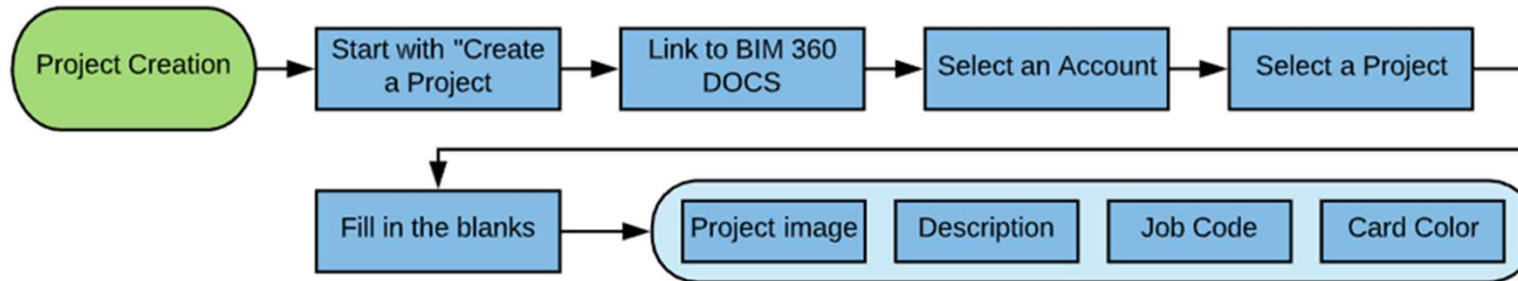

The 'Create a Project' form includes the following fields and options:

- Name:** A text input field.
- Job Code:** A text input field.
- Description:** A large text area.
- Image:** A 'Choose File' button and the text 'No file chosen'.
- Card Color:** A color selection interface with a vertical bar and a 4x8 grid of color swatches.

A 'Link to BIM 360 Docs' button is located in the top right corner of the form.

Very simple now that you could use your Autodesk ID

- Use the **Link to a BIM 360 Project** button
- Make changes to your project using the **Edit Project**

# Project setup and loading Revit files

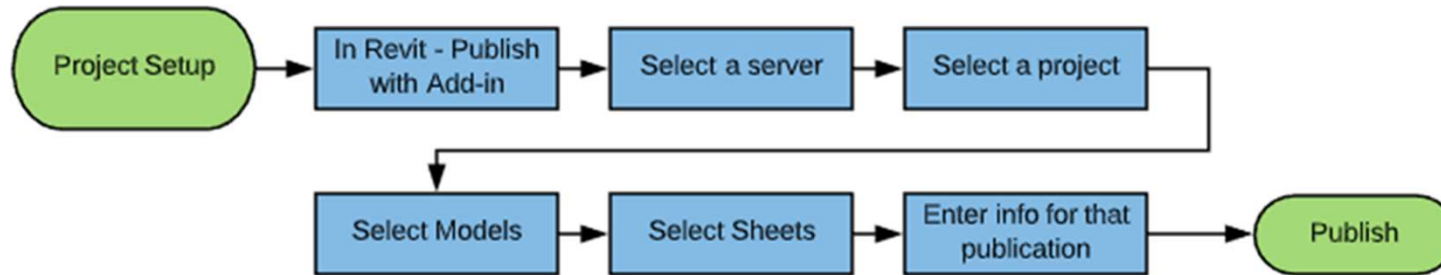

- Use Revit plug-in to publish a model
- Enter a valid domain: [adskpartners.tryassemble.com](https://adskpartners.tryassemble.com)
- Files with links will be detached in Assemble and may take a while

# Project setup and loading Revit files

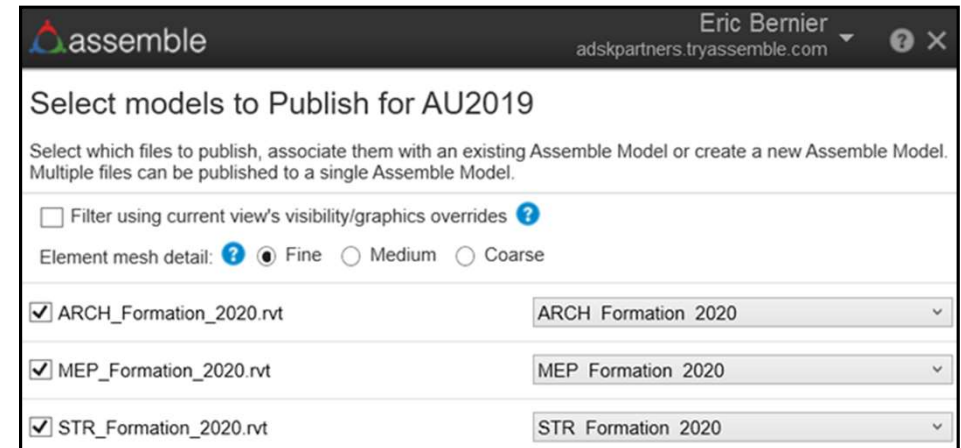
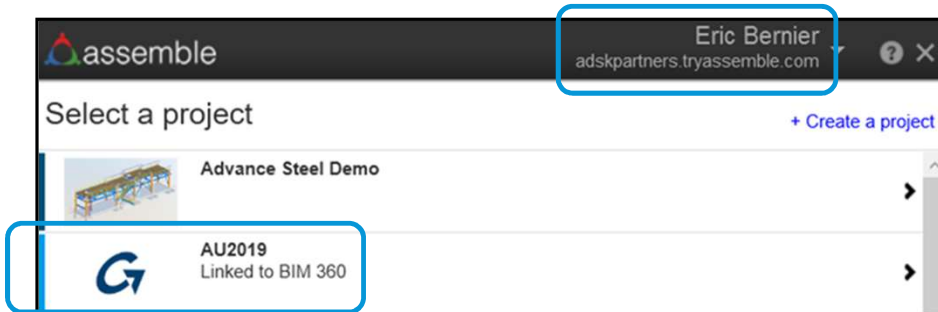

- ☐ Publish sheets from the Revit sheet set:
- Toutes les feuilles + 3d
- [Help with Revit Sheet Sets](#)
- ☒ Publish all sheets in the current Revit project
- ☐ Do not publish sheets. Only publish 3D and model data.

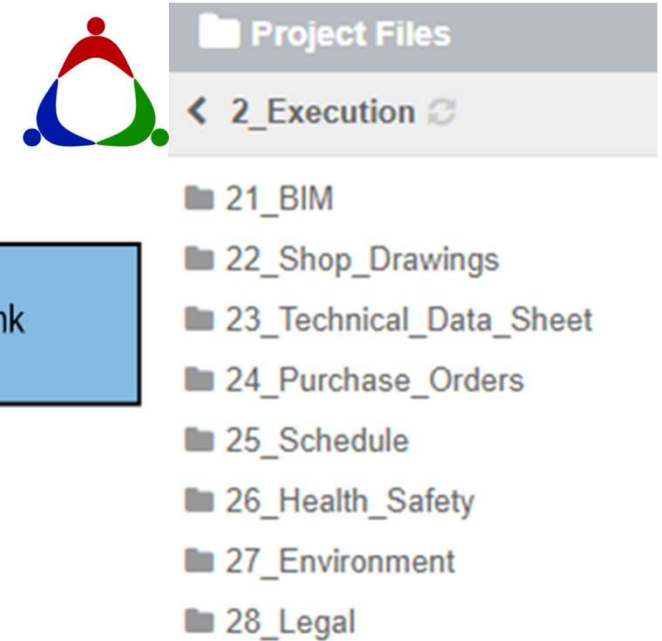
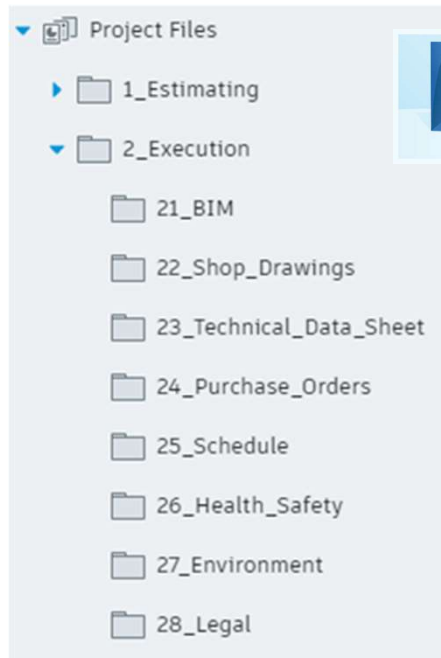

## BIM360 DOCS

Here you will have created a folder structure that meets your company's workflow for document management.

## BIM360 in Assemble

The exact folder structure and related documents from your BIM360 account are accessible through the Assemble cloud.

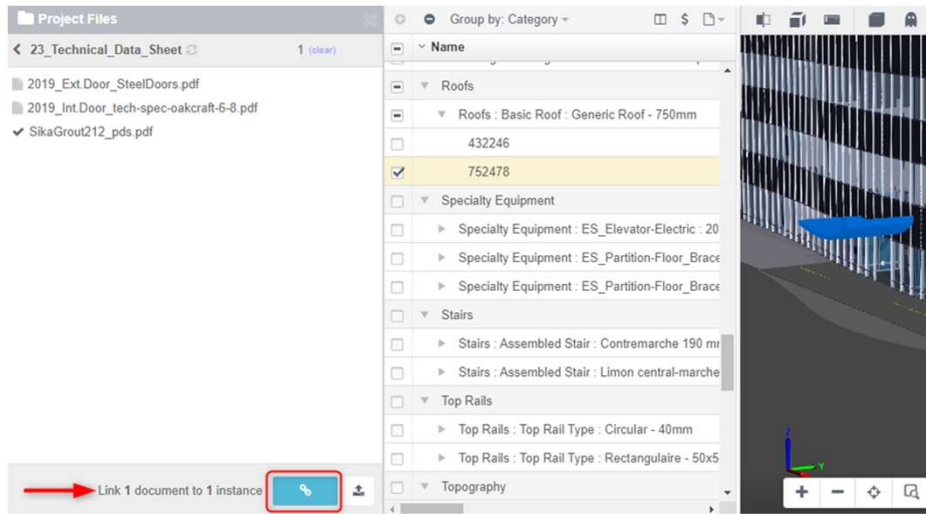

## Before

Select object > Navigate Project Files >  
Link button

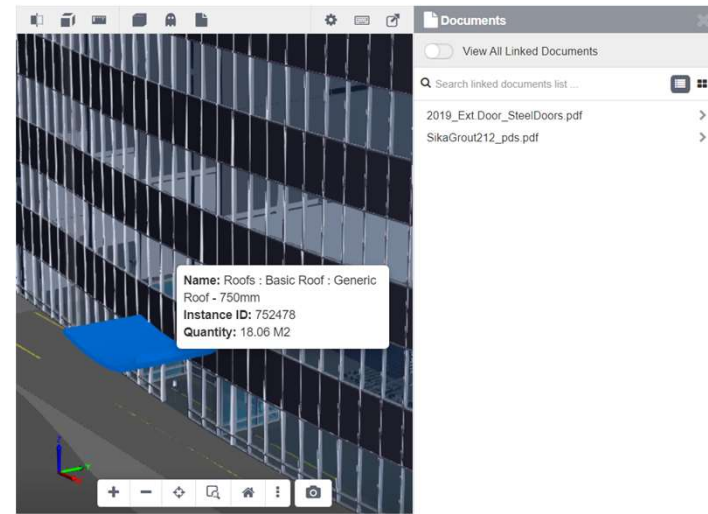

## After

The file is saved in the documents property of  
Assemble



# Create and manage Issues

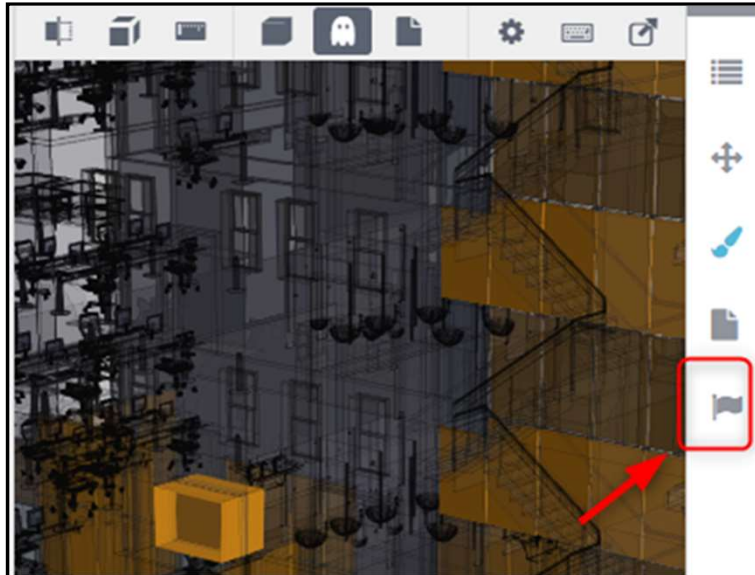

- Zoom to the **Issue**
- Select the **flag icon** in the right ribbon
- **Create and track the Issue** directly in the Assemble cloud or navigate a BIM360 account to see all Issues on the project

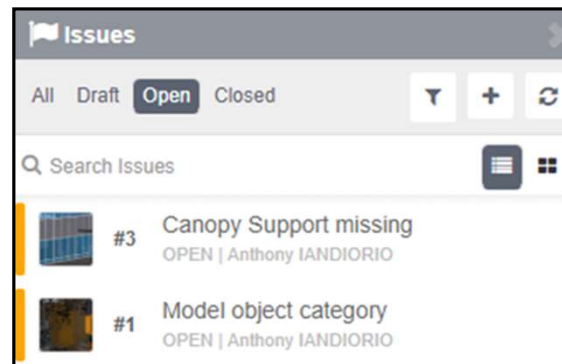
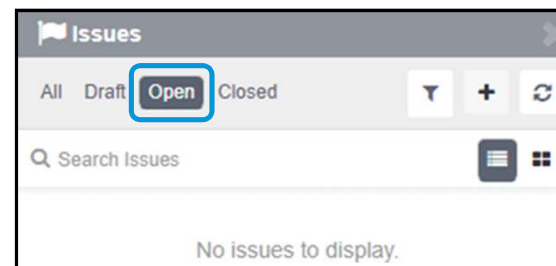
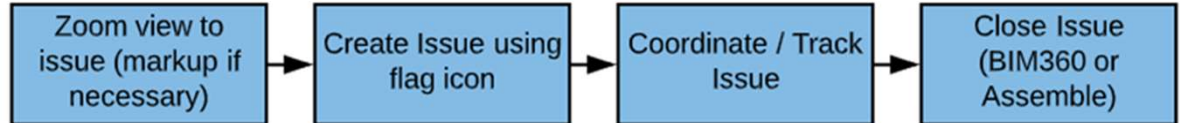

**Issues**

### Create Issue

**Subject**

Enter Subject

**Description**

Enter Description...

**Status**

Open

**Assigned To**

Assign to...

**Attachments**

Camera icon

# Document Management

FOLDERS

REVIEWS

TRANSMITTALS

ISSUES



Status	ID ▾	Type	Sub-type	Title	Location	Assigned to
Open	3	Design	Design	Canopy Support missing	-	Anthony IANDIORIO
Open	2	Design	Design	Wall connection problem	-	Eric Bernier
Open	1	Design	Design	Model object category	-	Anthony IANDIORIO



Keep calm, it's all there in  
**BIM360**





## Quick Cost Codes



# Step 1: Organizing Data per Cost Codes



- It is possible to select multiple models in a view (ie. Arch + MEP).
- Here's a common example for Division 03 and 09.

AU2019

Search by name press enter to select

MODELS

ARCH_Formation_2020	...
<b>ARCH_Formation_2020_detached</b>	3942 objects 2019-11-01
MEP_Formation_2020	4546 objects 2019-11-01
<b>STR_Formation_2020</b>	603 objects 2019-11-01

**Save View** [X]

033000 - Concrete Supply

Cancel Done

Untitled View [Save Icon]

090000 - Drywall

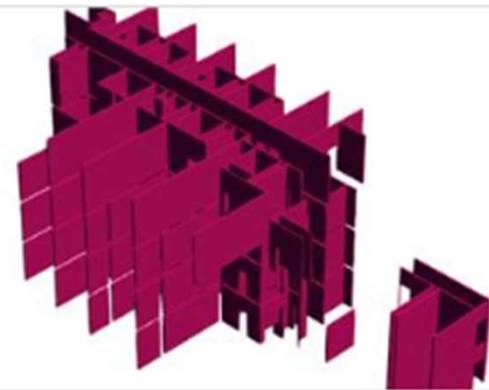

033000 - Concrete supply

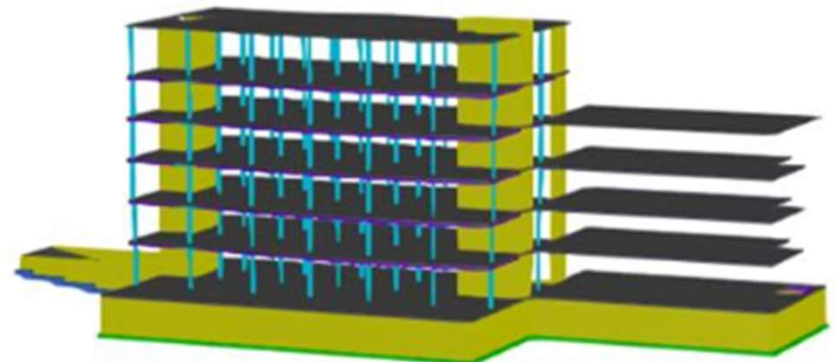

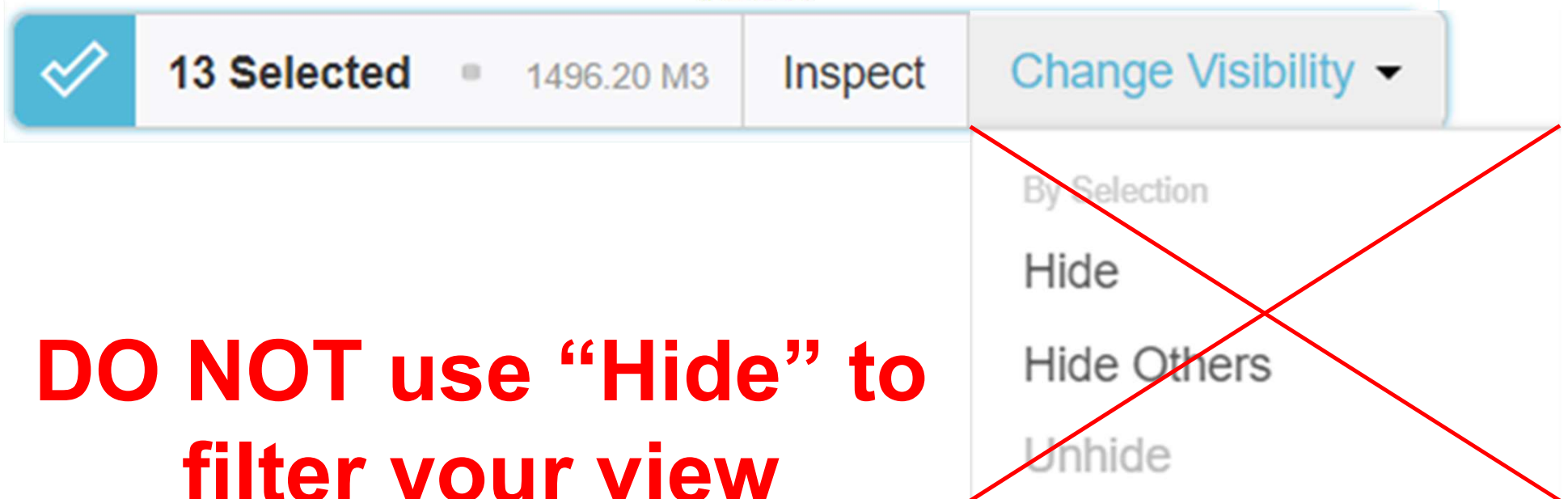

**DO NOT use “Hide” to  
filter your view**

**Not recommended** as this causes a static view that could not be changed

# Intelligent Data sets



A few tips before starting:

- Visibility Settings allows for better flexibility when filtering data

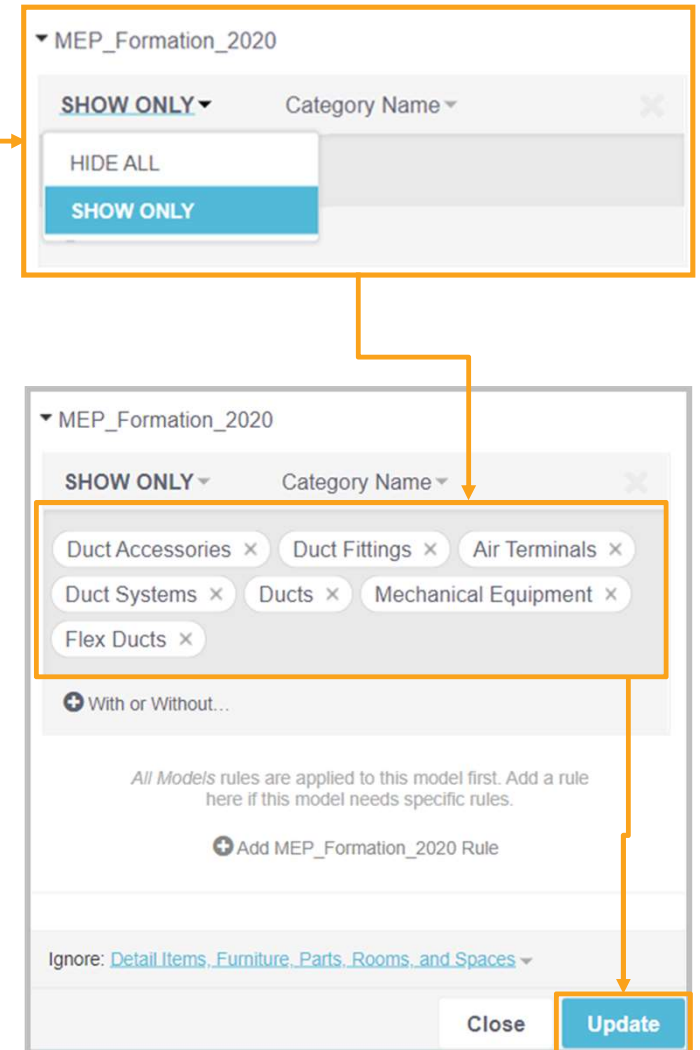
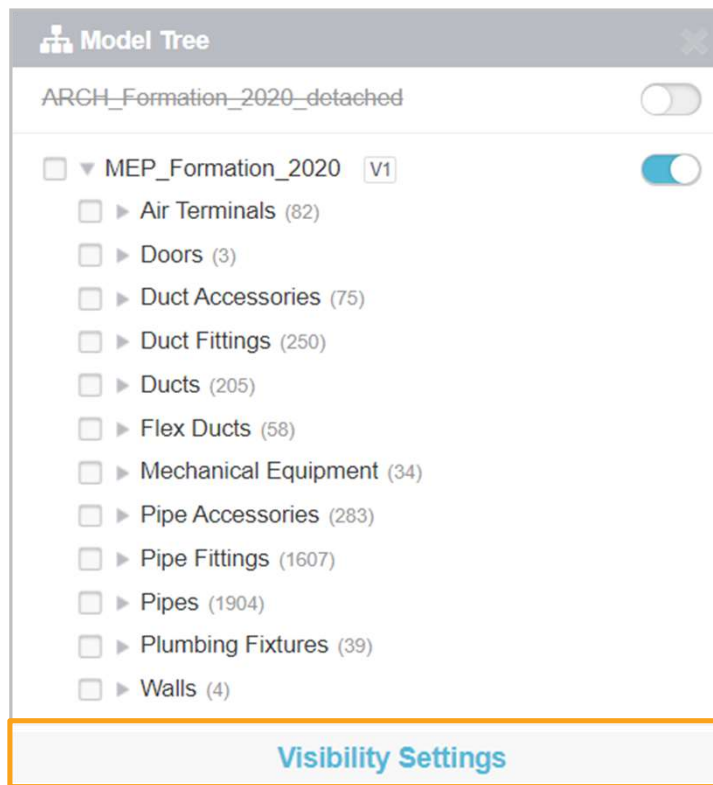

# Intelligent Data sets



Tip:

- Using the color by property further improves data visibility

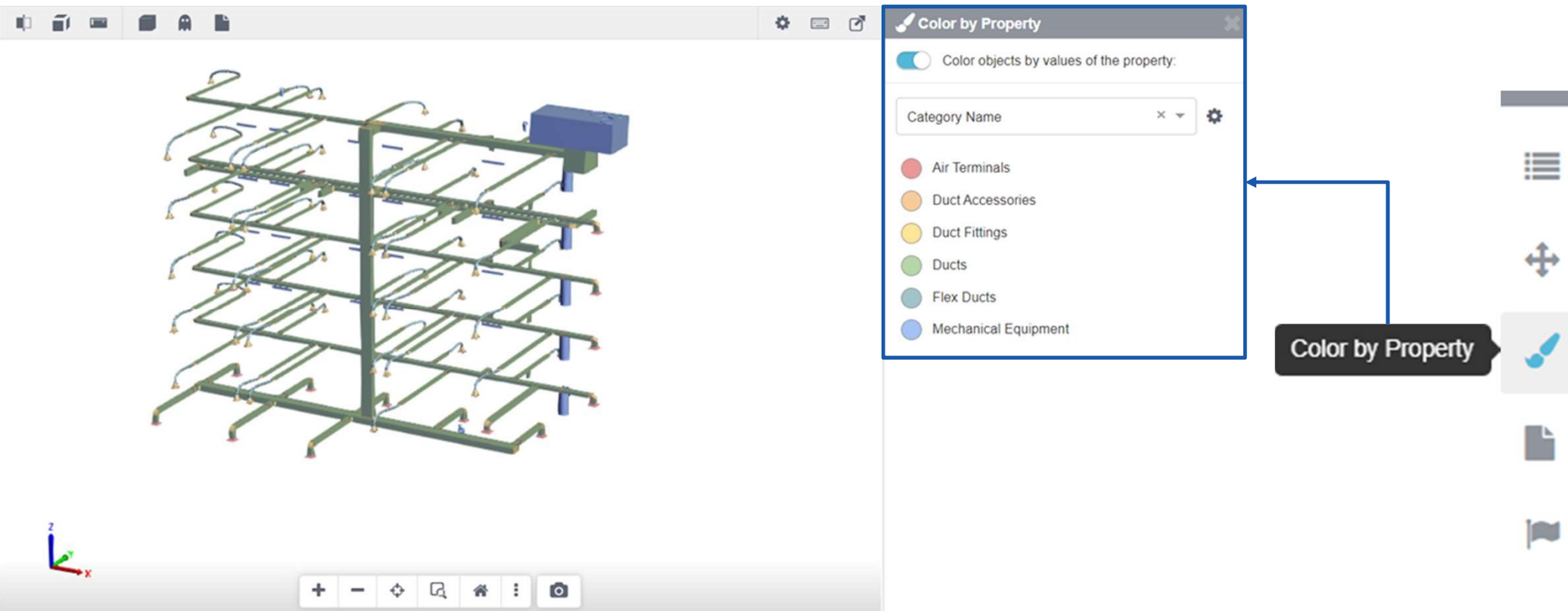



Dilbert.com DilbertCartoonist@gmail.com



12-7-09 ©2009 Scott Adams, Inc./Dist. by UFS, Inc.



## Cost Estimate Analysis

# Assemble Class Editor



A few tips before starting:

- Make sure you use a valid URL.
- Know your **end result**.
- Create additional properties in Assemble if they don't already exist.

Open Assemble

Assemble URL:

Username:

Password:

Project:

View:

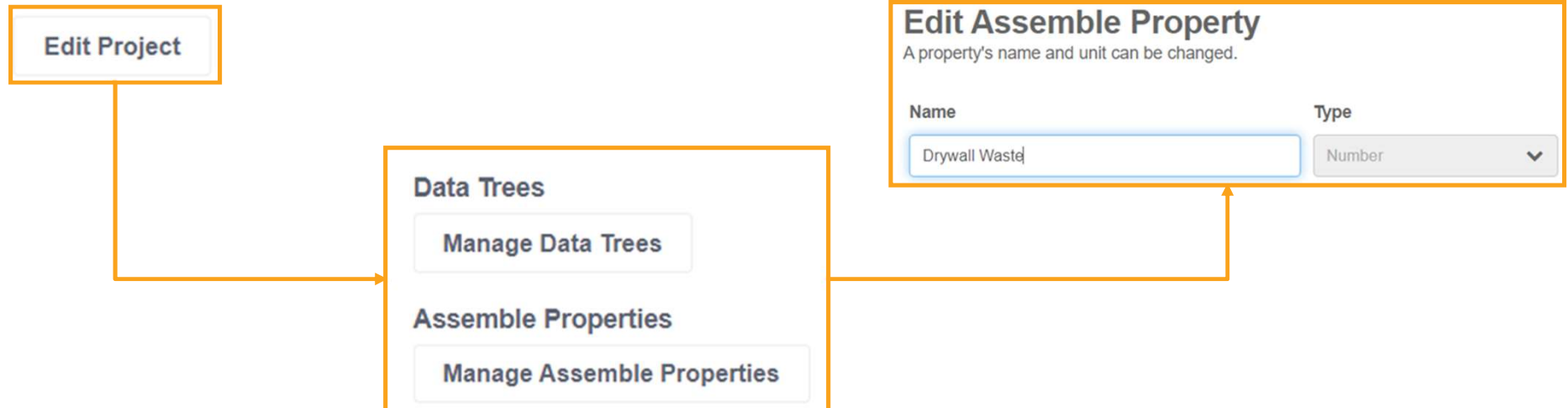



# Working in the Class Editor

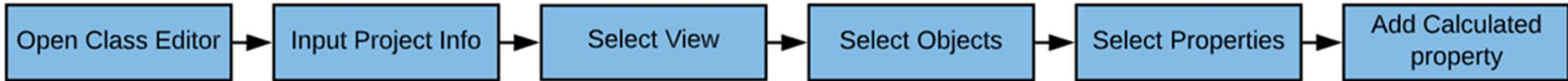

A few tips before starting:

- Start with a specific object in the model
- Create a Calculated Property 
- Apply the Calculated Property to other objects using a Filter

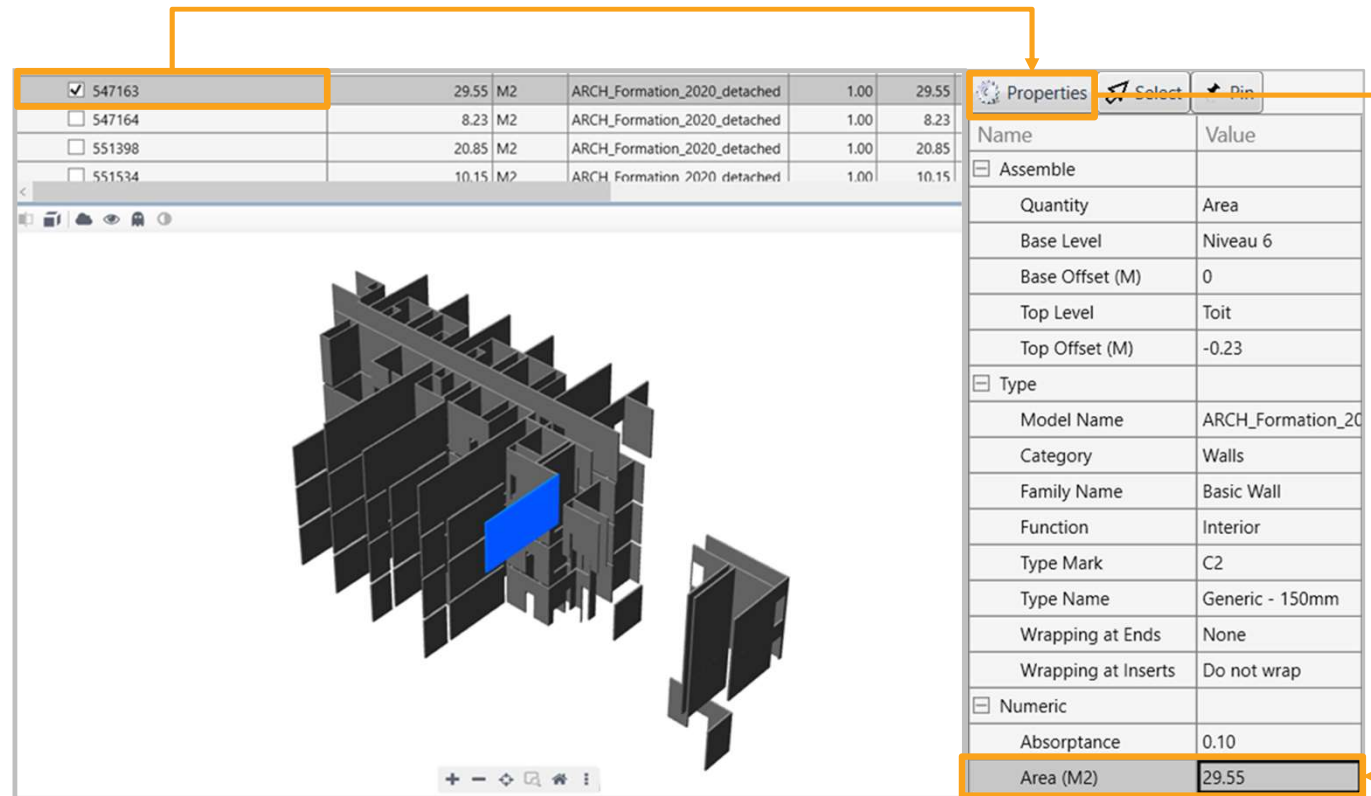
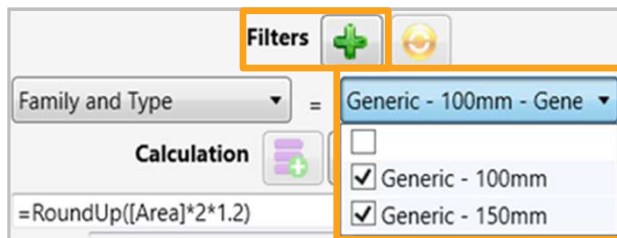

# Back to Assemble



Once calculations are applied to all objects the changes will appear in the Assemble cloud

Group by: Category

Columns

\$ Estimate

Import/Export

	Name	Quantity	Unit	Drywall Waste
	Walls	3,578.87	M2	
	Walls : Basic Wall : Generic - 100mm	1,134.76	M2	2,802.00
	Walls : Basic Wall : Generic - 150mm	2,444.11	M2	5,959.00

3D visualization of a building structure, showing walls and drywall waste. The walls are colored blue and green, and the drywall waste is highlighted in green. A 3D coordinate system (x, y, z) is visible at the bottom left of the model.



# Awesome Visualization with Power BI

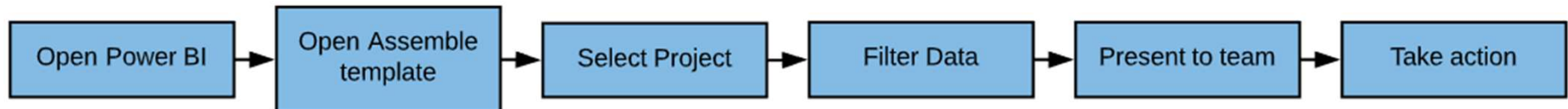

☐ (Select All)

☐ Advance Steel Demo

☒ AU2019

Project Design and Estimating

Version ASM\_VERTOKEN| Template for project design and estimating.

Site Sub-Domain ⓘ

adskpartners

Project Name ⓘ

Load Cancel

Load

Edit

Queries [11]

- Site Sub-Domain (adskpa...
- Project Name (...)
- \_Measures
- Project
- Model
- Model Version
- Grid Data
- Selected Project

	ABC Id	ABC Project Name
1	25	AU2019

= Table.SelectRows(#"Filtered Rows by Pr

# Awesome Visualization with Power BI

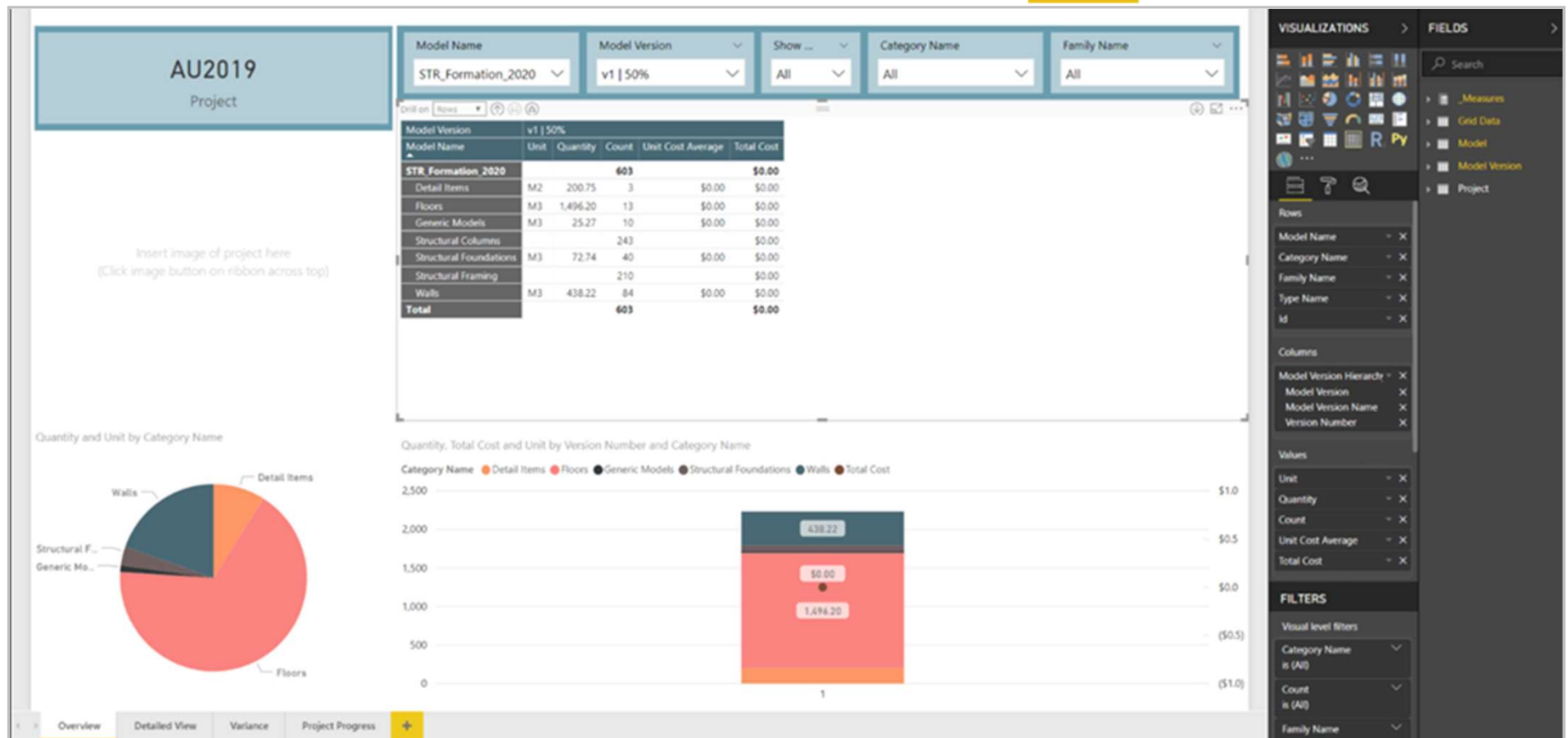

# Link to Existing Excel File



## Tips:

- Have an existing Excel template? Keep using!
- Make sure the Assemble connection is to the right model (ie. ARCH vs. STR vs. MEP)

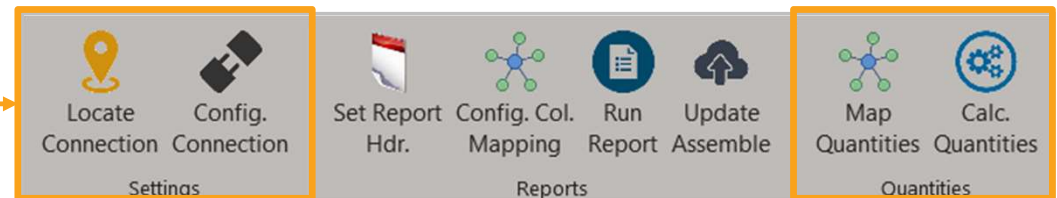

# Link to Existing Excel File



Assemble Report Connection

URL:

User Name:

Password:

Project

☒ View ☐ Model

Version

Assemble Report Connection

URL:

User Name:

Password:

Project

☐ View ☒ Model

Version

# Link to Existing Excel File



Map Quantity

Quantity Property:  
Count

Filter Property:  
Family Name

Filter Values:  
M\_Cuvette réservoir-3D  
M\_Pompe - A fixation par base plane  
M\_Réduction - PVC - Nom. 40 - DWV  
M\_Robinet à tournant - PVC - Nom. 40 - C  
M\_Roof Drain  
M\_Rooftop AC Units - Gas Fired - 97-176  
M\_Té - Soudé - Générique  
M\_Transformation - Soudé - Générique  
**M\_Tub-Rectangular-3D**  
M\_Urinoir - Mural  
M\_Vanne d'isolement - 10-40 mm  
M\_WC - A réservoir mural  
Pipe Types  
Rectangular Duct  
Rectangular Elbow Eccentric Radius - D  
Rectangular Endcap

Add

Filters

Property Name	Property Value
Family Name	M_Tub-Rectangular-3D

Delete Selected

Cancel Save

[Link to Existing Excel File](#)



<b>AU2019</b>			
Projet 19001			
<b>220000 - Plumbing Direct Costs</b>			
Div.		Qty	Unit Unit Price
<b>22 00 00 - PLUMBING</b>			
22.01	Plumbing		<i>sous-total</i>
	Plumbing piping		l.m. 20.00 \$
	Drain piping		l.m. 15.00 \$
	Hot water tanks		units 300.00 \$
	Toilette bowls		units 300.00 \$
	Urinals		
	Bath tubs		

**{"QuantityPropertyId":"Count","Filters":**  
**[{"FilterPropertyId"**  
**:"FamilyName","FilterValues":["M\_Tub-**

## Link to Existing Excel File



<b>AU2019</b>						
Projet 19001						
<b>220000 - Plumbing Direct Costs</b>						
Div.		Qty	Unit	Unit Price	Total	Sub-Total
<b>22 00 00 - PLUMBING</b>						<b>40,460.73 \$</b>
<b>22.01</b>	<b>Plumbing</b>			<i>sous-total</i>		<b>40,460.73 \$</b>
	Plumbing piping	1,588	l.m.	20.00 \$	31,764.96 \$	
	Drain piping	580	l.m.	15.00 \$	8,695.76 \$	
	Hot water tanks	5	units	300.00 \$	1,500.00 \$	
	Toilette bowls	3	units	300.00 \$	900.00 \$	
	Urinals	3	units	300.00 \$	900.00 \$	
	Bath tubs	11	units	300.00 \$	3,300.00 \$	

<b>AU2019</b>						
Projet 19001						
<b>030000 - Concrete Direct Costs</b>						
Div.		Qty	Unit	Unit Price	Total	Sub-Total
<b>03 00 00 - CONCRETE</b>						<b>3,208,960.51 \$</b>
<b>3.01</b>	<b>Structural Framing</b>			<i>sous-total</i>		<b>3,208,960.51 \$</b>
	Concrete footings volume	73	m3	200.00 \$	14,548.42 \$	
	Concrete walls volume	438	m3	200.00 \$	87,644.45 \$	
	Concrete columns volume	132	m3	200.00 \$	26,428.78 \$	
	Concrete slabs volume	1,496	m3	200.00 \$	299,239.75 \$	
	Approximate total Rebar	1,391	MT	1,500.00 \$	2,085,824.33 \$	
	Approximate Rebar labor	1,391	MT	500.00 \$	695,274.78 \$	

# Update Assemble from Excel



## Tips:

- Make sure all columns are **Set to Header**
- Make sure the Assemble connection is to the right model (ie. ARCH vs. STR vs. MEP)



Category Name	Level	Quantity	Unit Cost	Sub-Total	Zone/Area
Windows_FE_Fixed	Niveau 2	1	0	0	
Windows_FE_Guillotine	Niveau 2	1	0	0	
Windows_FE_Imposte	Niveau 1	1	0	0	

Group by: Category									
Name	Quantity	Unit	Model Name	Count (EA)	Height (M)	Thickness (M)	Unit Cost	Total Cost	Zone/Area
Windows	108	EA	ARCH_Format...	108			0.00	0.00	
▶ Windows : FE_Fixed : 0610 x 1880mm	55	EA	ARCH_Format...	55	103.40		0.00	0.00	
▶ Windows : FE_Guillotine : 760 x 1565 mm	45	EA	ARCH_Format...	45	70.42		0.00	0.00	
▶ Windows : FE_Imposte : 1830 x 0610 mm	8	EA	ARCH_Format...	8	4.88		0.00	0.00	



# Update Assemble from Excel

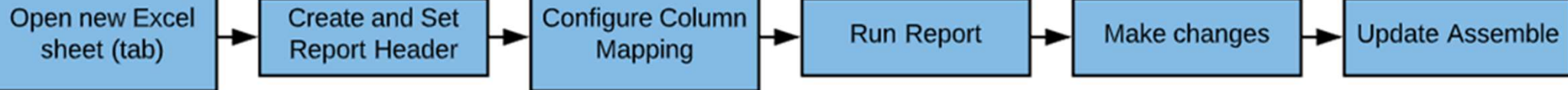

## Tips:

- Unit costs and new Zone/Area data is automatically synced to the Assemble model



Category Name	Level	Quantity	Unit Cost	Sub-Total	Zone/Area
Windows_FE_Fixed	Niveau 2	1	200	200	Hotel
Windows_FE_Guillotine	Niveau 2	1	200	200	Office
Windows_FE_Imposte	Niveau 1	1	300	300	Hotel

Group by: Category ▾										Columns		\$ Estimate	Import/Export ▾
<input type="checkbox"/> Name	Quantity	Unit	Model Name	Count (EA)	Height (M)	Thickness (M)	Unit Cost	Total Cost	Zone/Area				
<input type="checkbox"/> Windows	108	EA	ARCH_Format...	108				22,400.00					
<input type="checkbox"/> ▶ Windows : FE_Fixed : 0610 x 1880mm	55	EA	ARCH_Format...	55	103.40		200.00	11,000.00	Hotel				
<input type="checkbox"/> ▶ Windows : FE_Guillotine : 760 x 1565 mm	45	EA	ARCH_Format...	45	70.42		200.00	9,000.00	Office				
<input type="checkbox"/> ▶ Windows : FE_Imposte : 1830 x 0610 mm	8	EA	ARCH_Format...	8	4.88		300.00	2,400.00	Hotel				

# Recap

WE LEARNED HOW TO :

- CREATE A NEW PROJECT IN ASSEMBLE

It's easy with your Autodesk credentials



- LINK A BIM 360 FILE TO ASSEMBLE

Have better control for technical review.



- REORGANIZE DATA PER BUDGET COST CODES

Separate the model objects in easy to digest views



- COMPLETE A COST ESTIMATE ANALYSIS

Use Class Editor, Power BI and the Excel add-ins to gain flexibility in budget analysis and presentation



## Q & A

- RAISE YOUR HAND
- USE THE APP

**[meet.ps/au](https://meet.ps/au)**



# RAFFLE

Please login to participate! **meet.ps/au**



# AUTODESK<sup>®</sup>

## Make anything<sup>™</sup>

Autodesk and the Autodesk logo are registered trademarks or trademarks of Autodesk, Inc., and/or its subsidiaries and/or affiliates in the USA and/or other countries. All other brand names, product names, or trademarks belong to their respective holders. Autodesk reserves the right to alter product and services offerings, and specifications and pricing at any time without notice, and is not responsible for typographical or graphical errors that may appear in this document.

© 2019 Autodesk. All rights reserved.

