

AUTODESK UNIVERSITY

CES500136 - Leveraging data driven decisions utilising Autodesk Construction Cloud

Mark Danaher

Technical Services Manager
Kirby Engineering & Construction

Caroline Shaw

ACS Customer Success Manager
Autodesk

Your Speakers Today!



Mark Danaher

Technical Services Manager,
Kirby Engineering &
Construction



Caroline Shaw

Customer Success Manager,
Autodesk



The Cost of a Fragmented Industry



TEAMS

35%

of **time is wasted** on non-optimal activities
(14+ hours/person/week)

Source: Construction Disconnected – FMI Report

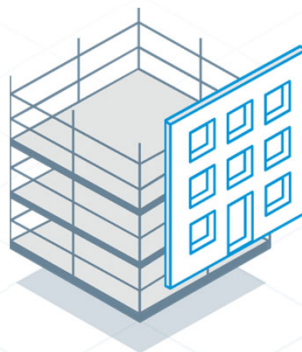

PROJECTS

\$280B

industry annual **rework costs**
caused by poor project data
and communication

Source: Construction Disconnected – FMI Report



BUSINESS

95.5%

of all **data goes unused** in
engineering & construction

Source: Big Data = Big Questions for the
Engineering and Construction Industry – FMI
Report

Kirby before our digital journey



- Kirby utilised paper-based approach to documentation
- Traditional on-site building principals
- Slow release of data from design to site
- Change management was not streamlined
- Real time information was not available, resulting in reactive rather proactive decision making



Hyperscale Data Centre

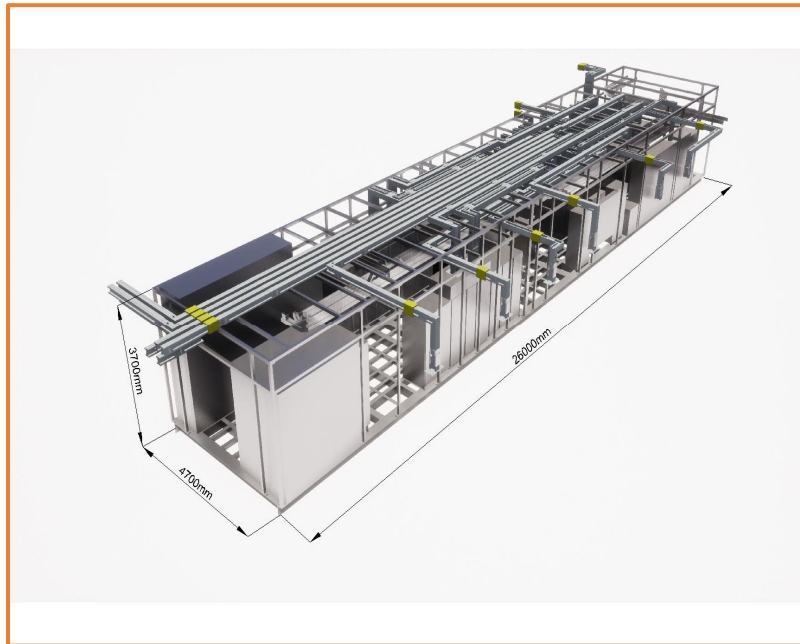

Hyperscale Data Centre

- Centralised our BIM data with a live feed of information directly to site
- Delivered an OSM approach to the project – information from design, site and OSM facility shared centrally
- Digitised our redlining process allowing for live feedback from site
- Introduced digital EHS & QC checklists



Digital Operations

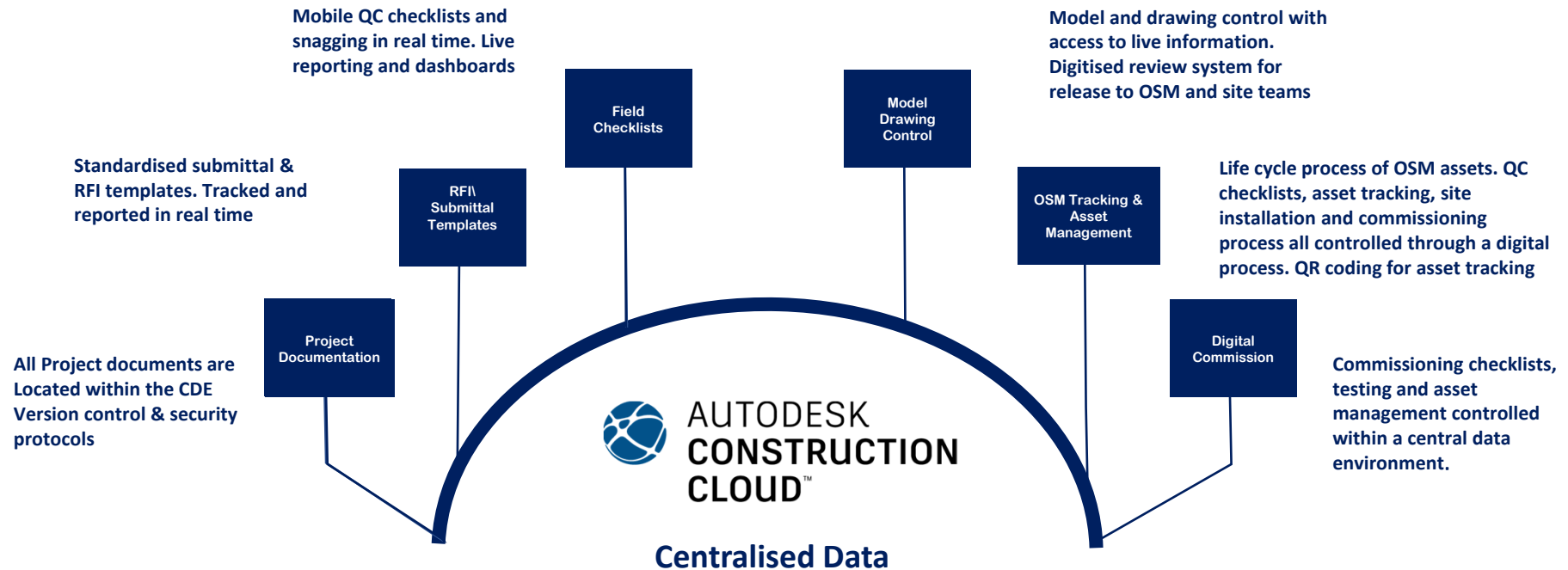

Big Data

- Documents and templates standardized to allow for better quality data
- Quality control checklists captured in real time and live reporting
- Full project document control through Autodesk Construction Cloud
- Technical submittals and RFIs completed within the software
- Offsite module QC and progress tracked and reported
- Commissioning through a digital process

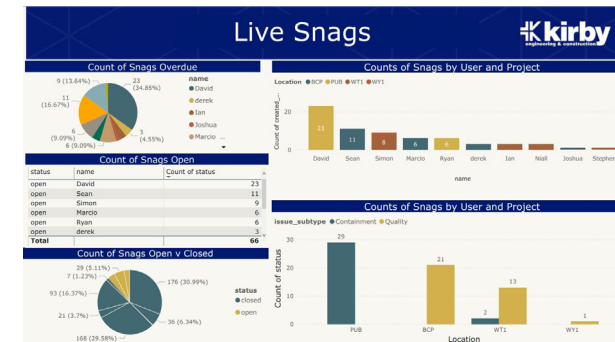
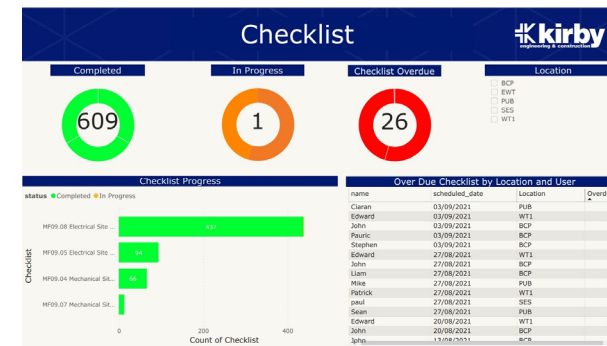

Metrics & Lessons Learned



Digital Snagging



Commissioning



Digital QC Audits

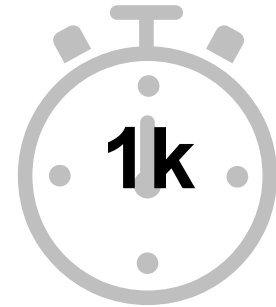

Digital Redlining

Autodesk Construction Cloud Implementation Plan

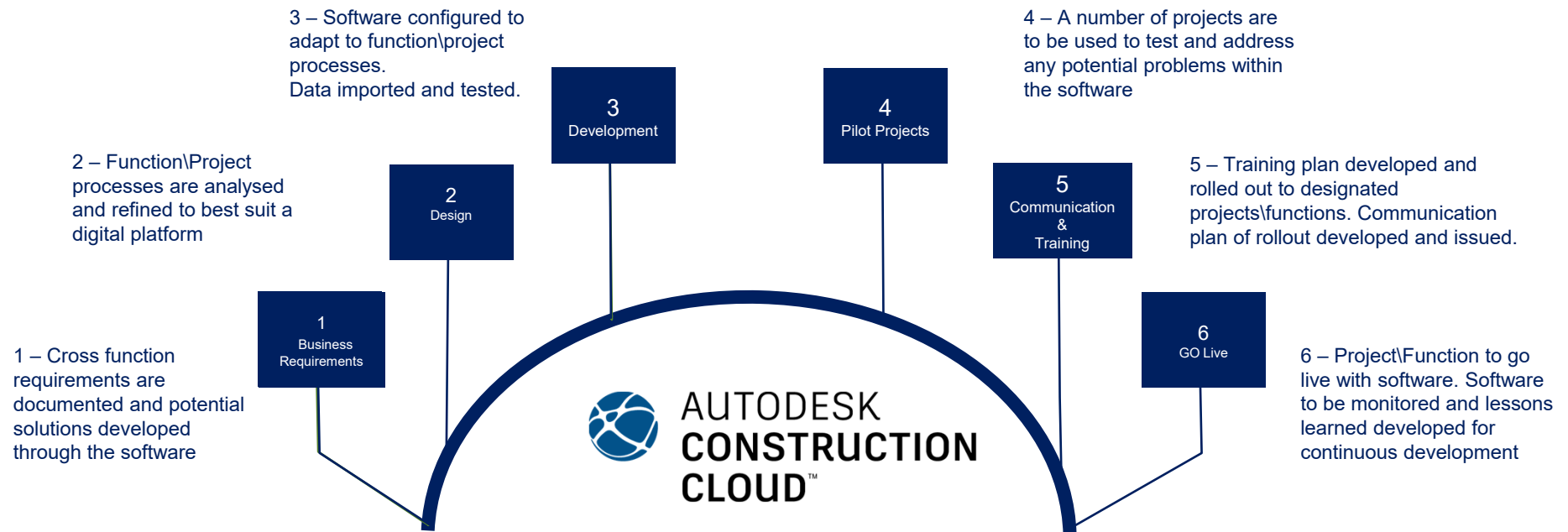



	DESIGN	PLAN		BUILD				OPERATE
Capabilities	Design Collaboration	Coordination	Quantification	Project Management	Cost Management	Quality	Safety	Project Closeout
Workflows	<ul style="list-style-type: none">Constructability ReviewChange VisualizationRevit Cloud WorksharingCollaboration for Civil 3D / Plant 3D	<ul style="list-style-type: none">Model CoordinationConstructability Review	<ul style="list-style-type: none">Scope Analysis2D/3D Takeoff	<ul style="list-style-type: none">RFIsSubmittalsMeeting MinutesDaily Reports	<ul style="list-style-type: none">Contract Creation / AdministrationChange OrdersPayment ApplicationsForecasting	<ul style="list-style-type: none">Quality PlanningQuality CheckingPunchlistsIssue Management	<ul style="list-style-type: none">Safety PlanningSafety TrainingSafety ObservationsSafety Inspections	<ul style="list-style-type: none">CommissioningTurnover DocumentationFinal CompletionAs-Built Survey
	Document Management							
Unified Data		Models · Drawings · Documents · Cost Items · Assets · As-Built's · Photos · Videos						
Insight		Dashboards · Reports · Construction IQ · Data Connector						
Admin		Admin Console · Permissions · Project Setup · Templates · Notifications						



The background of the image is black. In the center, the words "AUTODESK" and "UNIVERSITY" are written in a bold, white, sans-serif font. The text is arranged in two lines, with "AUTODESK" on top and "UNIVERSITY" below it. Surrounding the text are four dark, metallic-looking geometric shapes that resemble stylized computer monitors or tablets. These shapes are positioned at the corners of the frame: top-left, top-right, bottom-left, and bottom-right. They are angled towards the center, creating a sense of depth and perspective. The lighting on these shapes is subtle, highlighting their edges and giving them a three-dimensional appearance.

AUTODESK UNIVERSITY