

The background of the slide is a complex, light gray wireframe mesh that forms an abstract, organic shape with several large, irregular holes. A solid blue horizontal band is positioned across the middle of the image, serving as a backdrop for the title and speaker information.

# Multiaxis Large-Scale AM with Netfabb and Powermill High-Rate Technology

Dominique Mueller  
Senior Research Engineer

Join the conversation #AU2017



# AGENDA

- **Large Scale Additive Manufacturing**
  - Architecture & Construction
  - Manufacturing & Engineering
- **System configuration**
  - Understand your system and materials
  - Understand your application and requirements
- **Software tools**
  - Autodesk Netfabb
  - Autodesk Powermill
  - Autodesk Dynamo
- **Q & A**







# Large Scale Additive Manufacturing

What means  
large scale additive  
manufacturing?





TU Eindhoven and Rohaco company, Netherlands



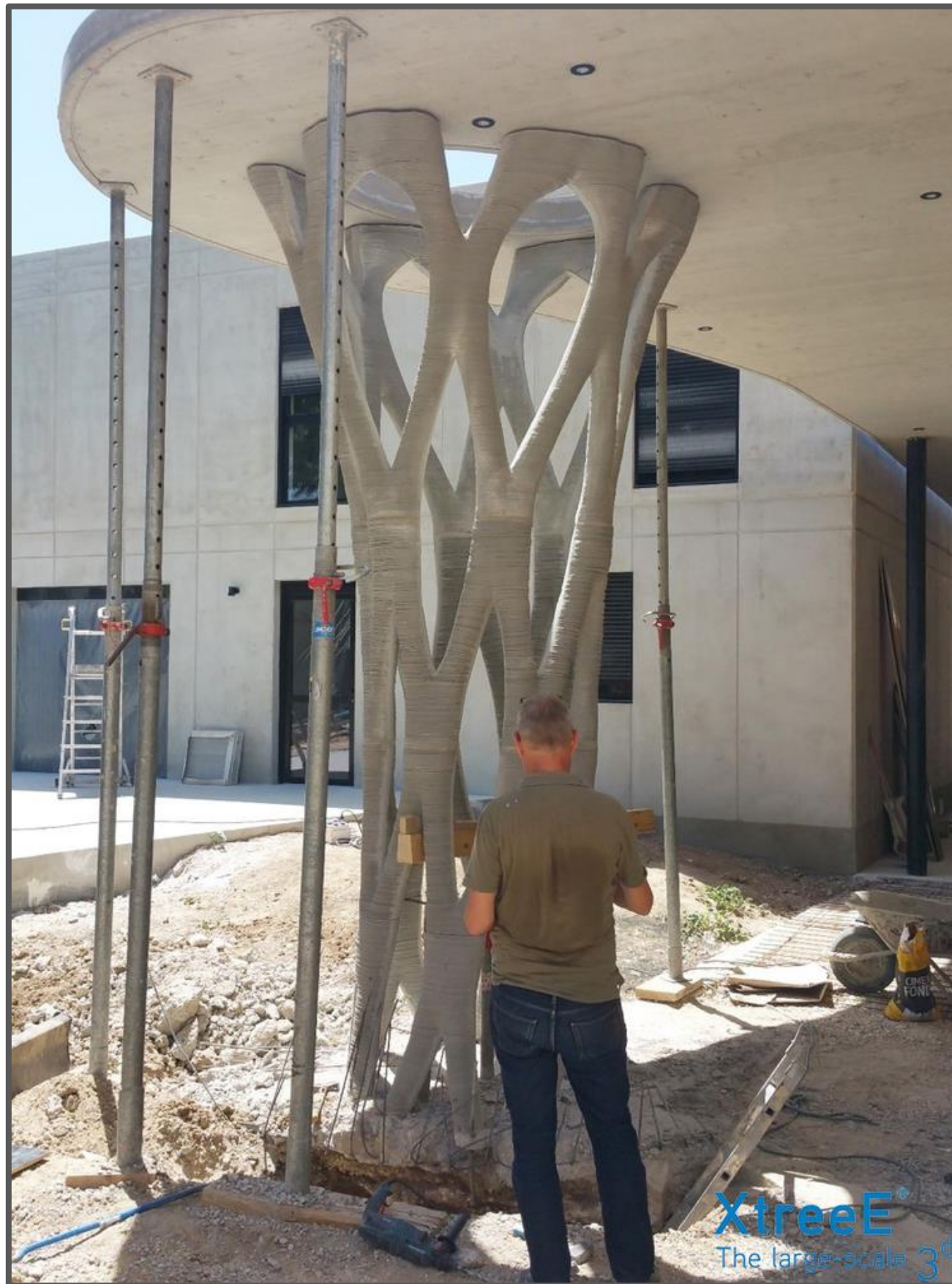





FloandJet by Branch Technology



Knoxville Bureau of Air and Space by Branch Technology





Gramazio and Kohler, ETH Zurich

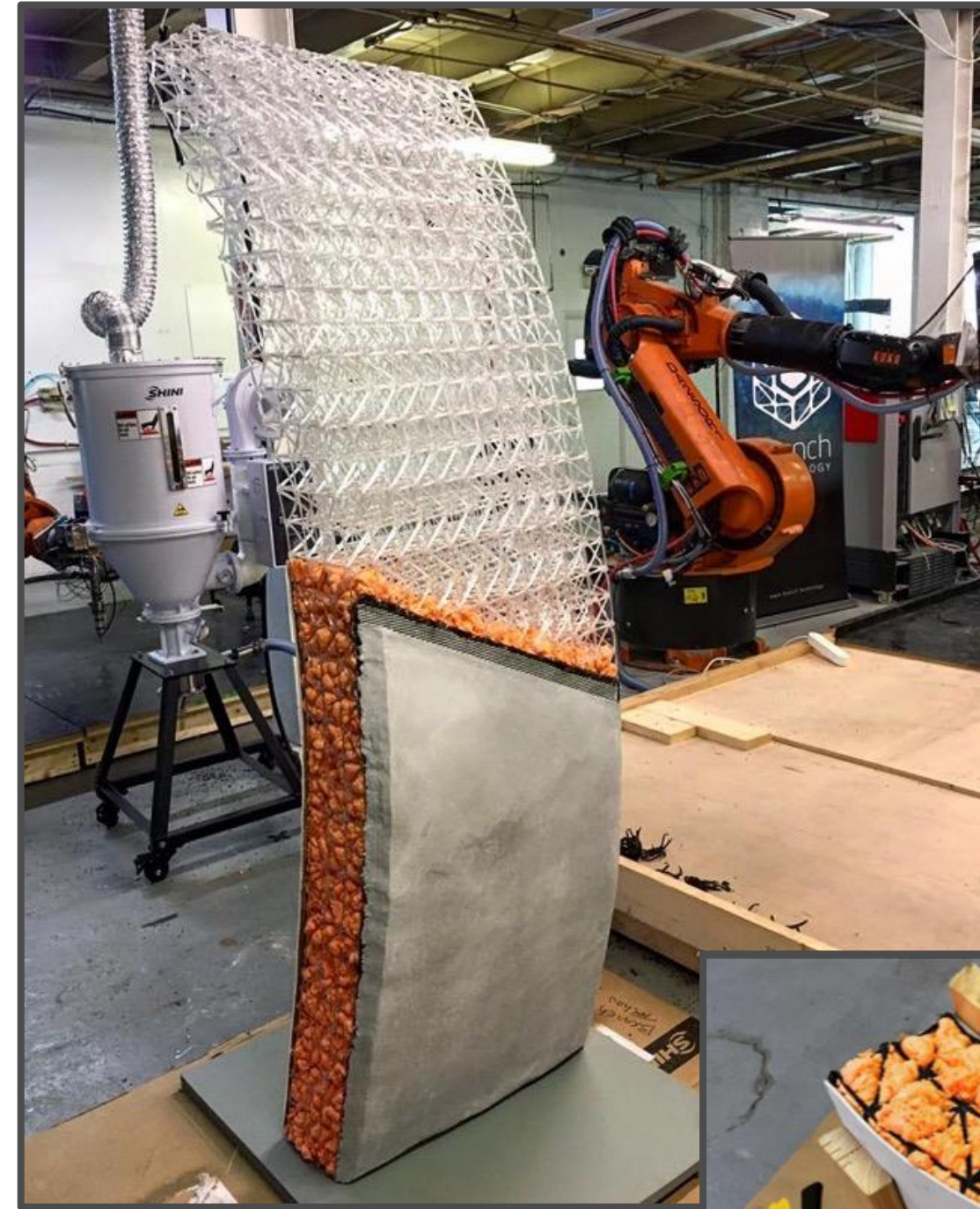

Branch Technology (USA)

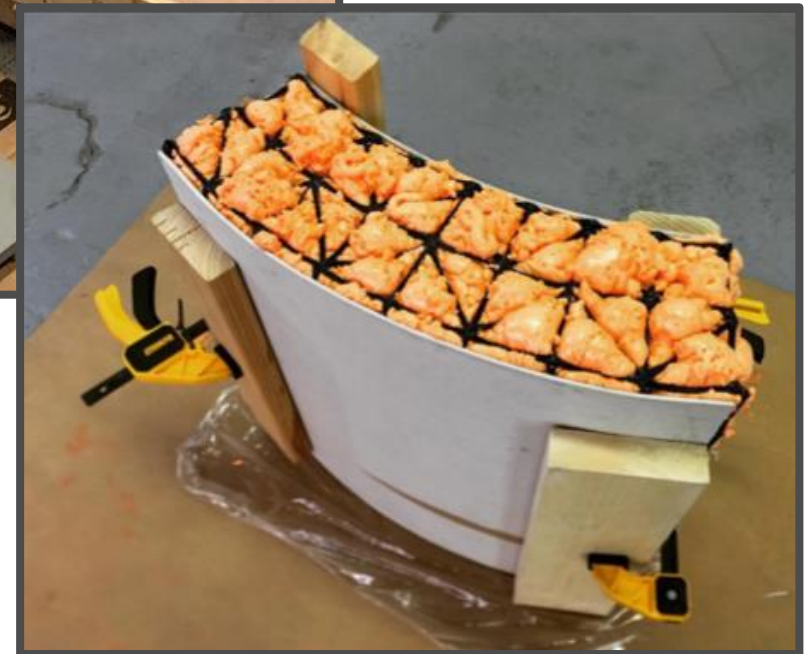



# Dubai 3D Printing Strategy

- 300 billion dollar market by 2025
- 25% of all of Dubai's new construction to be 3D printed by the year 2025
- 1.7 billion expected medical products market in Dubai by 2025
- 2.8 billion expected consumer products market in Dubai by 2025









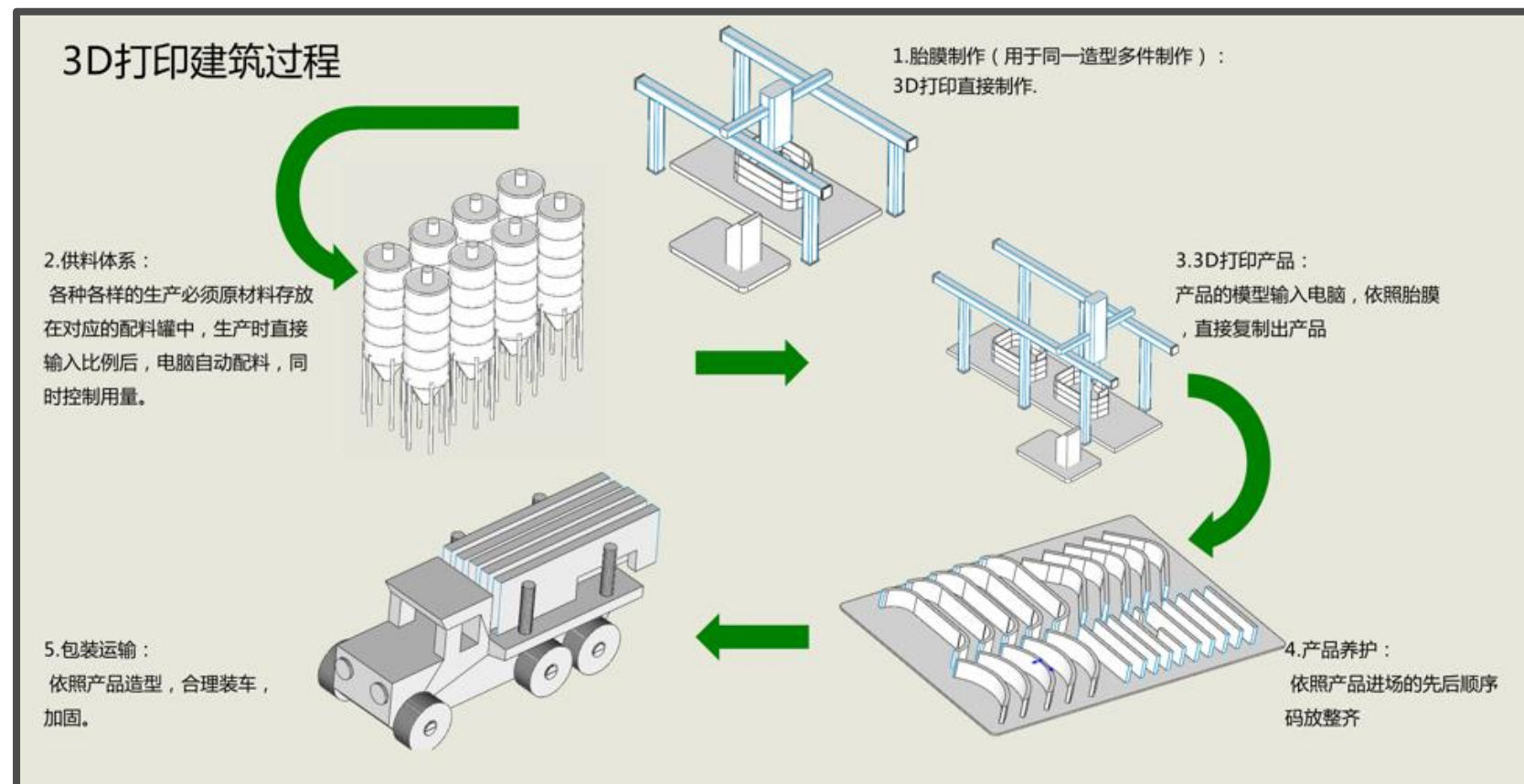

WinSun Decoration Design Engineering Co, China  
<http://www.yhbm.com/index.php?siteid=3>





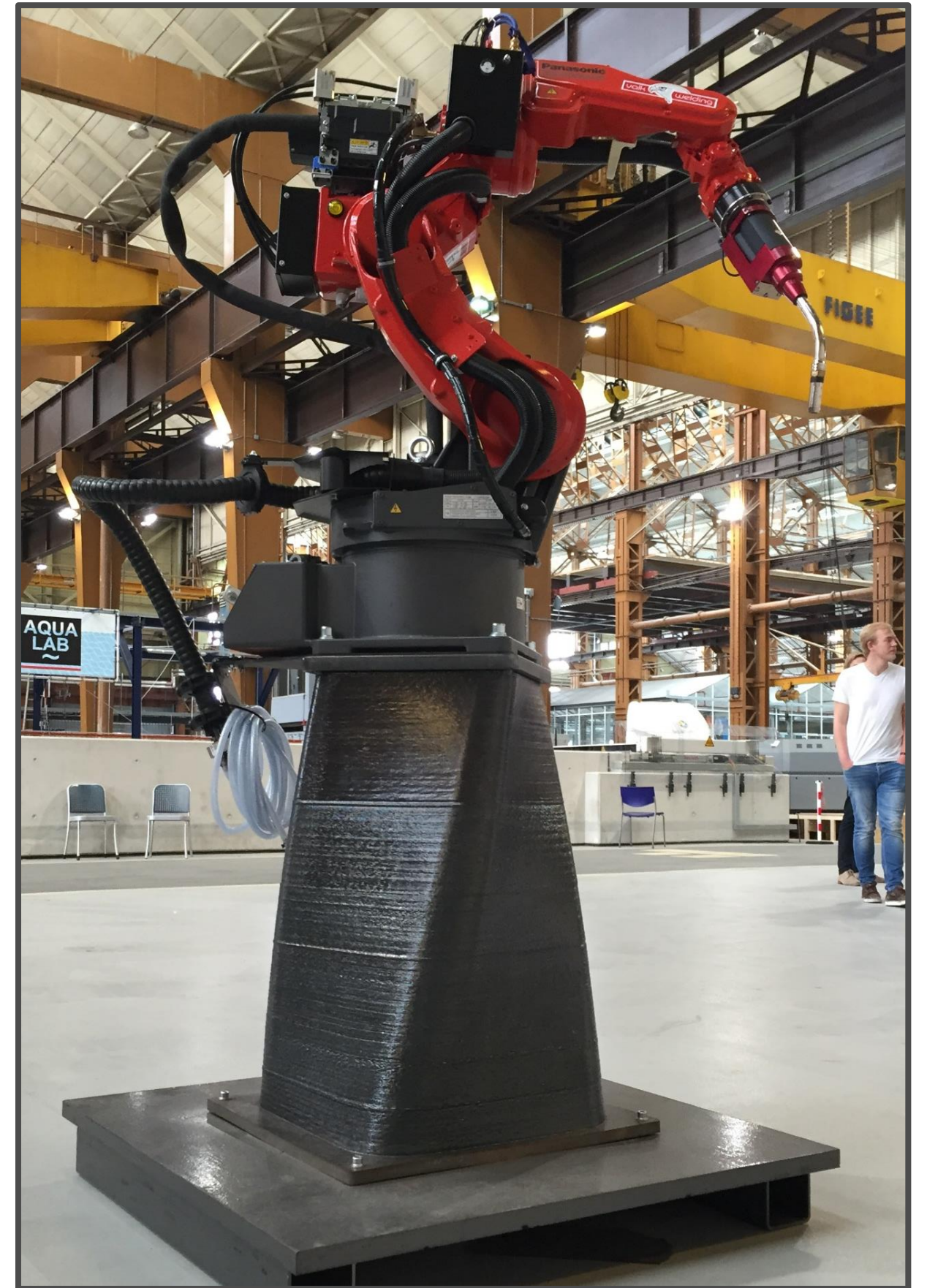
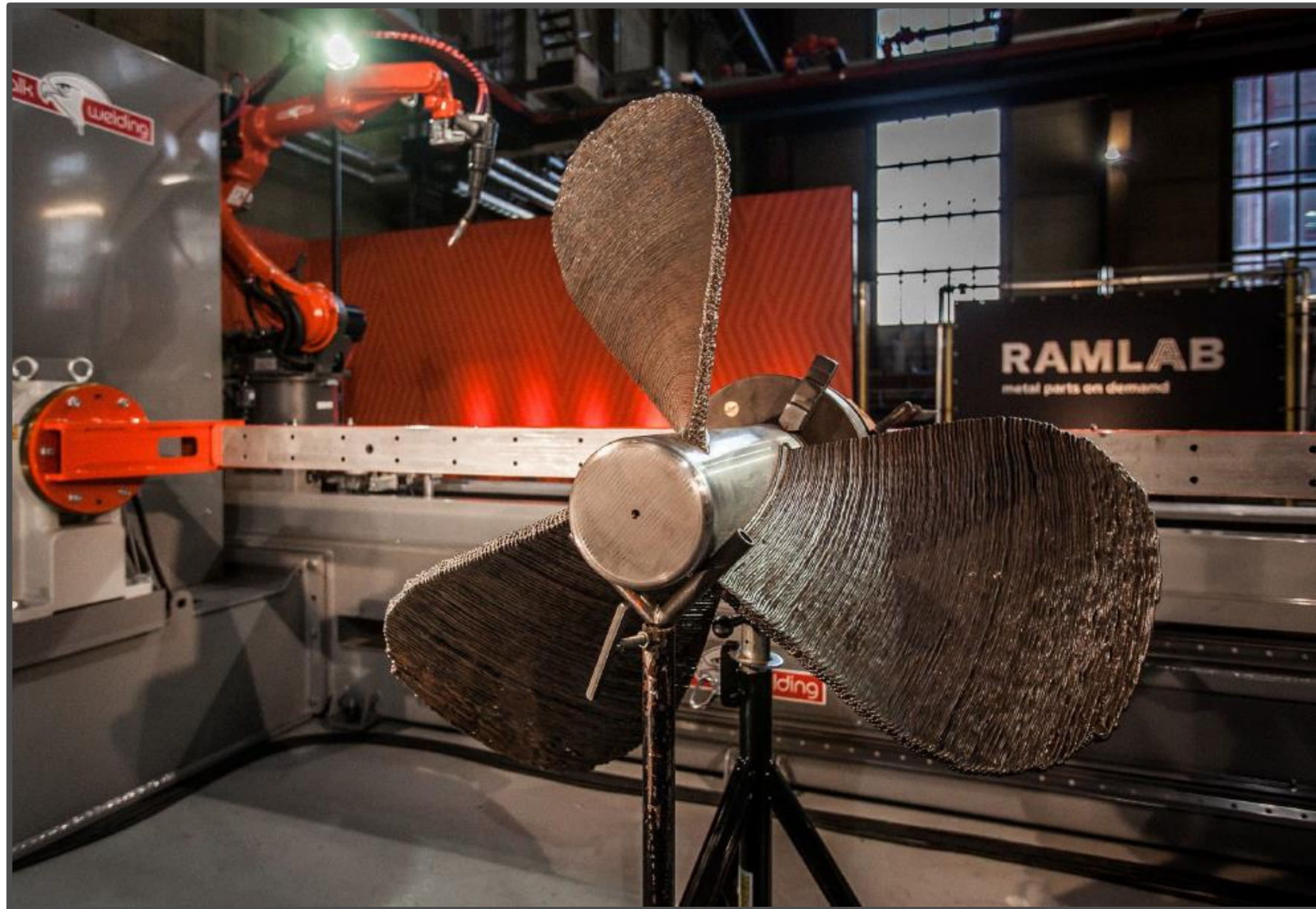



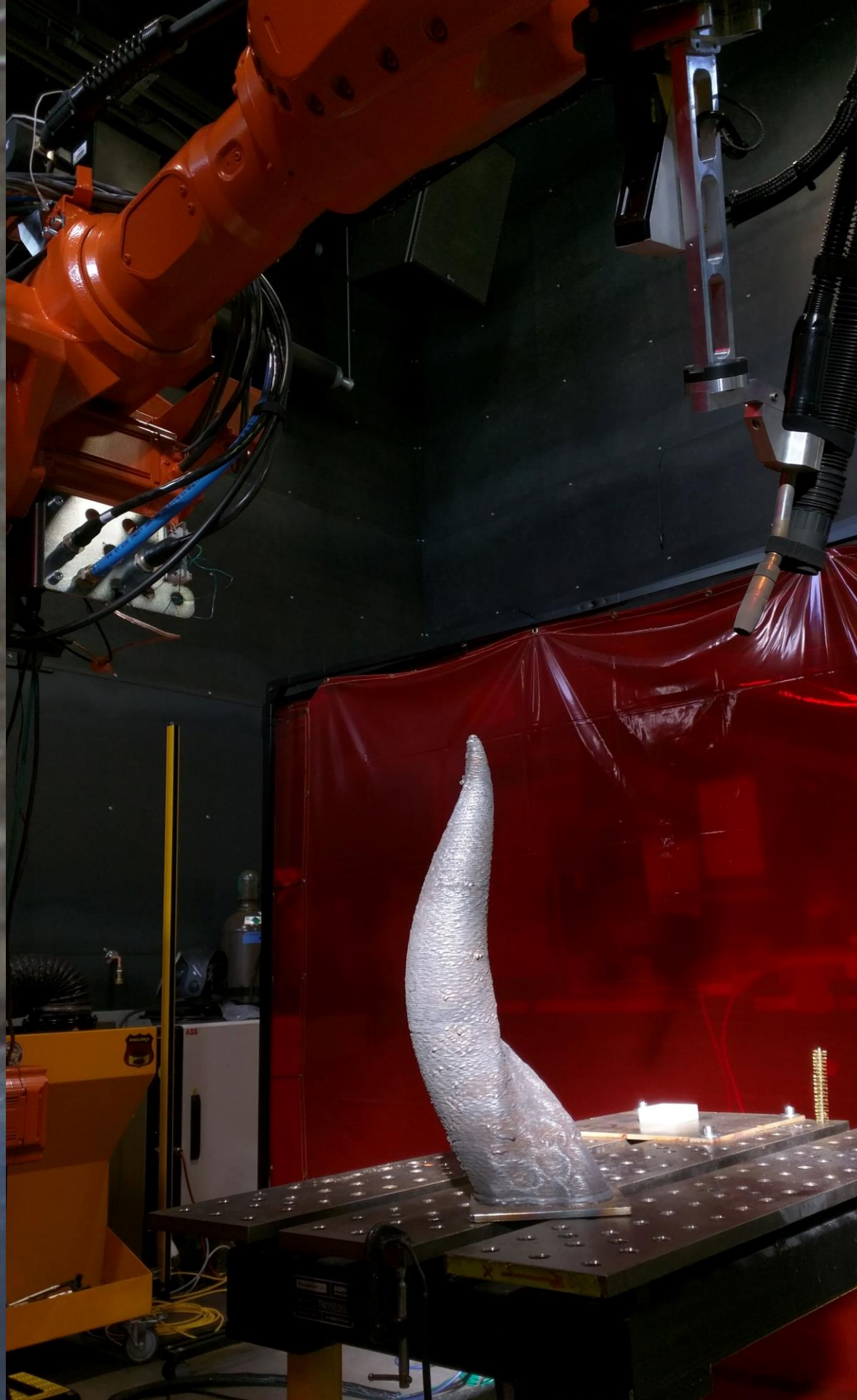







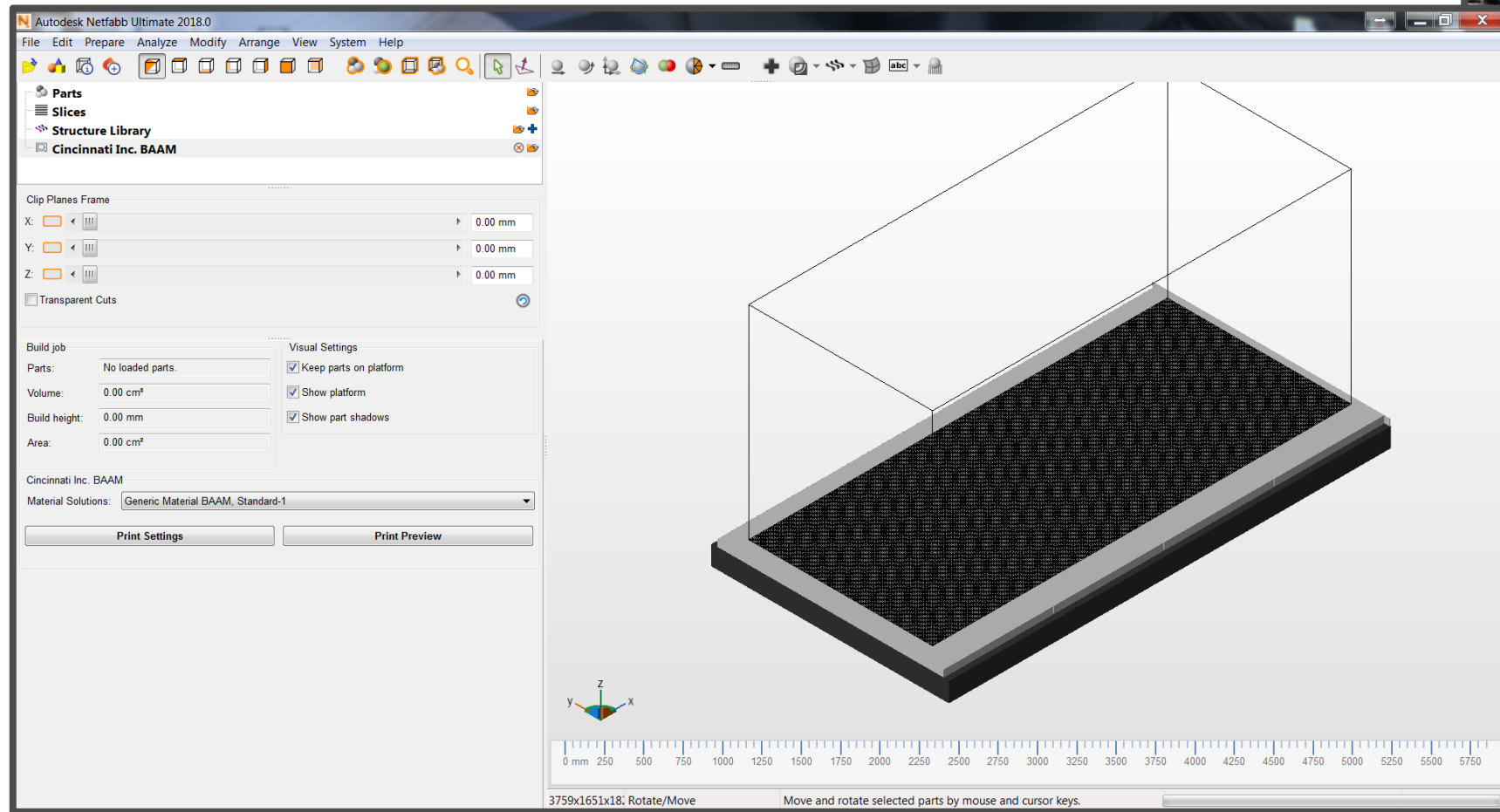
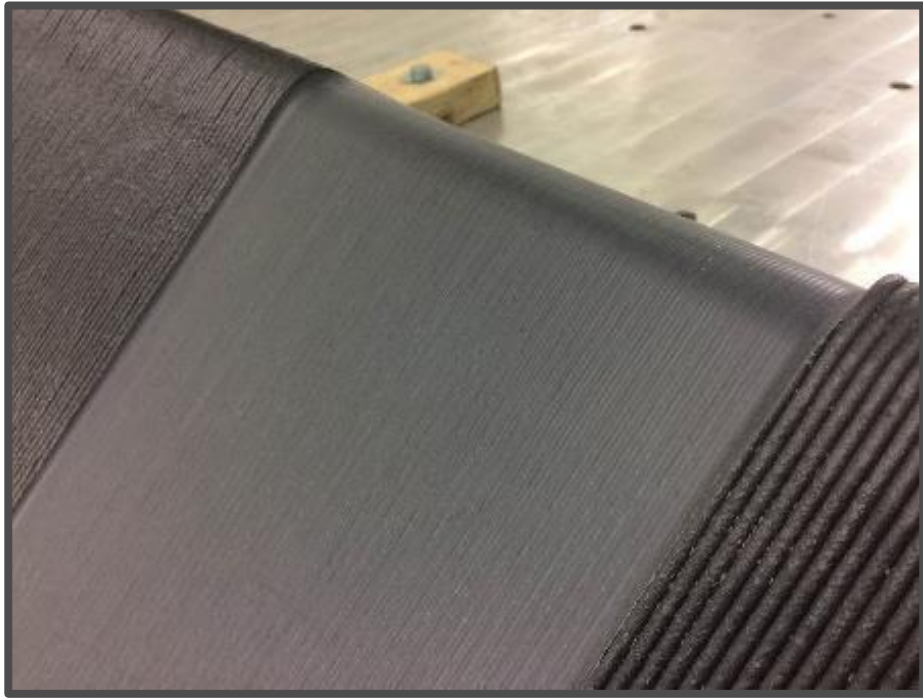



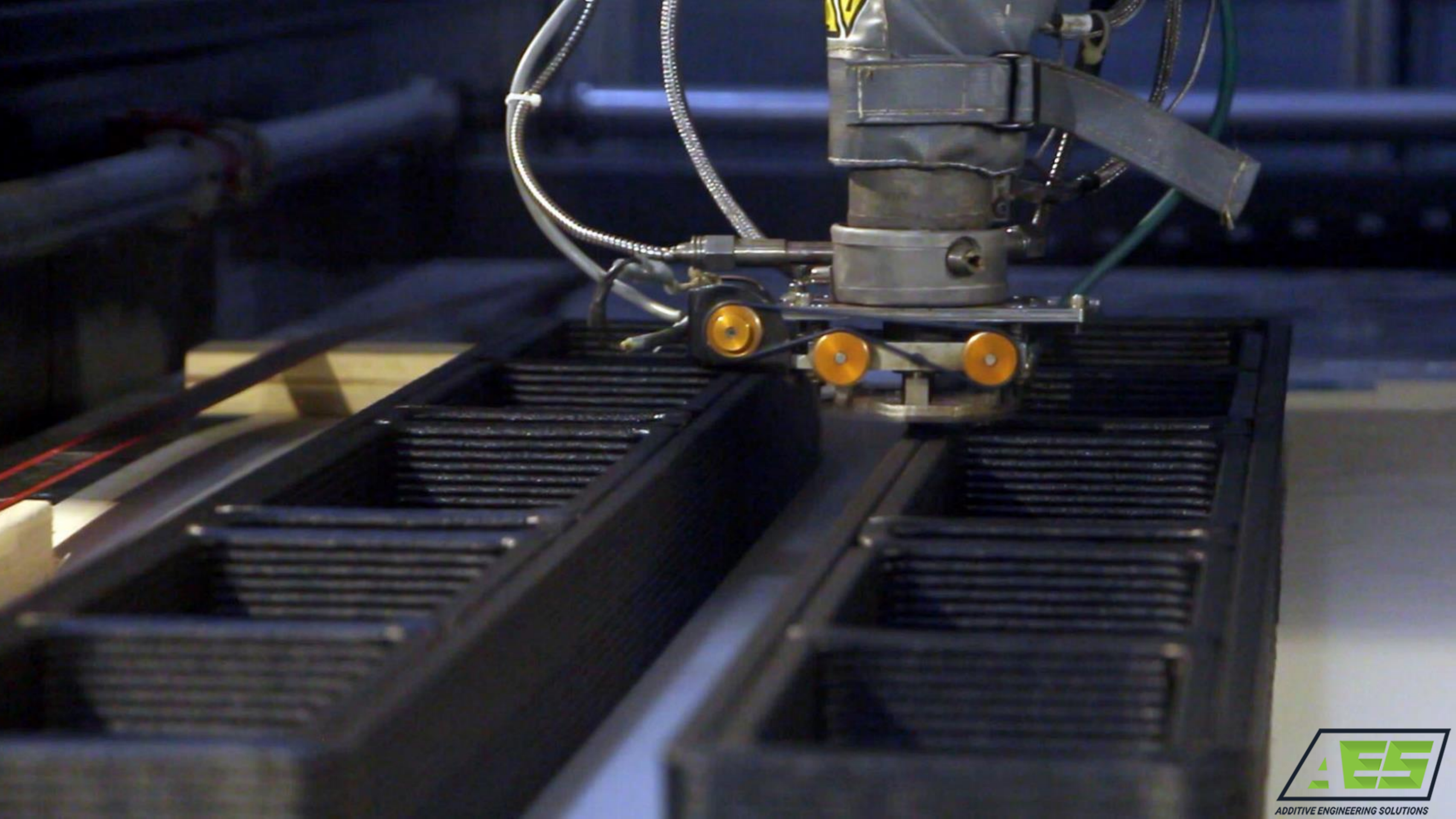



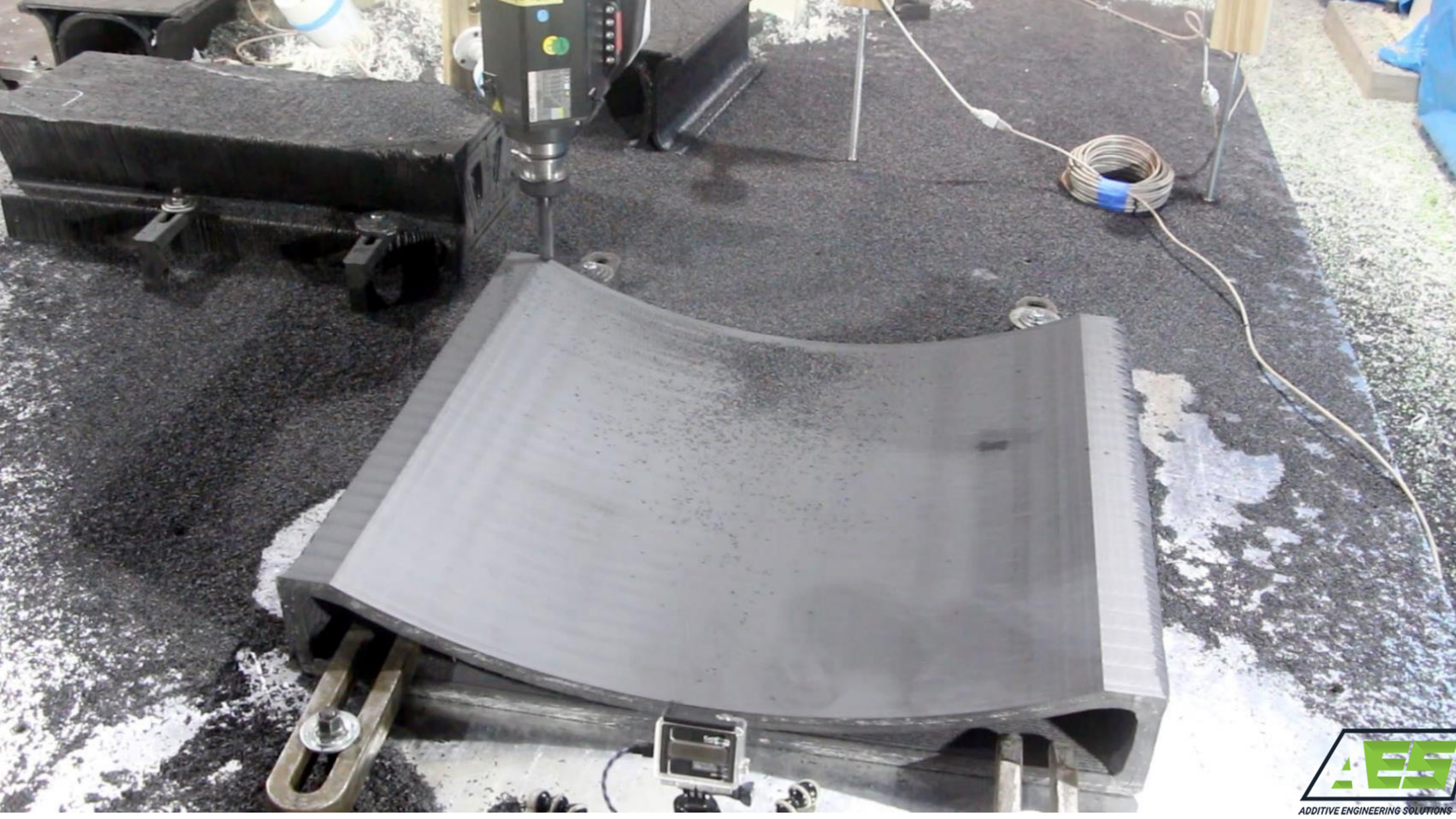



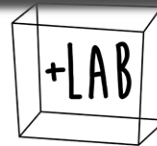

**POLITECNICO**  
MILANO 1863



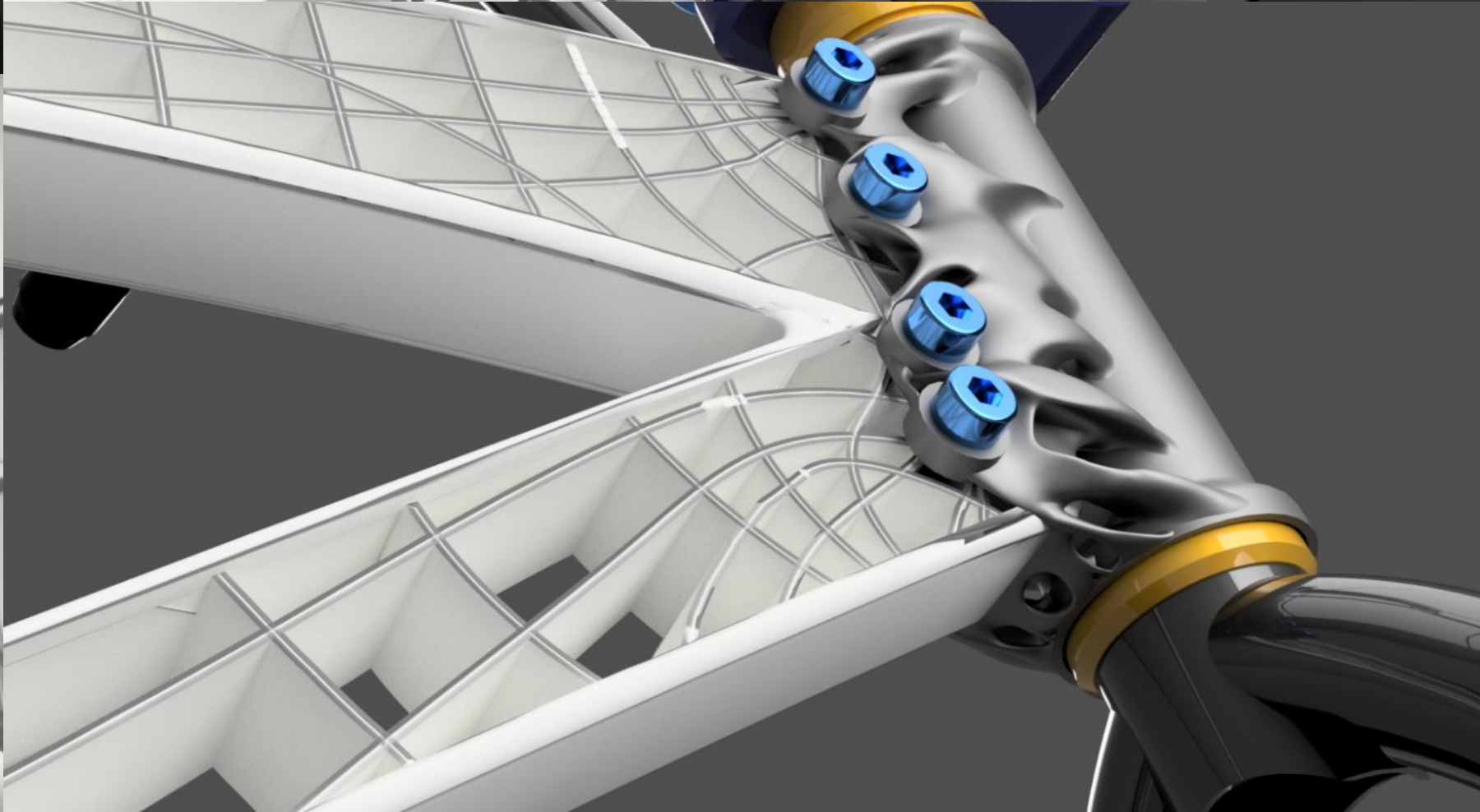
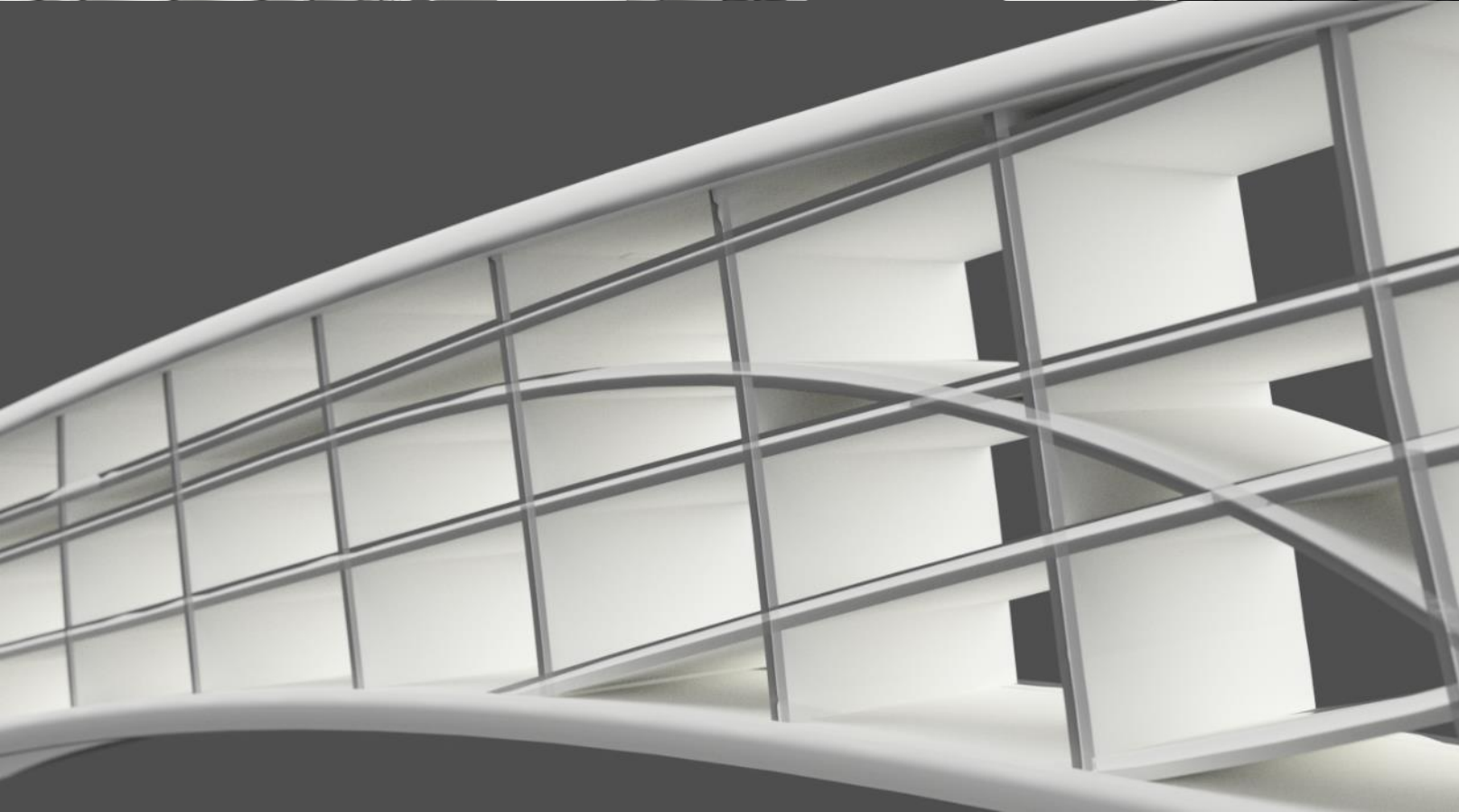
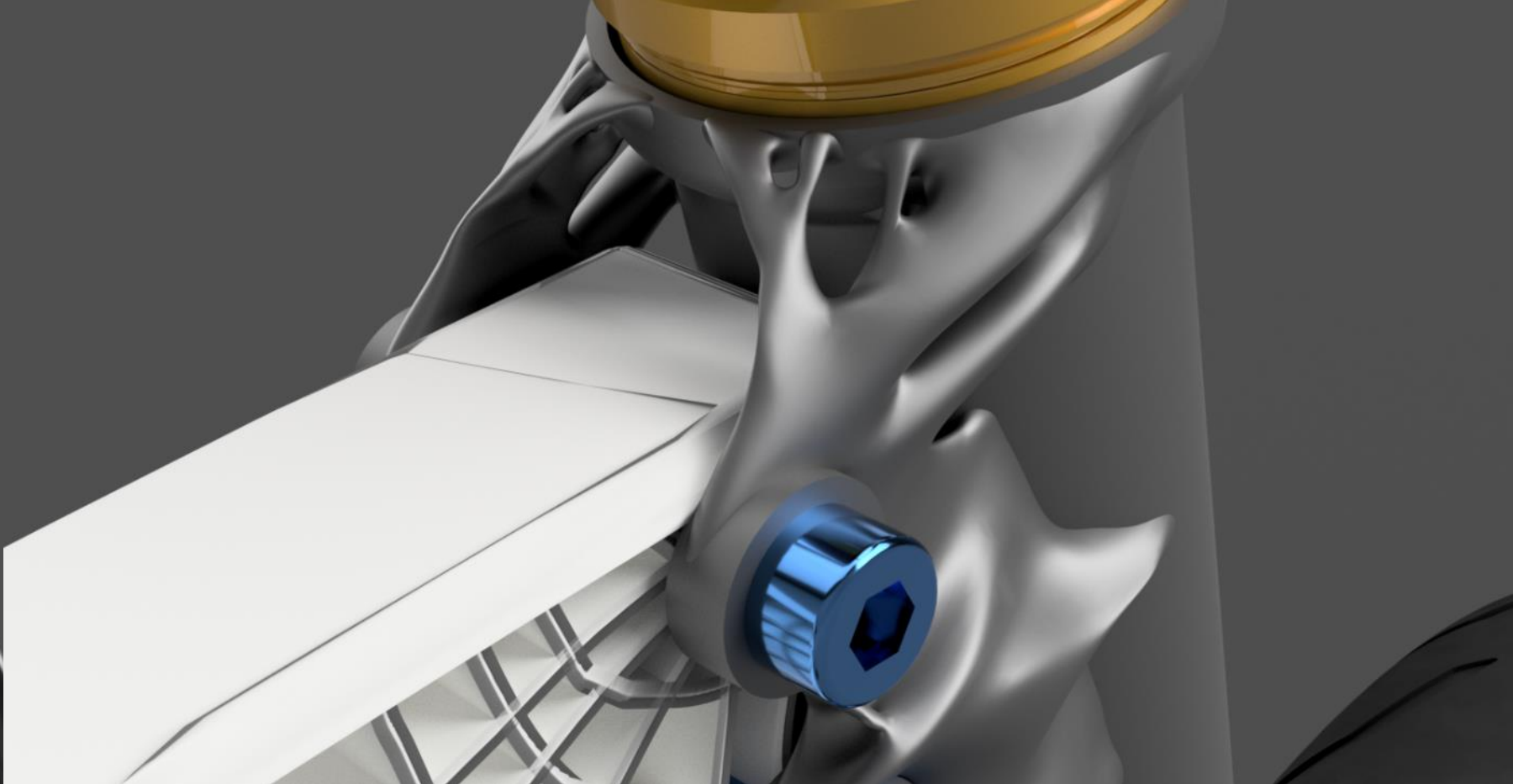
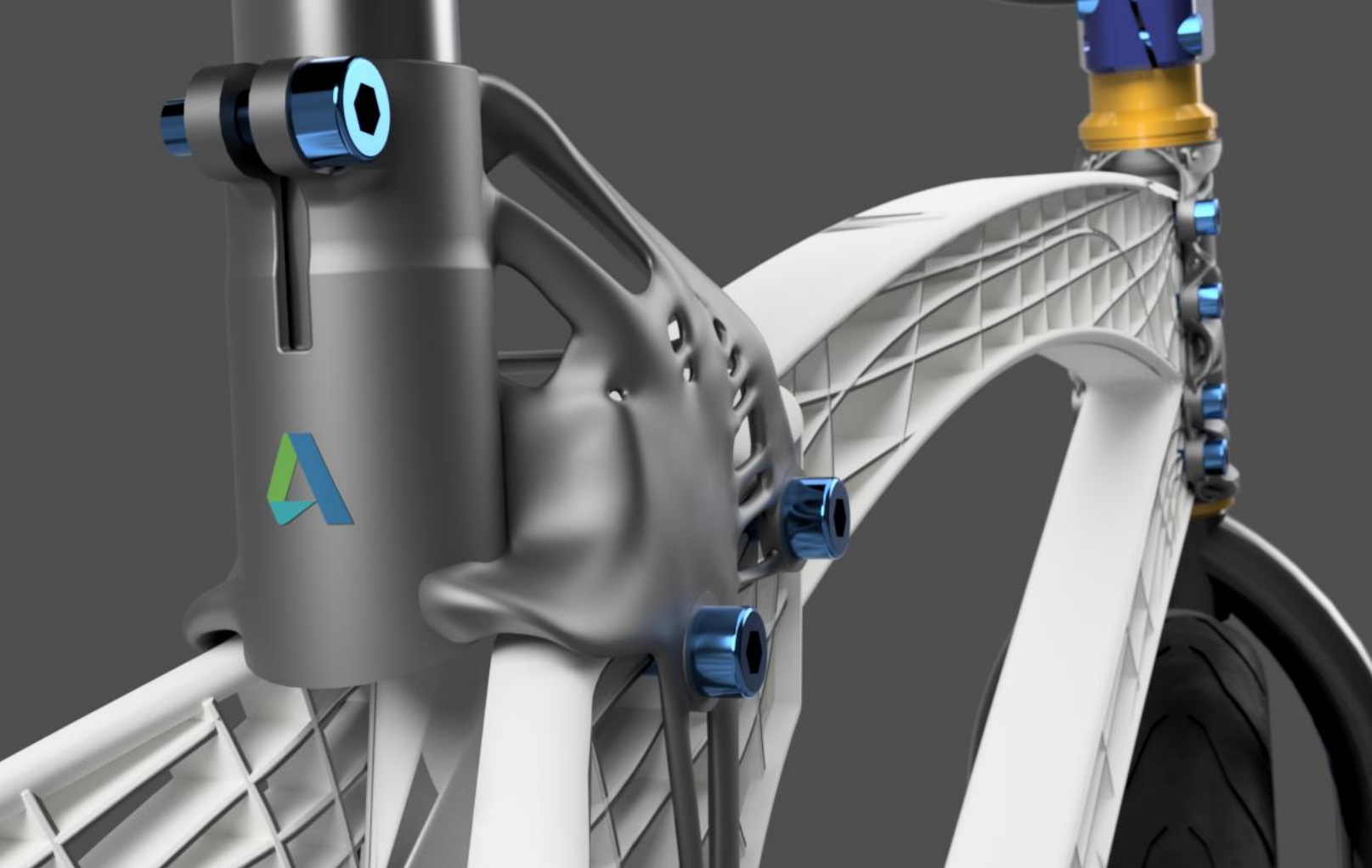







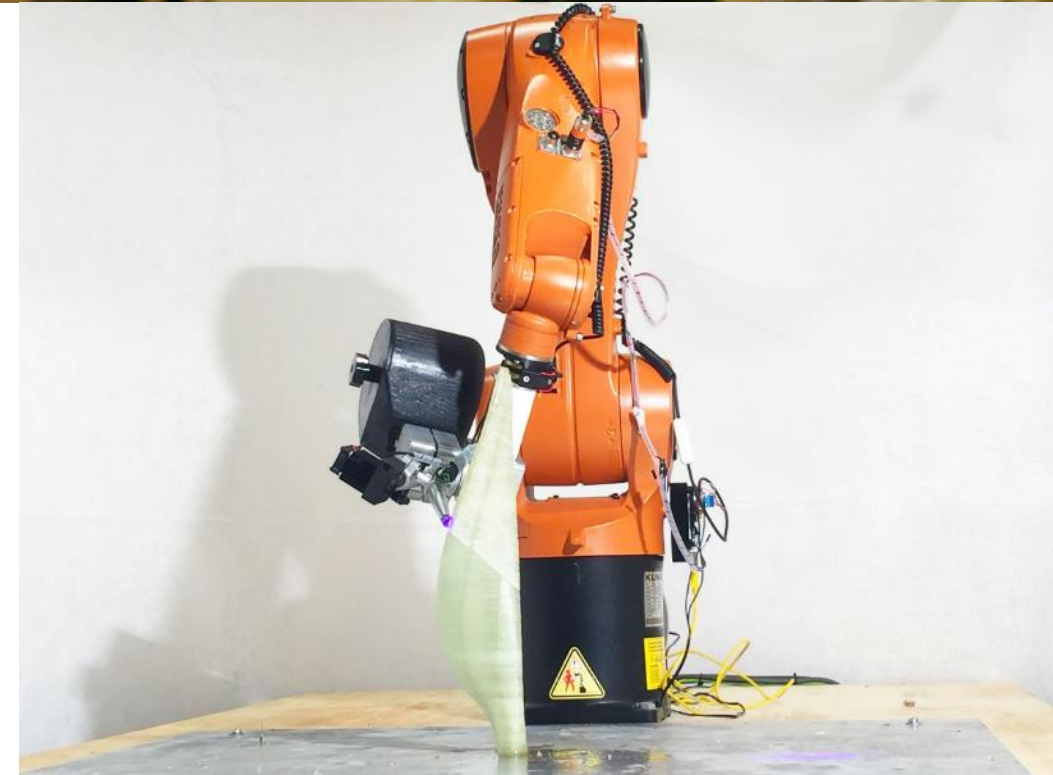
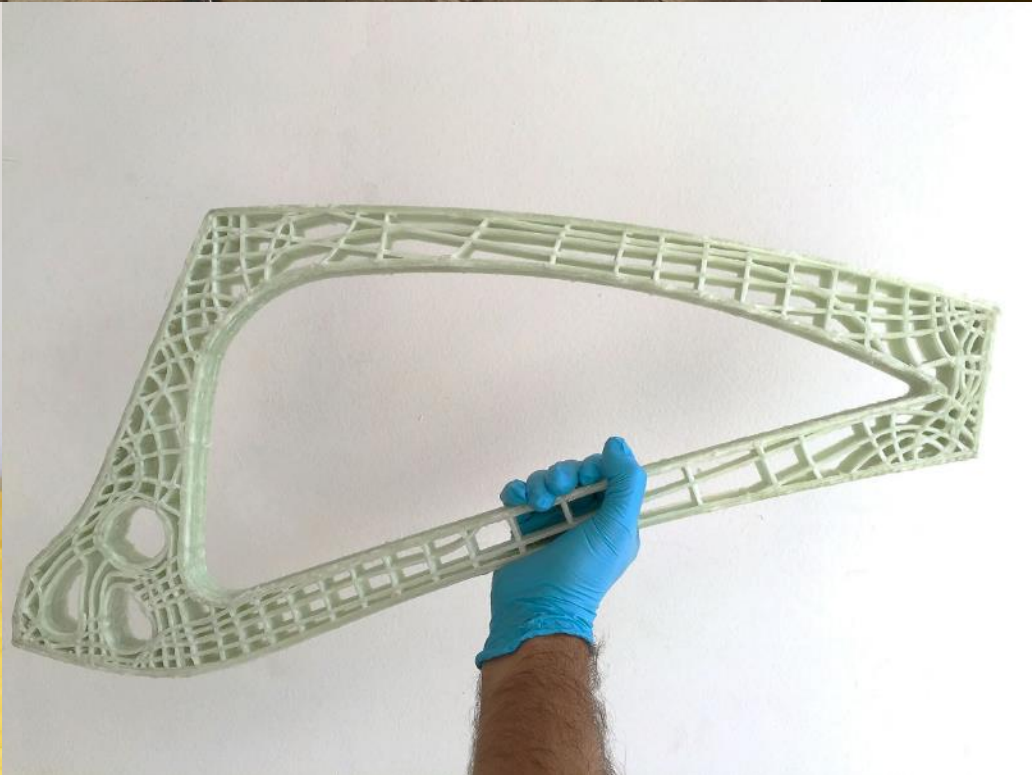
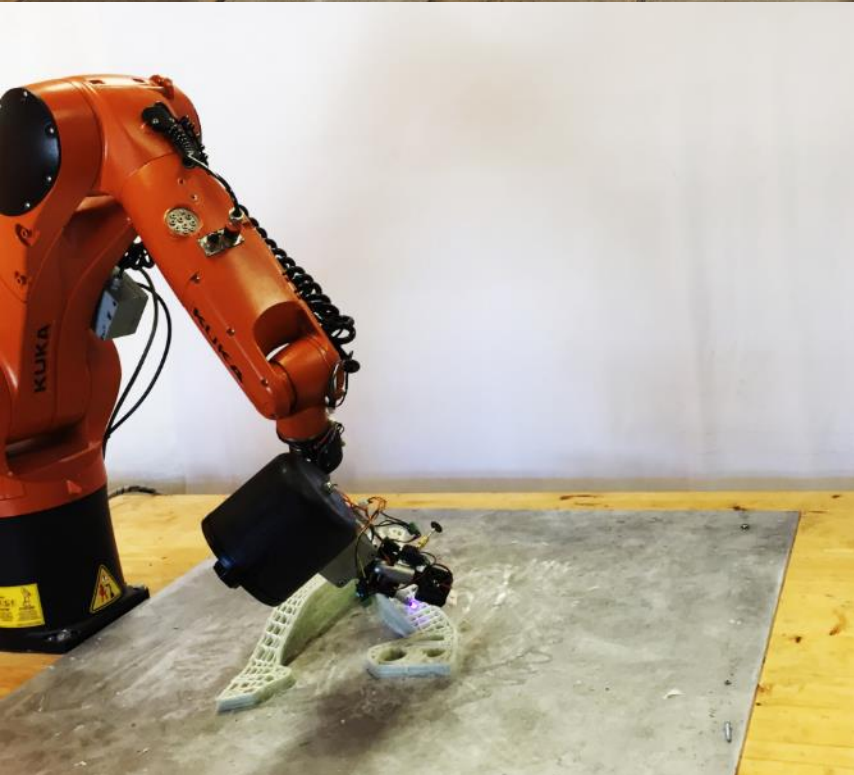





System configuration



# Understand your application and requirements

- Architecture

- Aerospace

- Automotive industry

- Marine industry

- Biology

- Medicine

- ...

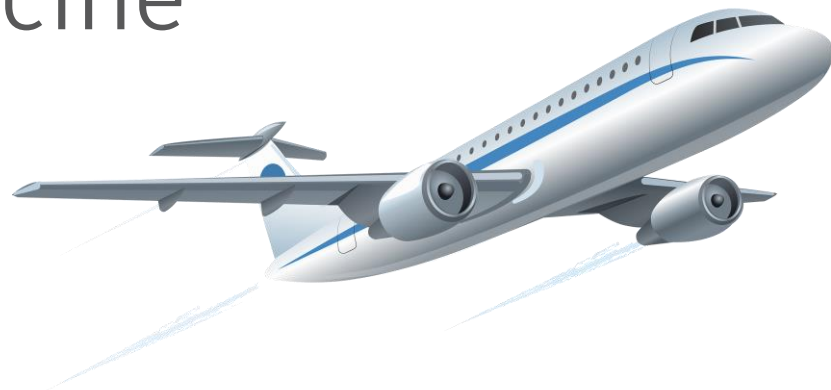

- Costs

- Weight

- Stiffness

- Temperature

- Water residence

- Design

- ...

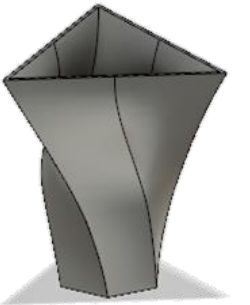
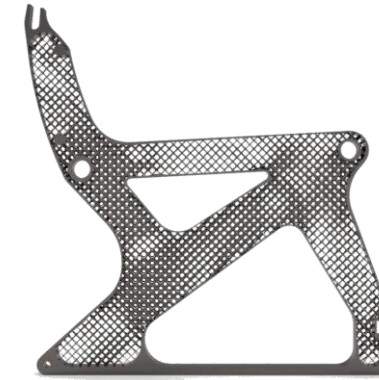



# Understand your system and materials

- Robot
- Hybrid
- Gantry
- Laser
- Extruder
- Arc
- ...

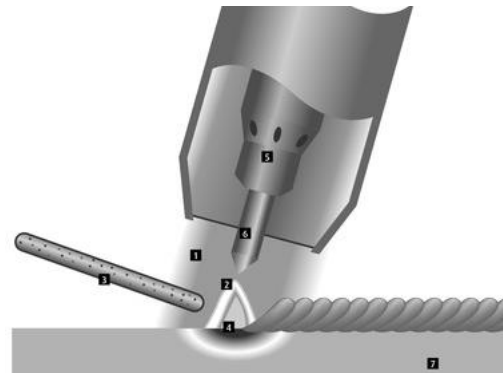

- Metal
- Polymer
- Concrete
- Composite
- Multi material
- ...





The background features a blue gradient bar at the bottom, transitioning from a darker blue on the left to a lighter blue on the right. Overlaid on this is a complex, light gray wireframe mesh pattern that forms a series of interconnected, flowing, and somewhat chaotic shapes, resembling a stylized, abstract landscape or a network of paths.

Software tools





**Parts**

**Parts (KUKA KR900)**

- (100%) 2 (repaired)

**Slices**

- Perimetro Esterno
- Bottom
- Infill
- Top

**Structure Library**

## Clip Planes Frame

X:  < >Y:  < >Z:  < >☐ Transparent Cuts

## Cuts

&lt;cutting disabled&gt;

## Information

Length:  Volume: Width:  Area: Height:  Triangles: 

1 of 1 part is selected.

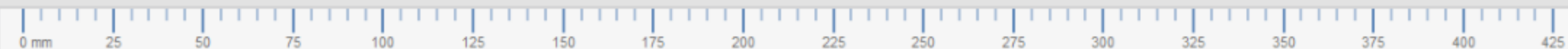
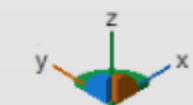

750x225x800

Rotate/Move

Move and rotate selected parts by mouse and cursor keys.

[ 16:49:44 ] Unable to open file "C:\Users\Michele\AppData\Local\Temp\netfabb.log"

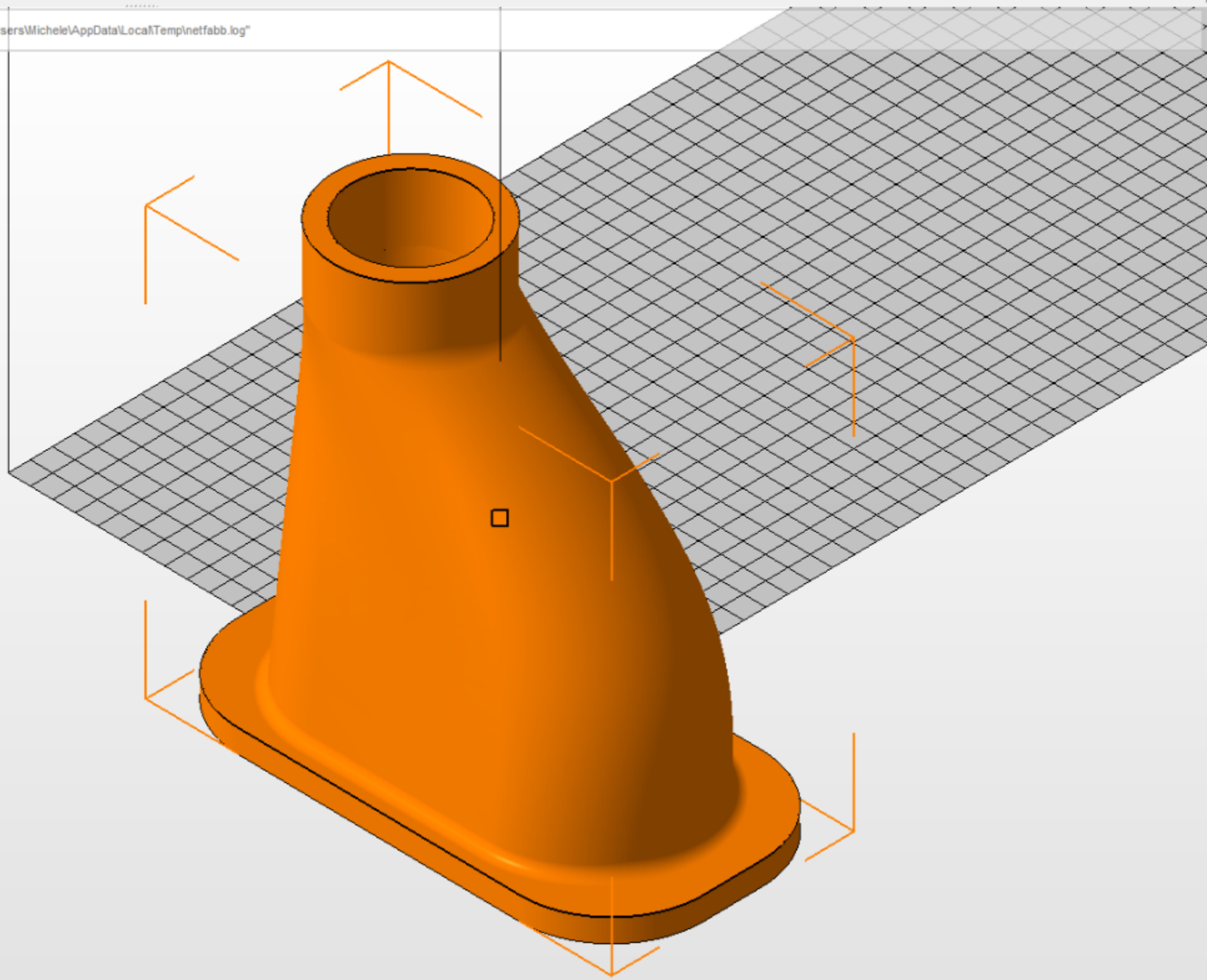



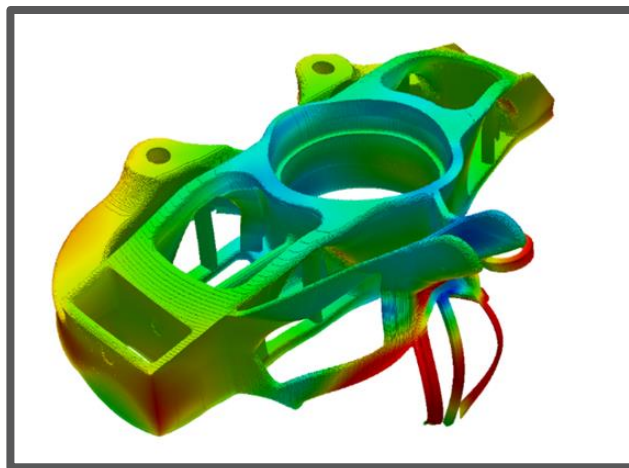

## Additive Process Simulation

State of the art Simulation technologies for Metal Powder Bed Sintering and Direct Energy Deposition

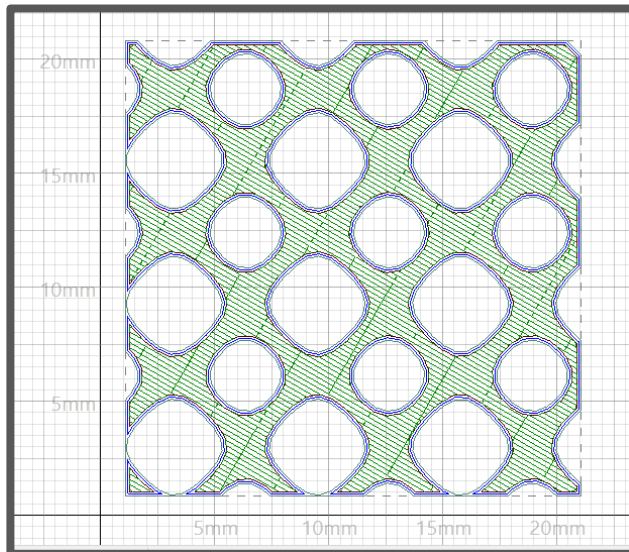

## Advanced Toolpathing

Toolpath strategy development tools for laser sintering and deposition modeling.

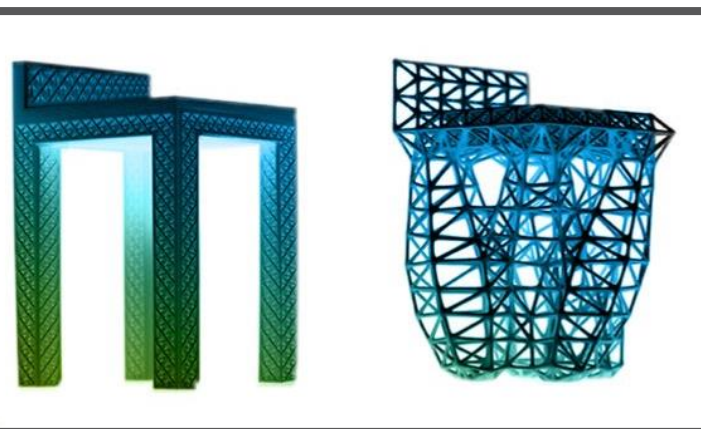

## Generative Design

Multi-variate generative synthesis of geometry based on design goals.

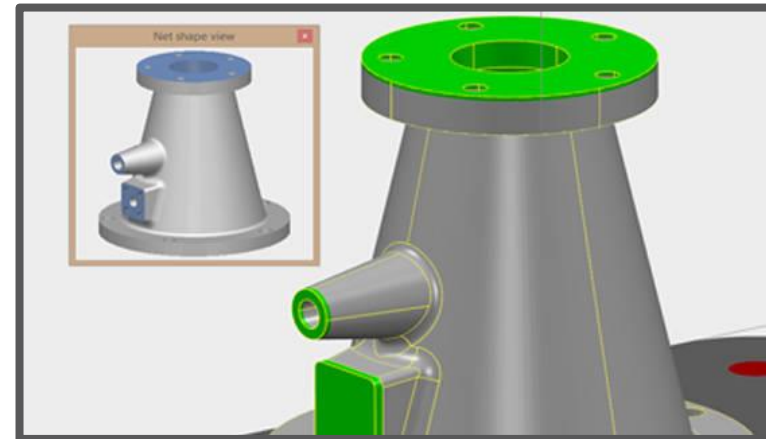

## Hybrid Manufacturing Data Preparation

Solid modelling capabilities based on PowerShape - for near-netshape planning and handling of CNC postprocessing.



## Latticing and Topology Optimization

Design for Manufacturing while combining Topology Optimization / Latticing / Mesh Editing in an interactive workflow.



## Process Automation

Script based automation functionality for rich enhancement and UI adaption to custom needs.



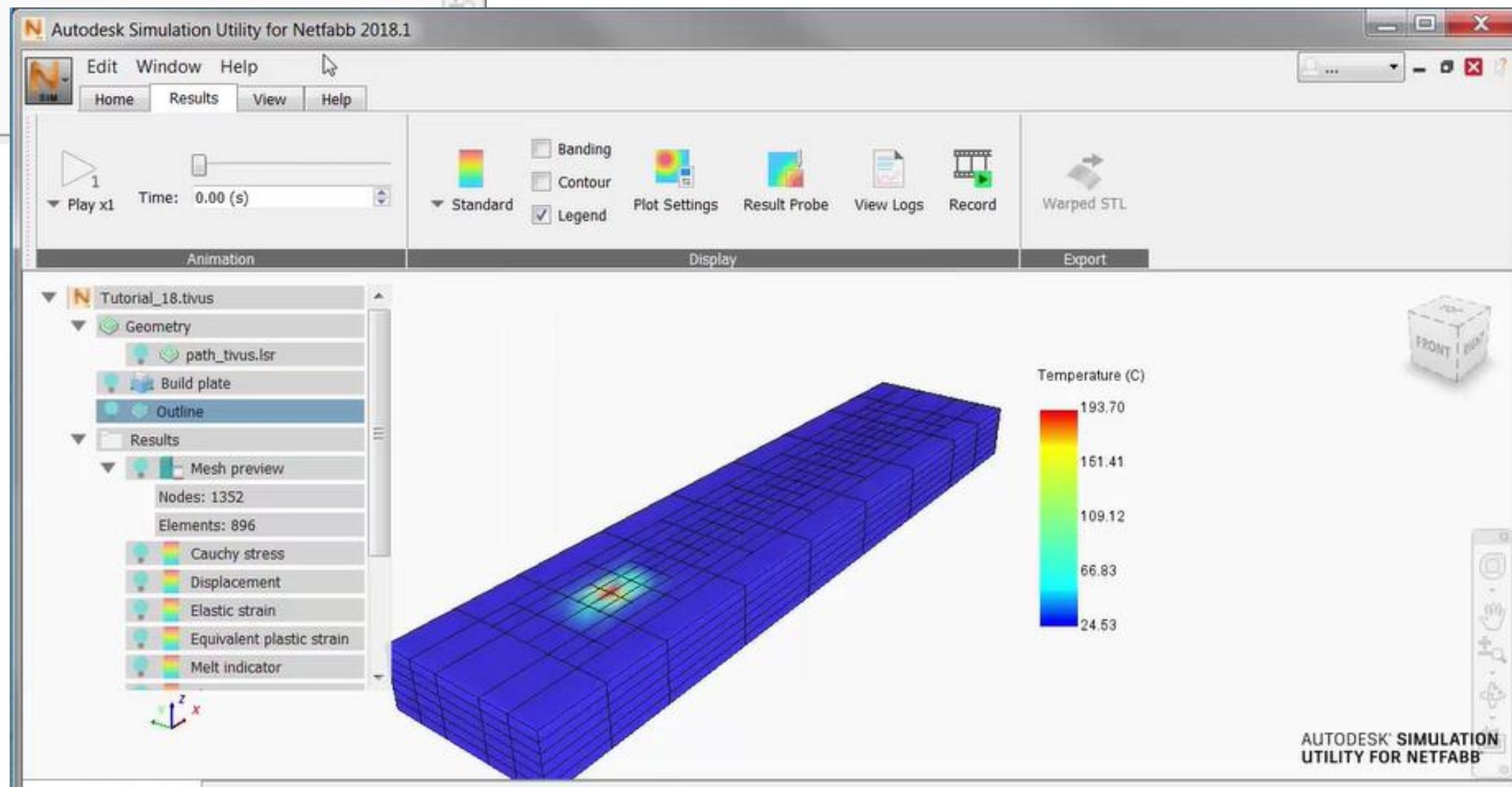
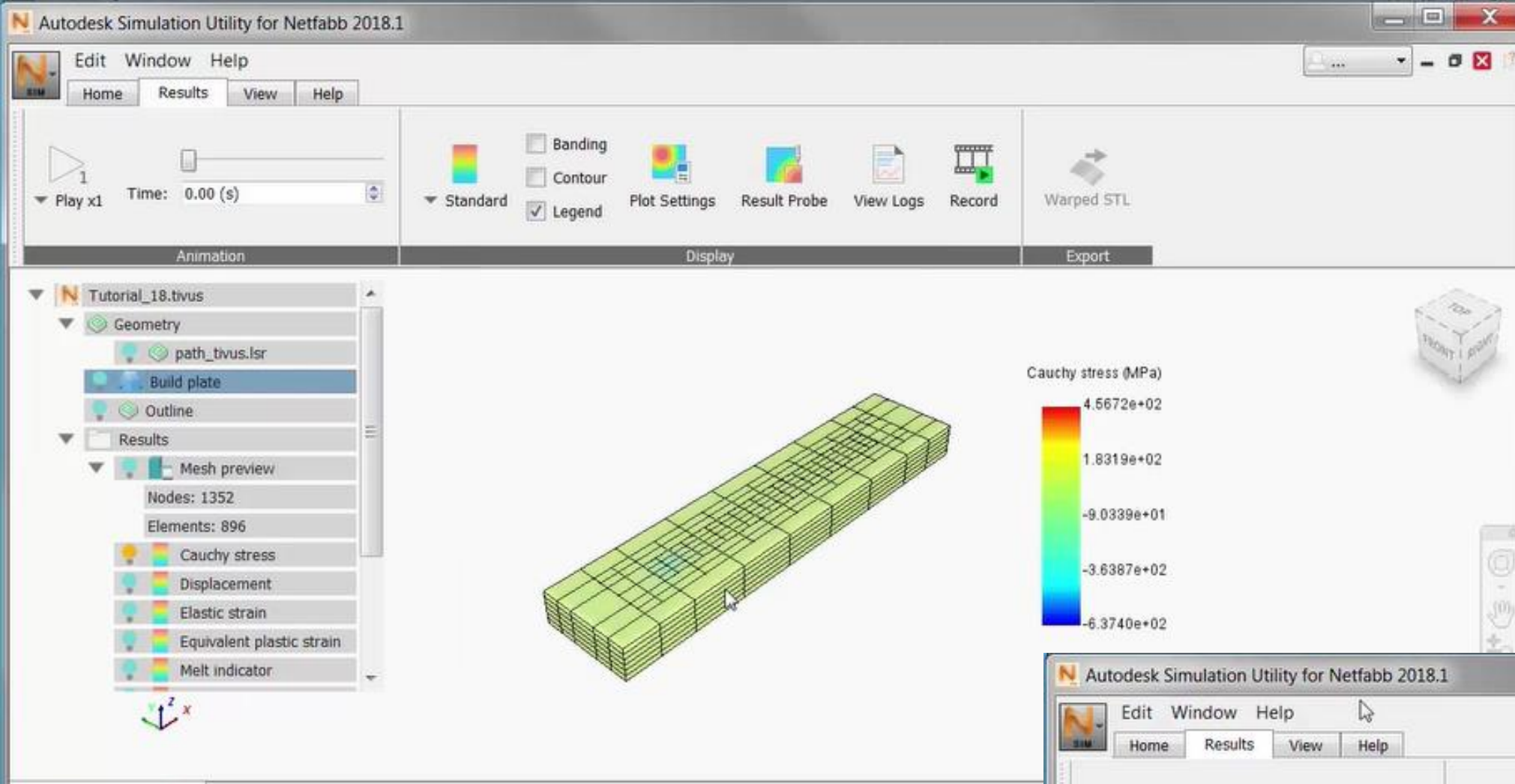



1

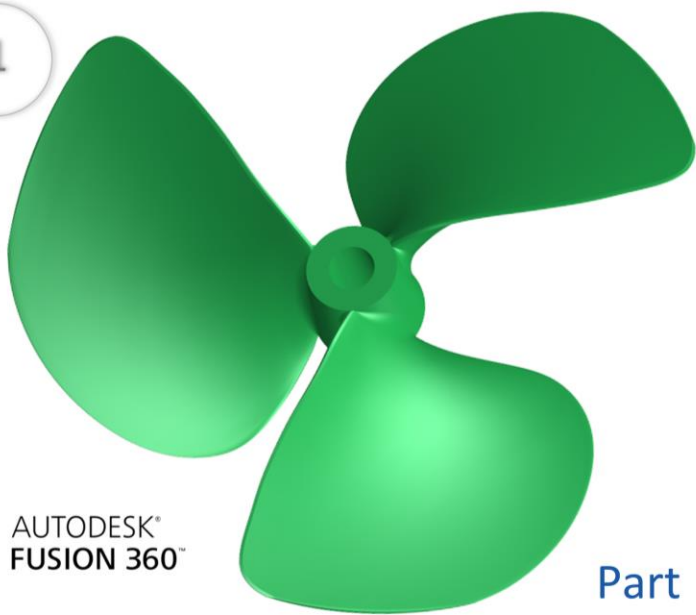

AUTODESK®  
FUSION 360™

Part

2

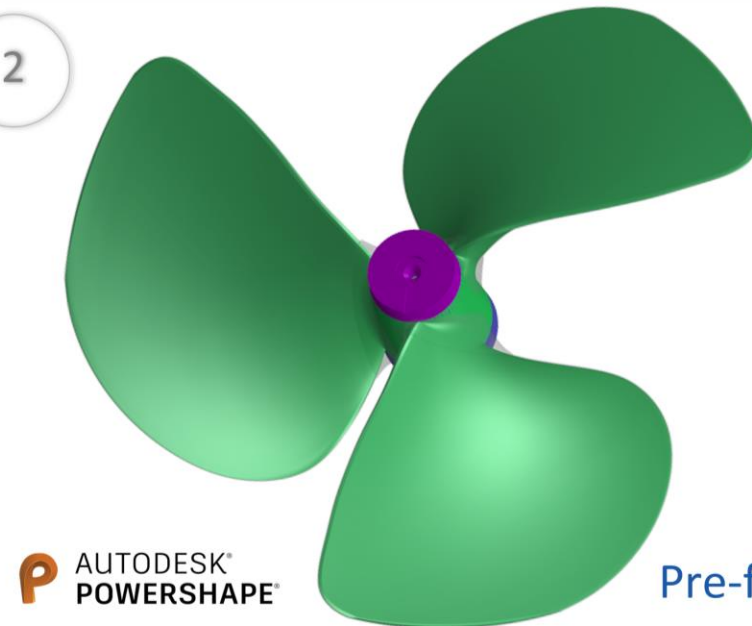

AUTODESK®  
POWERSHAPE™

Pre-form

3

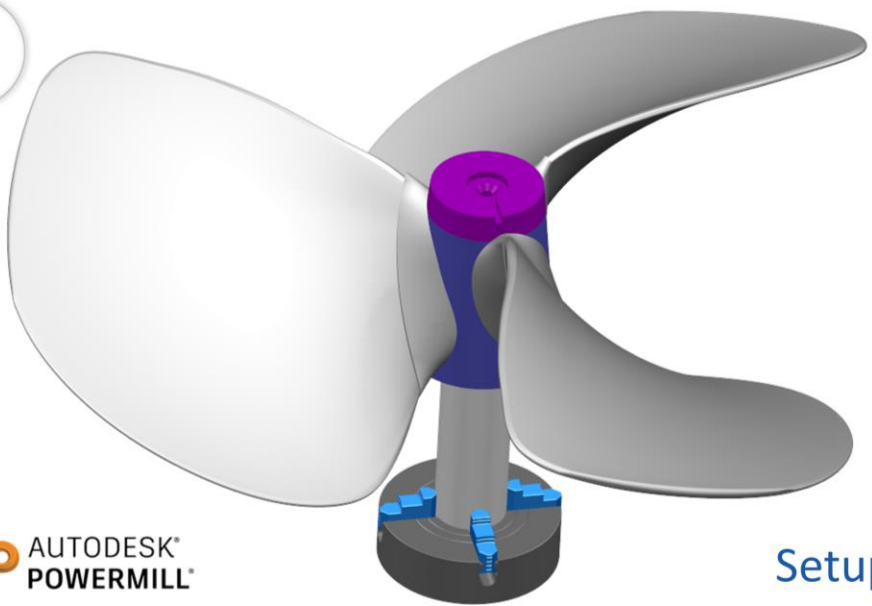

AUTODESK®  
POWERMILL™

Setup

4

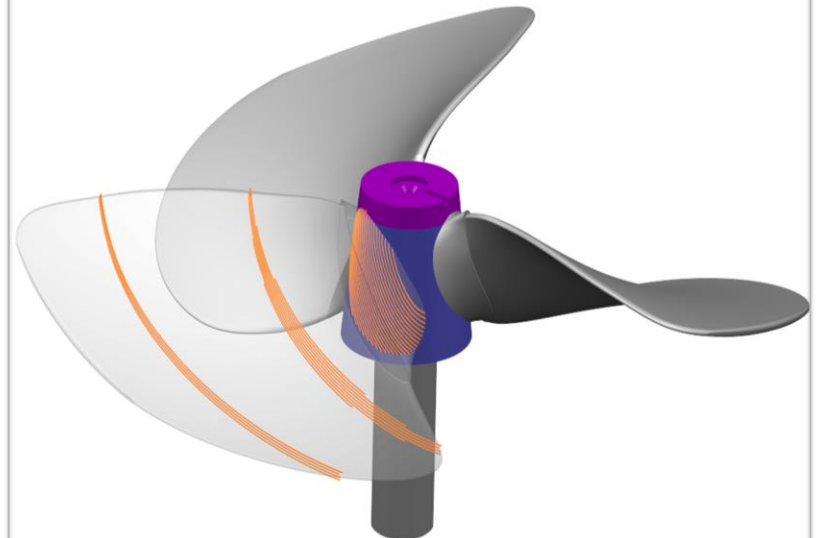

AUTODESK®  
POWERMILL™

Trajectory

5

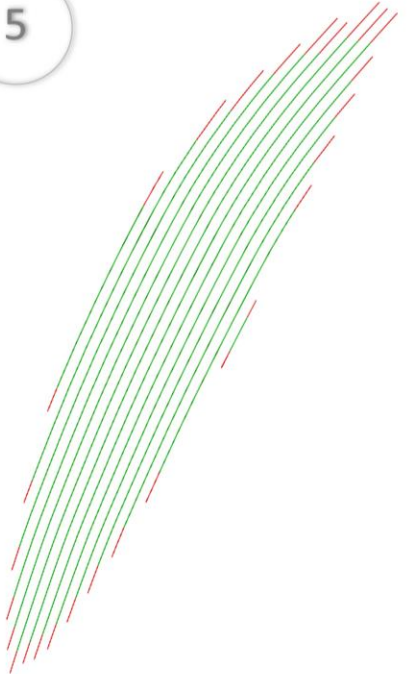

AUTODESK®  
POWERMILL™

Trajectory  
Decoration

6

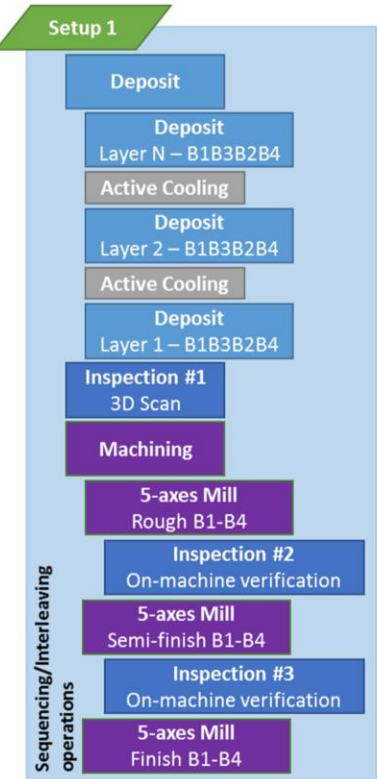

AUTODESK®  
POWERMILL™

Mfg Sequence

7

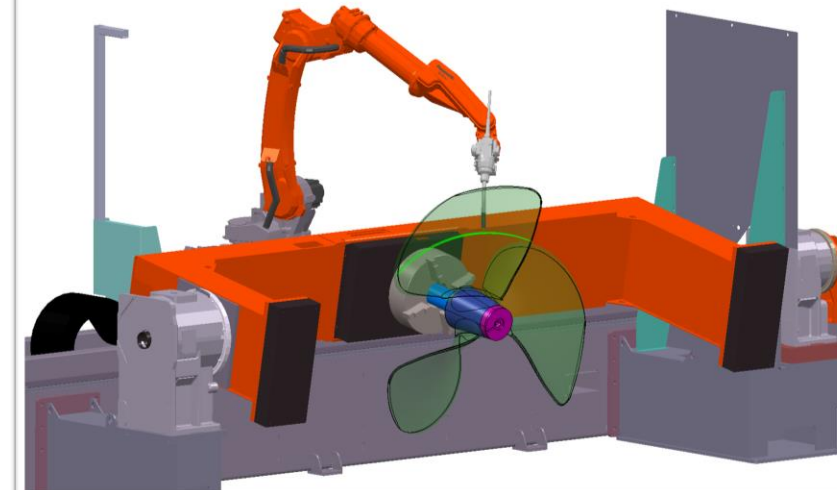

AUTODESK®  
POWERMILL™

Simulation &  
NC Program



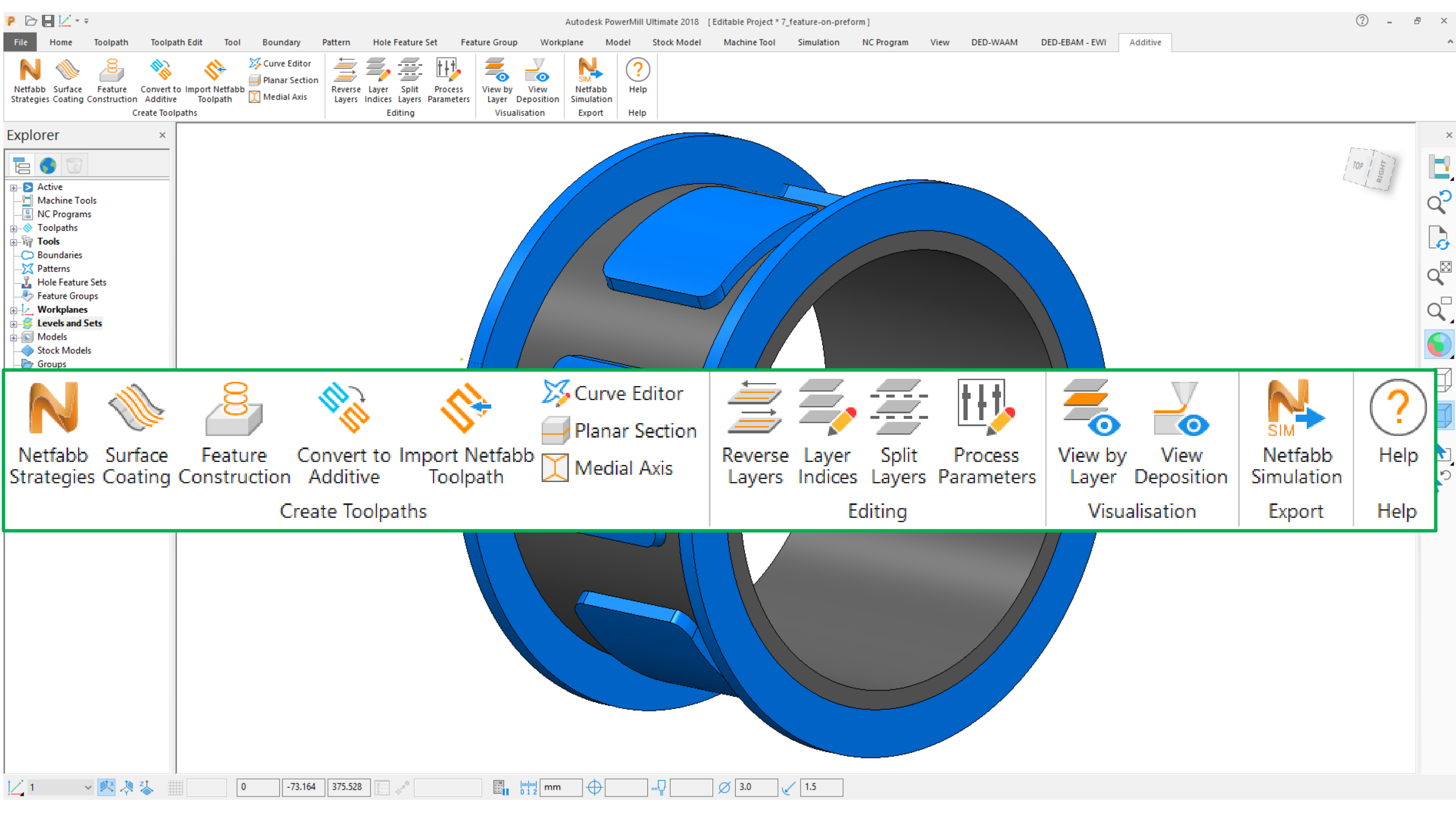



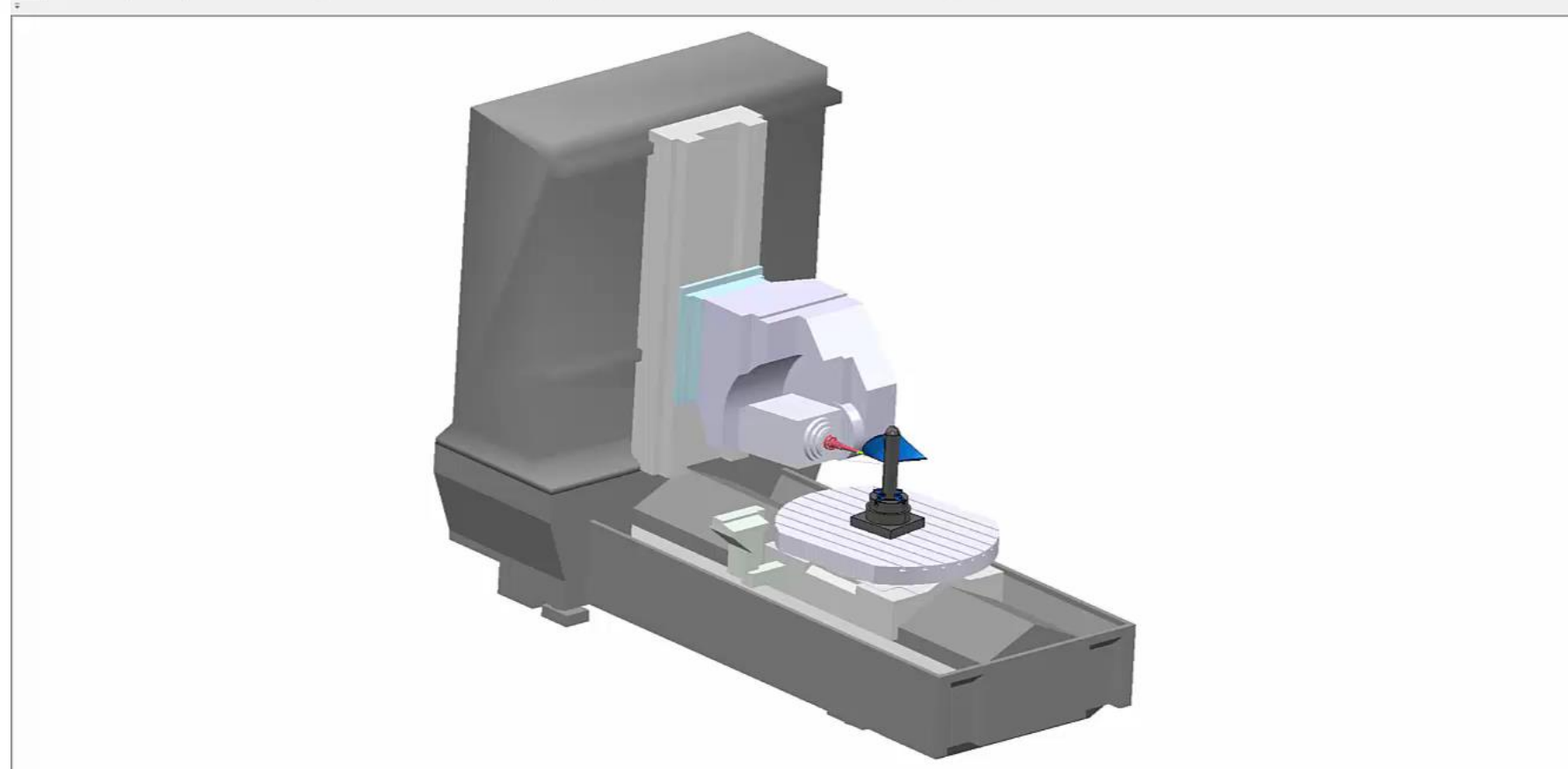
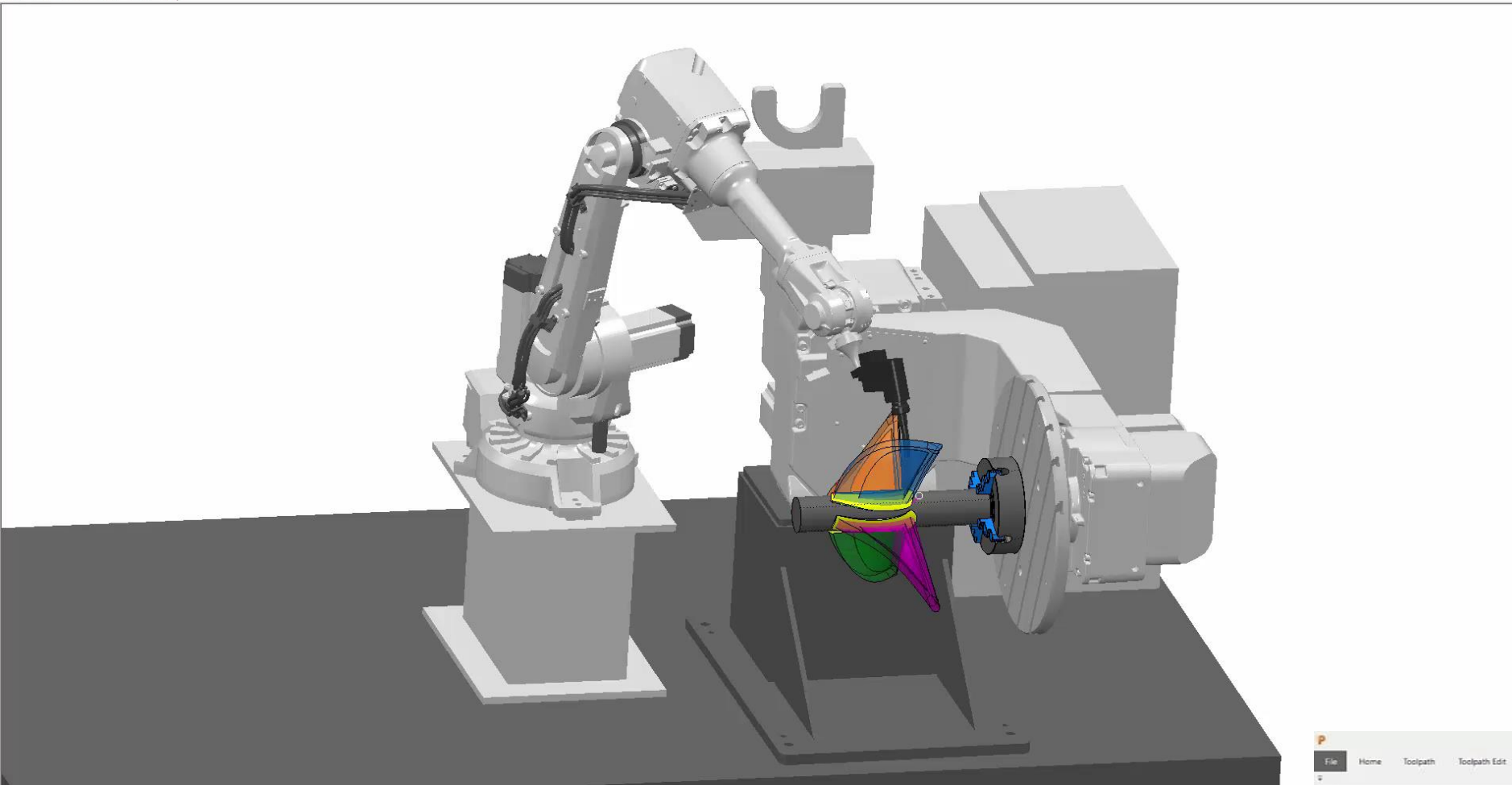



1 – Linear 2.5D  
extrusions – walls  
and bricks

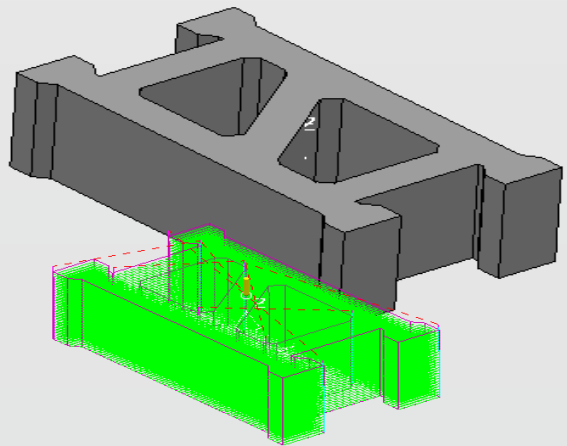

2 – Surface of  
revolution – buckets

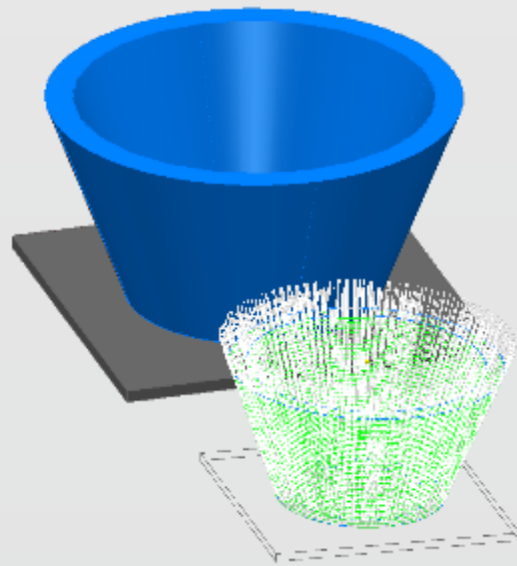

3 – Features – on  
cylinders, planes  
and arbitrary bases

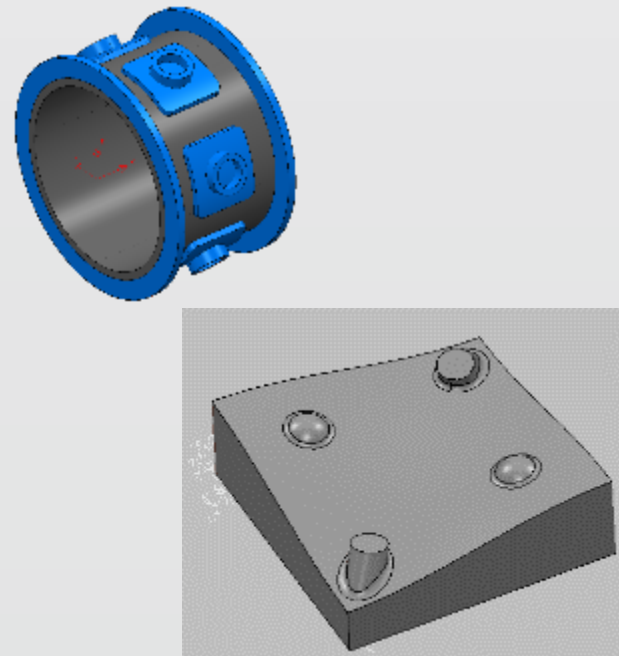

4 – Surface coating  
– patches and single  
layers

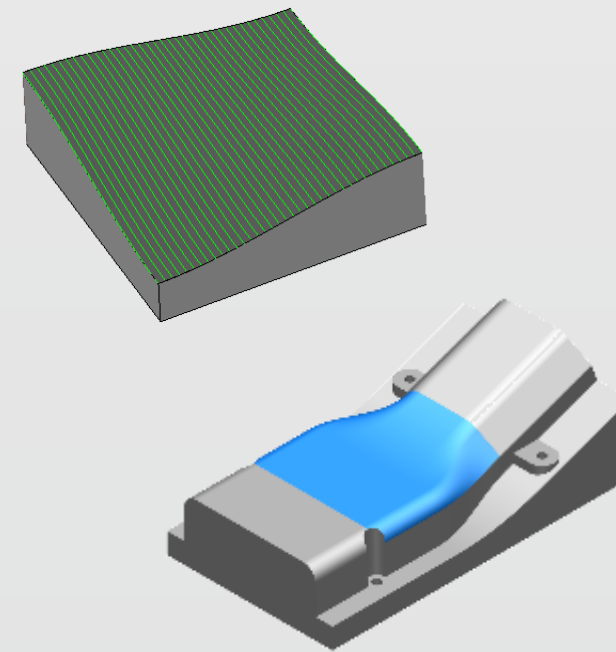

5 – Coaxial features  
– 360deg

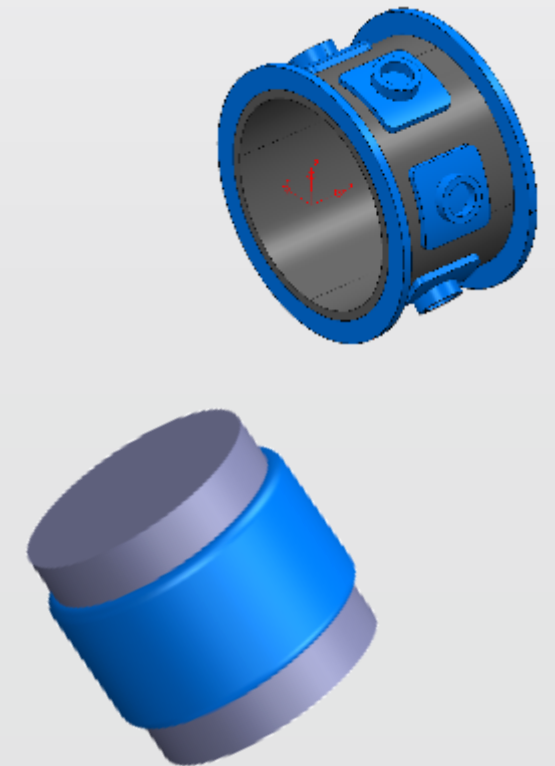



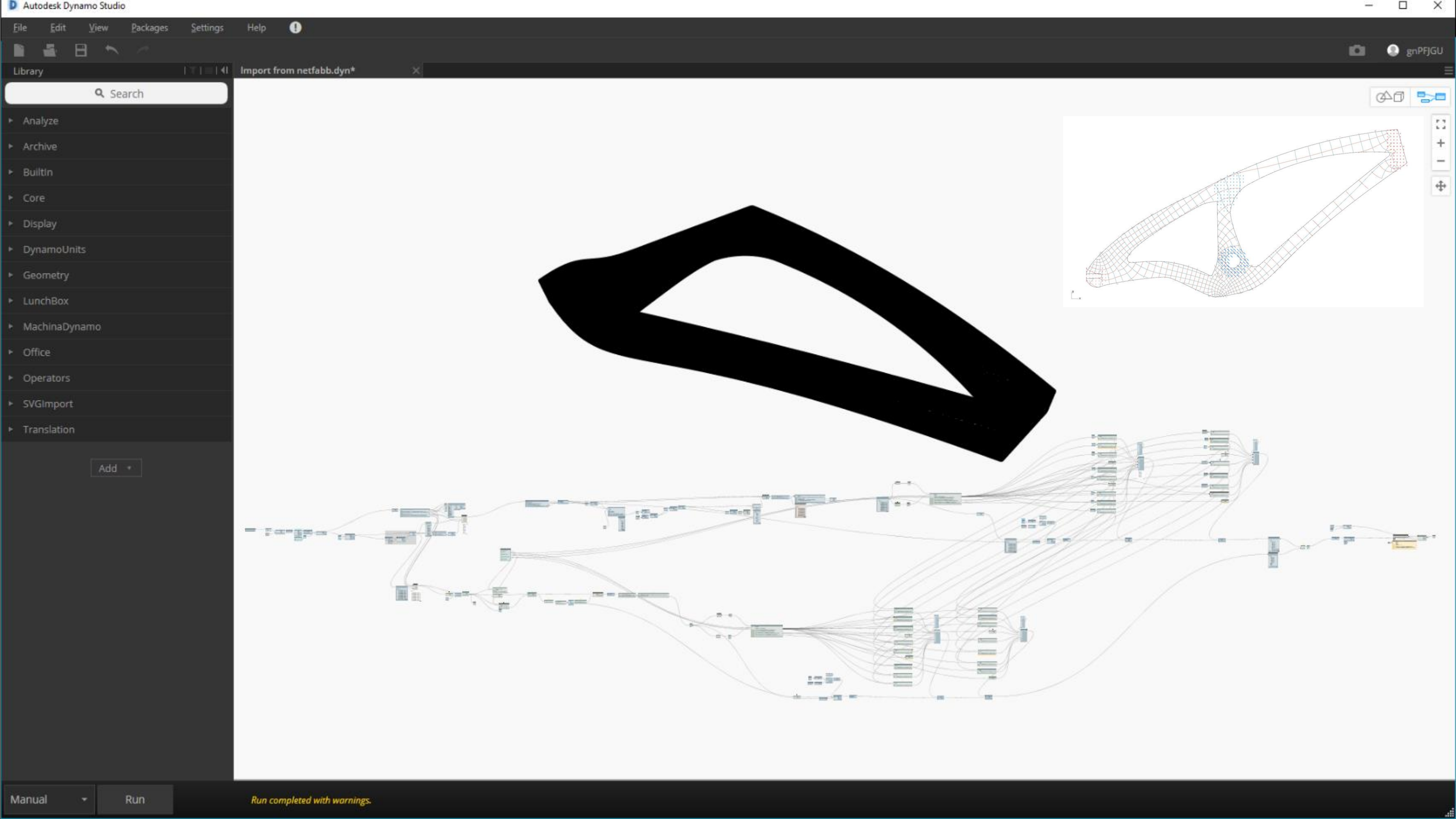



RS\_IRB120\_STATION - Abb RobotStudio 6.03 (64-bit)

File Home Modeling Simulation Controller RAPID Add-Ins

Request Write Access Release Write Access Synchronize Access Edit Insert Find Apply Adjust Robtargets Selected Tasks Start Stop Breakpoint Check Program Program Pointer RAPID Profiler

Joint jog: IRB120\_3\_58\_01

-165.00	0.00	165.00	<	>
-110.00	0.00	110.00	<	>
-110.00	0.00	70.00	<	>
-160.00	0.00	160.00	<	>
-120.00	90.00	0.00	<	>
-400.00	0.00	400.00	<	>

CFG: 0.000  
TCP: 302.00 0.00 558.00  
Step: 1.00 dec

Controller Files

Current Station

- IRB120\_System
  - HOME
  - Configuration
  - Event Log
  - I/O System
  - RAPID
    - T\_ROB1
      - Program Modules
        - ERobotProgram

View1 x

Output Search Results

Show messages from: All messages

	Time
(i) IRB120_System (Station): 10002 - Program pointer has been reset.	7/27/2016 6:59
(i) Loaded C:\DynamoBRobotCode.mod to T_ROB1	7/27/2016 6:59
(i) IRB120_System (Station): 10052 - Regain start	7/27/2016 6:59
(i) IRB120_System (Station): 10053 - Regain ready	7/27/2016 6:59
(i) IRB120_System (Station): 10151 - Program started	7/27/2016 6:59

Autodesk Dynamo Studio

File Edit View Packages Settings Help

01\_Berlin\_holocaust\_memorial\_C

Library

DynamoBRobot.ExportToFile

code string  
filepath

Watch

```
4 List
[0] MODULE BRobotProgram
[1]
[2] CONST speeddata vel200:=[20
[3]
[4] CONST zonedata zone2:=[FALS
[5]
[6] CONST jointtarget target0:=
[7] CONST robtarget target1:=[[
[8] CONST robtarget target2:=[[
[9] CONST robtarget target3:=[[
[10] CONST robtarget target4:=[
[11] CONST robtarget target5:=[
[12] CONST robtarget target6:=[
[13] CONST robtarget target7:=[
[14] CONST robtarget target8:=[
[15] CONST robtarget target9:=[
```

Successfully saved to C:\DynamoBRobotCode.mod

Saving C:\Users\t\_garcjos\AppData\Roaming\Dynamo\Dynamo Core\backup\01\_Berlin\_holocaust\_memorial\_C.dyn ...  
Backup file is saved: C:\Users\t\_garcjos\AppData\Roaming\Dynamo\Dynamo Core\backup\01\_Berlin\_holocaust\_memorial\_C.dyn ...  
Saving C:\Users\t\_garcjos\AppData\Roaming\Dynamo\Dynamo Core\backup\01\_Berlin\_holocaust\_memorial\_C.dyn ...  
Backup file is saved: C:\Users\t\_garcjos\AppData\Roaming\Dynamo\Dynamo Core\backup\01\_Berlin\_holocaust\_memorial\_C.dyn ...  
Saving C:\Users\t\_garcjos\AppData\Roaming\Dynamo\Dynamo Core\backup\01\_Berlin\_holocaust\_memorial\_C.dyn ...





# Dynamo

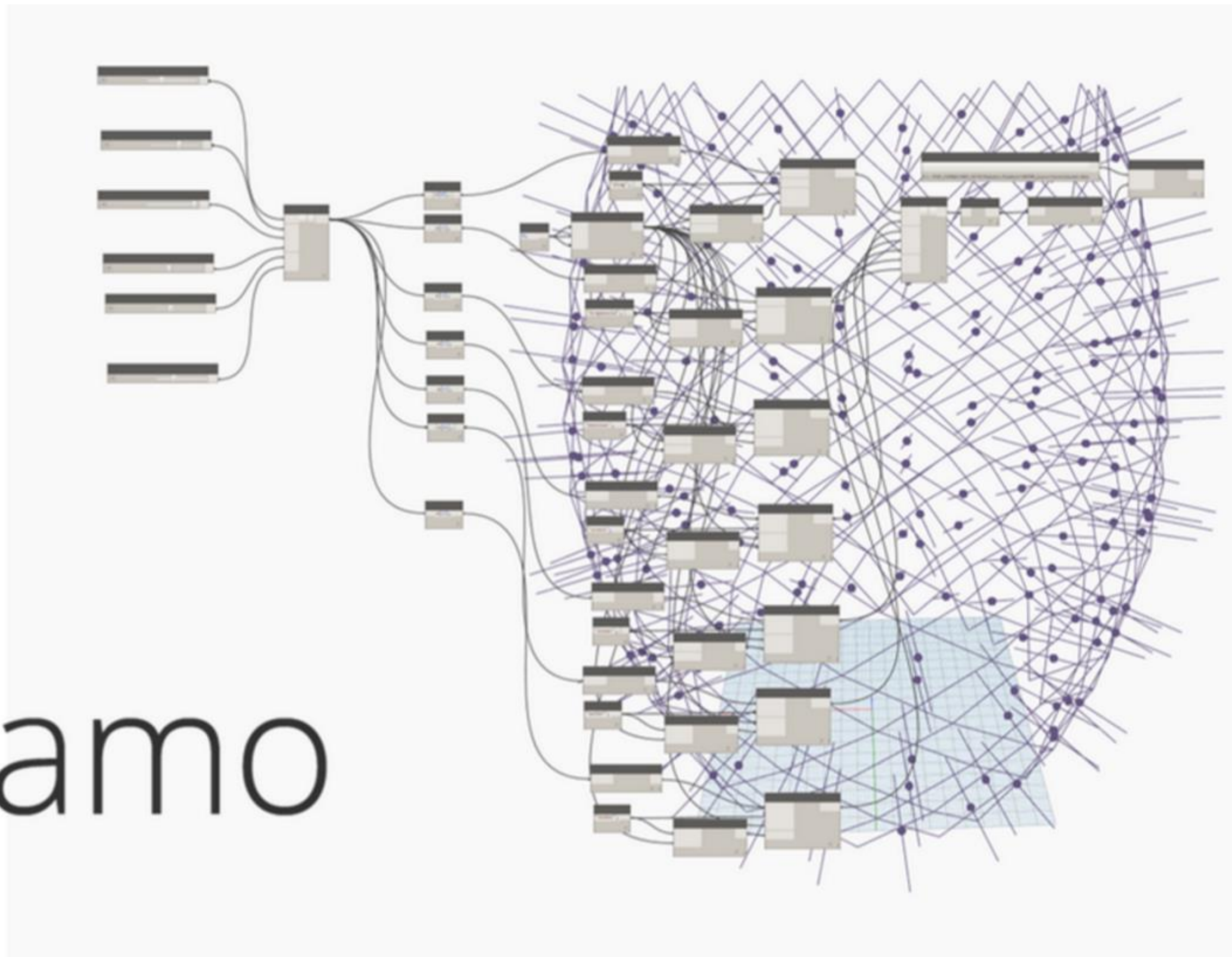



N

M

T

D

A

F

P

M



AUTODESK®

G

C

R

V

3

I

B

N

P











