



Annotation Scaling in AutoCAD: Bringing the Technology Home

KaDe King

Technical Specialist\Training Manager at U.S. CAD

Class Summary

Learn how to implement annotation scaling in your organization! Whether you would like to start with baby steps or go full bore, you will learn all levels of migrating these tools into your daily workflow. Learn about annotation scaling and how it works with hatching, text, linetype scale, dimensions, and all of the other options. See how you can "bring this technology home," improve your productivity, and reduce unnecessary hours spent on annotations.

Learning Objectives

At the end of this class, you will be able to:

- Spend less time annotating drawings
- Explain annotation scaling
- Integrate annotation scaling into your current workflow & update existing drawings
- Understand annotation commands, tools, and styles

Doing the Linetype Dance!

Ready for printing:

LTSCALE=1 (or something similar)

PSLTSCALE=1

Looks good here!

What Happened?

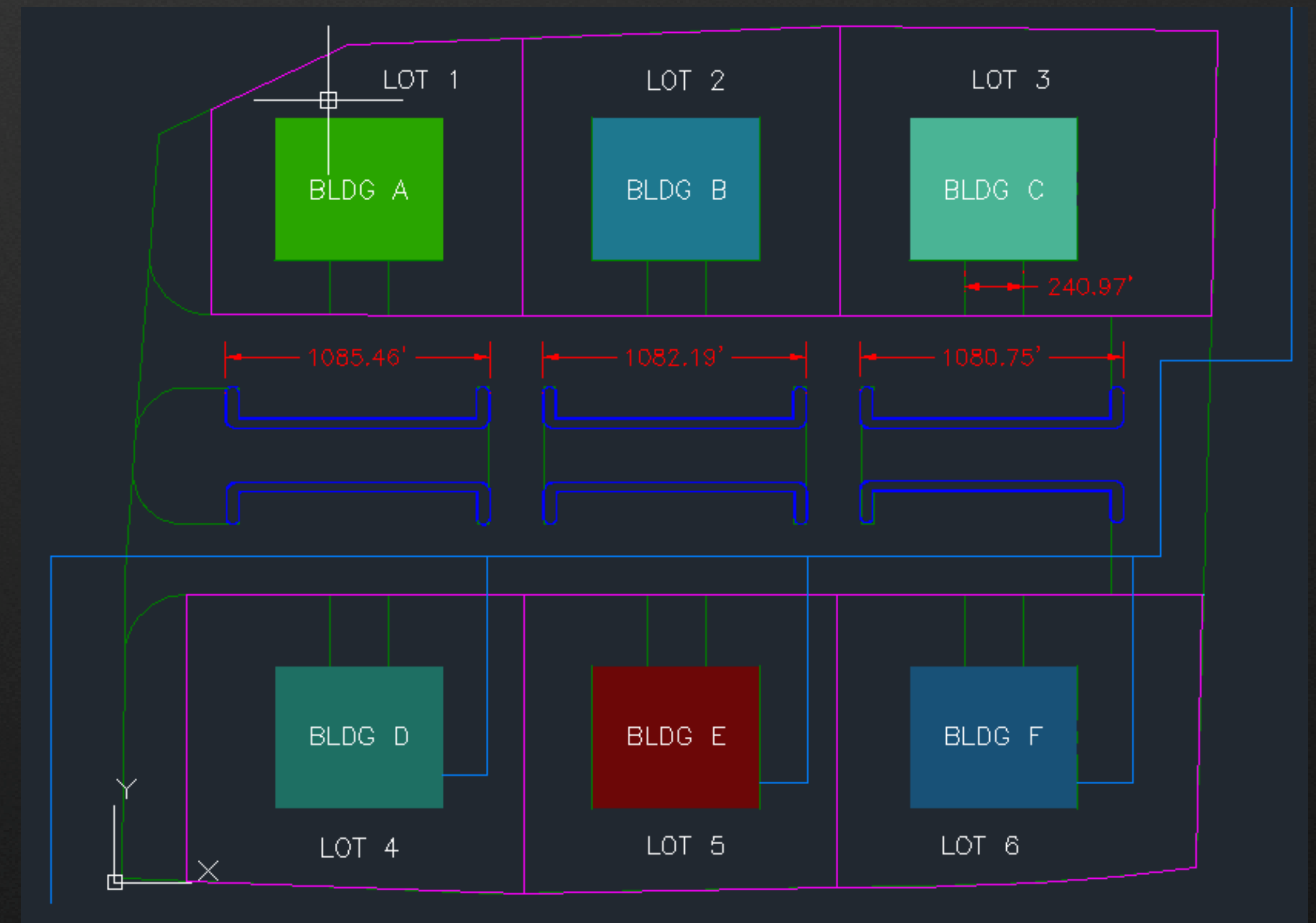
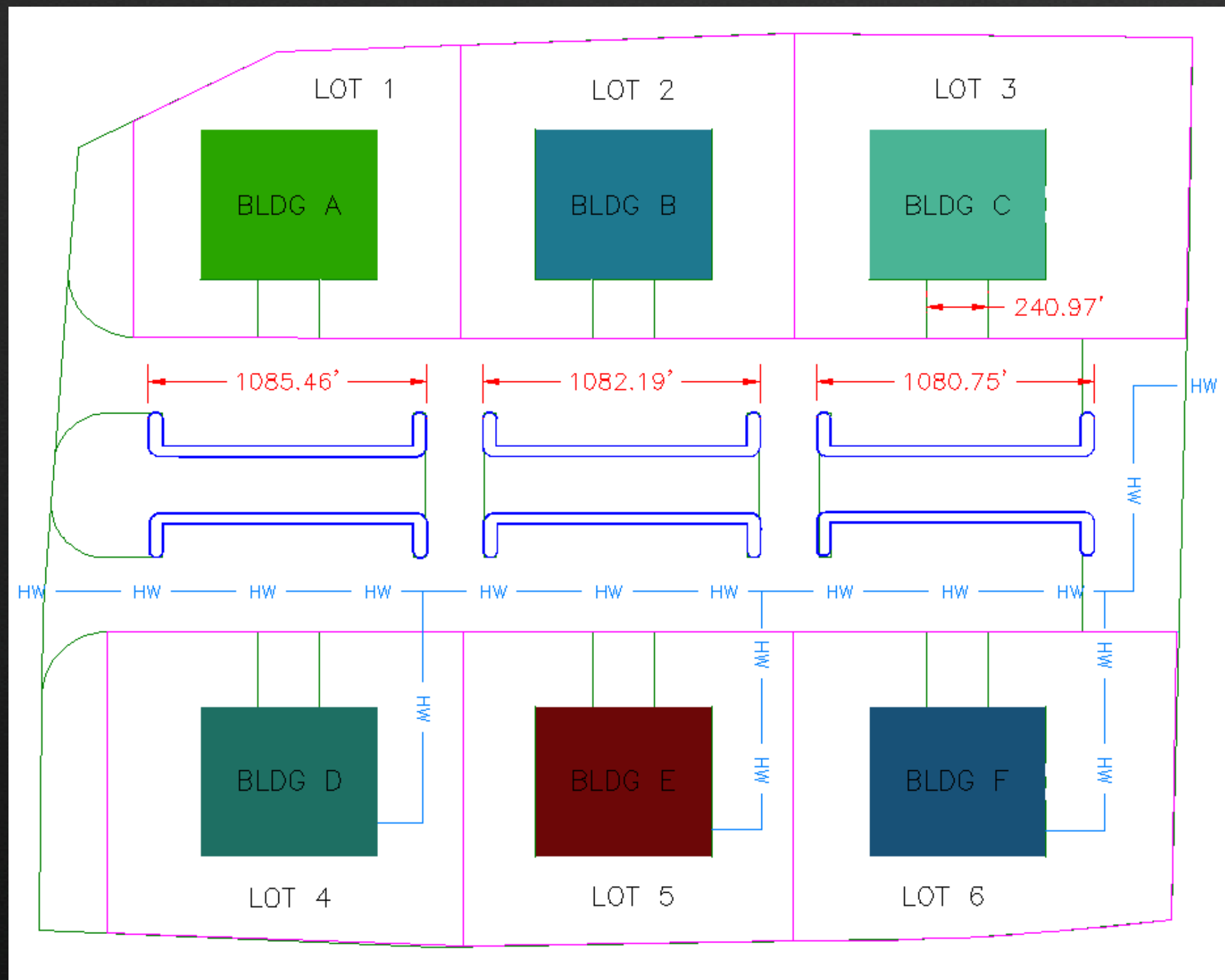

Doing the Linetype Dance!

Ready for printing & viewing!

LTSCALE=1 (or something similar)

PSLTSCALE=1

MSLTSCALE=1

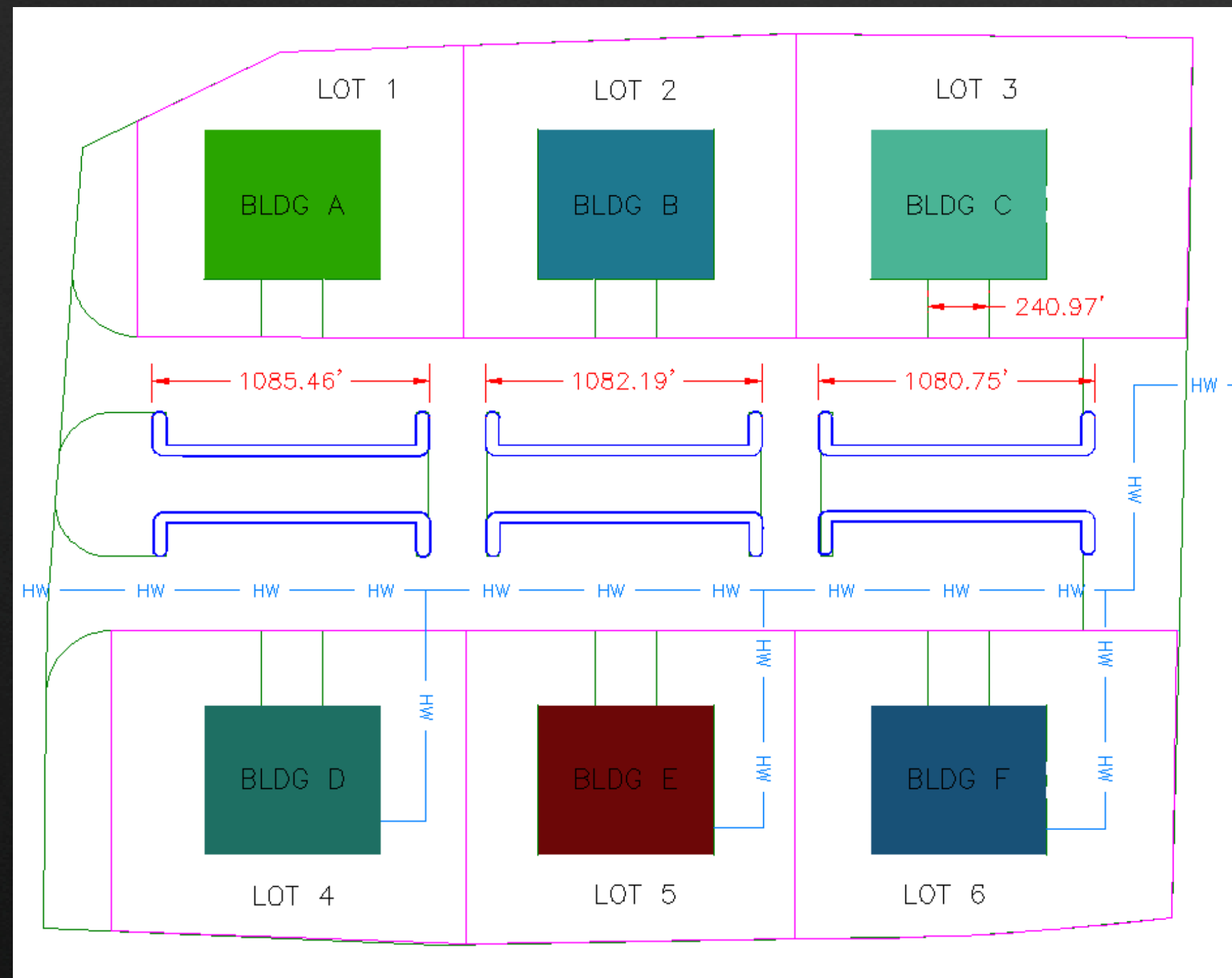

Now they both look good!

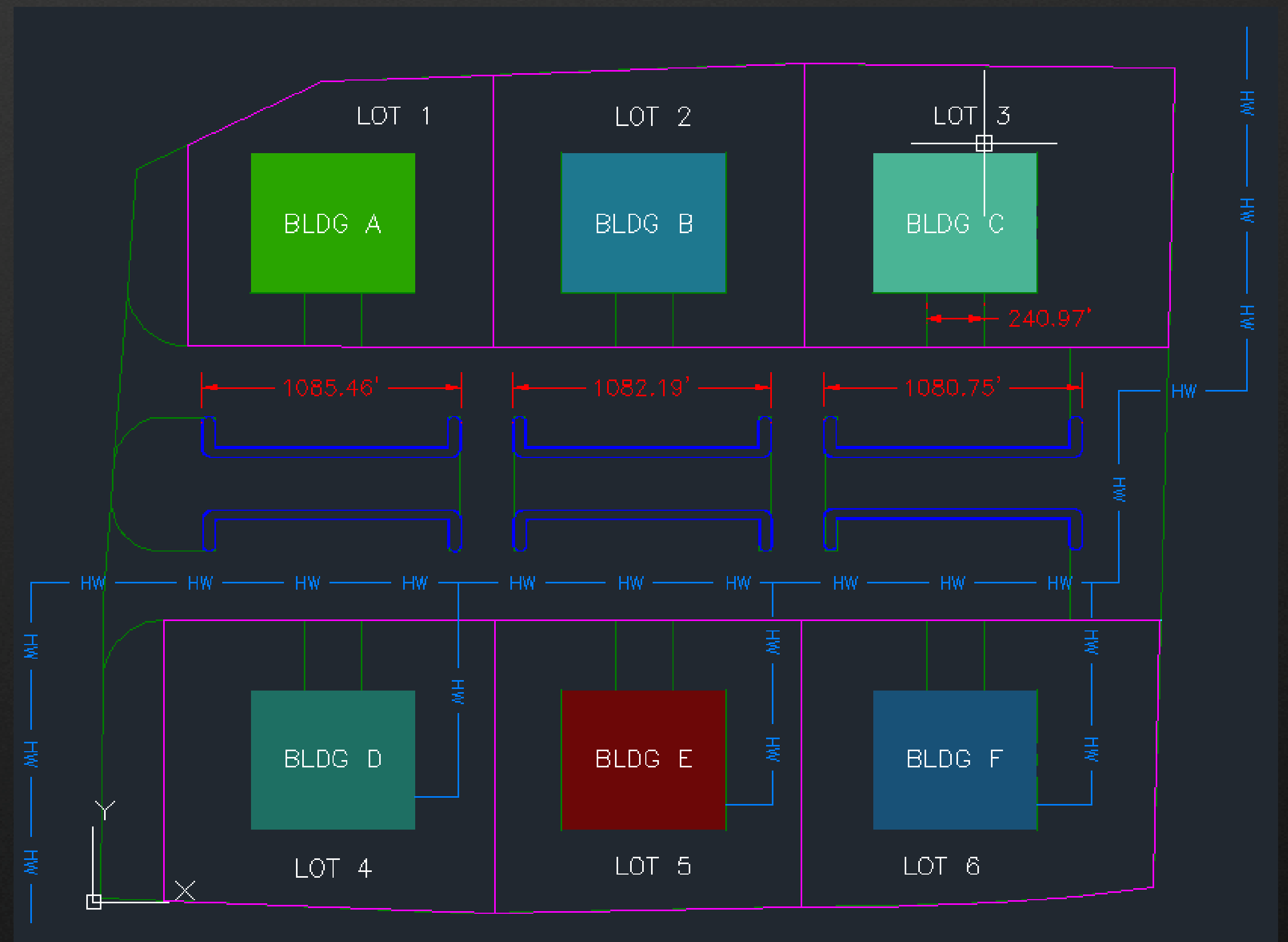

Doing the Layer Dance!

- Do you have multiple dimension styles for each scale factor that you use?
- Do you have a layer for every scale factor that you use?
- Do you have to create multiple versions of the same text, dimension, etc... for each scale factor that you use?
- Do you have to freeze layers for every viewport for all of the annotation layers that you're NOT using for that viewport?

Before Annotation Scaling

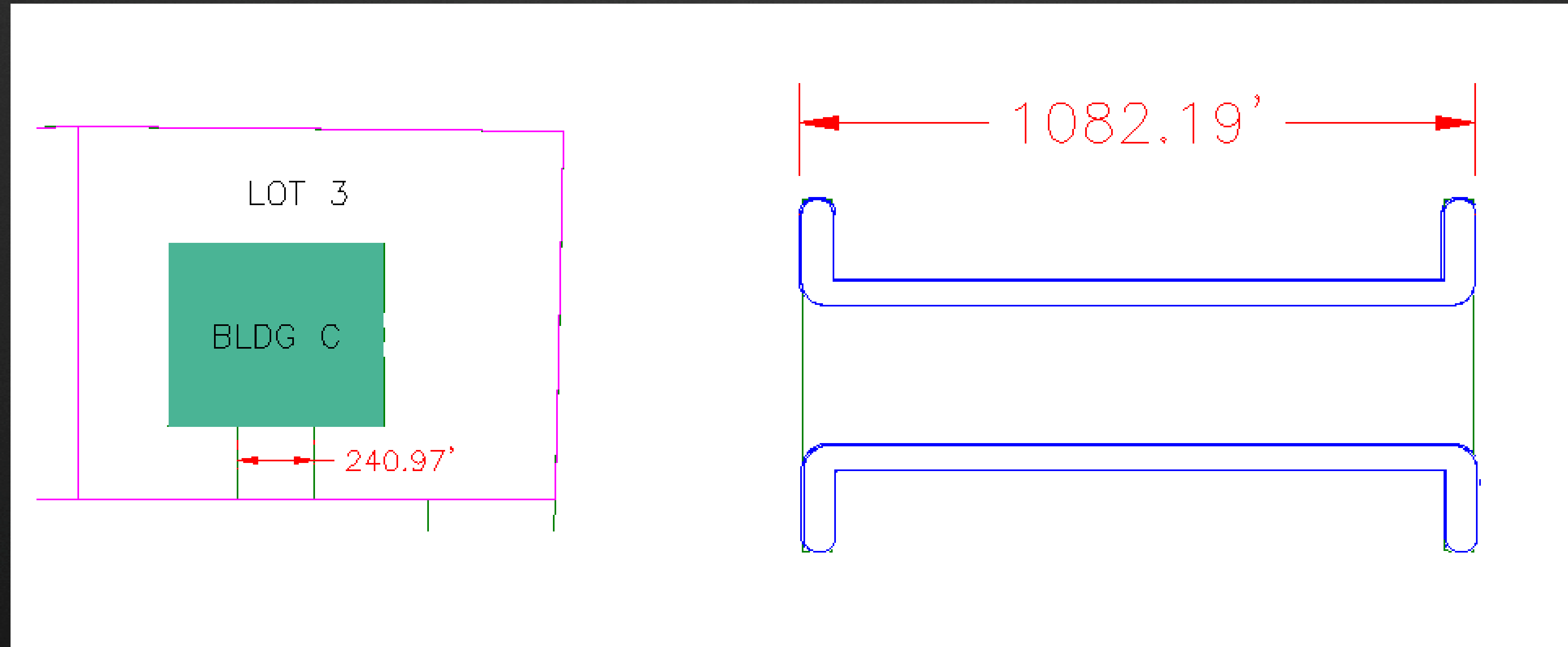

After Annotation Scaling

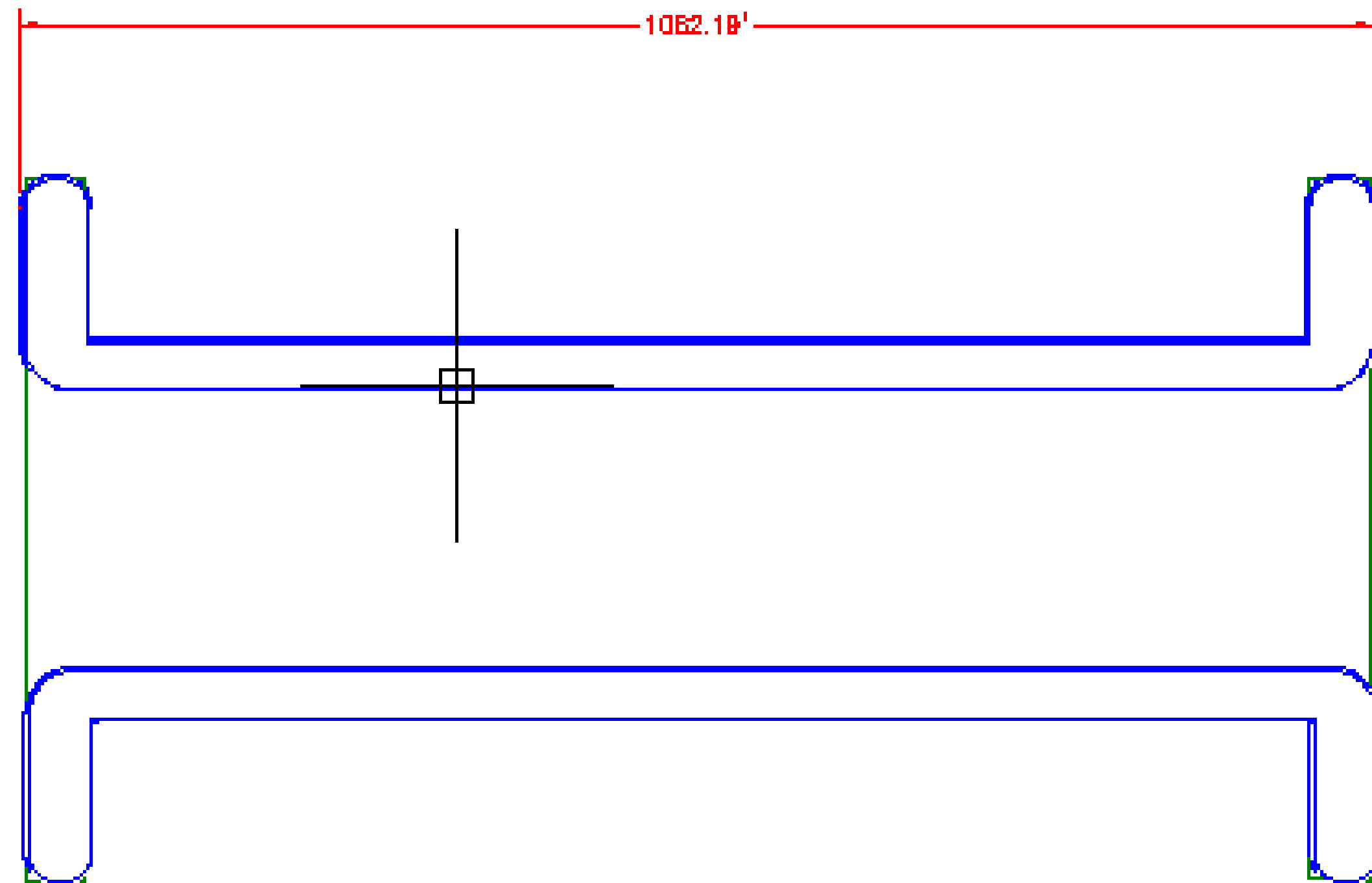
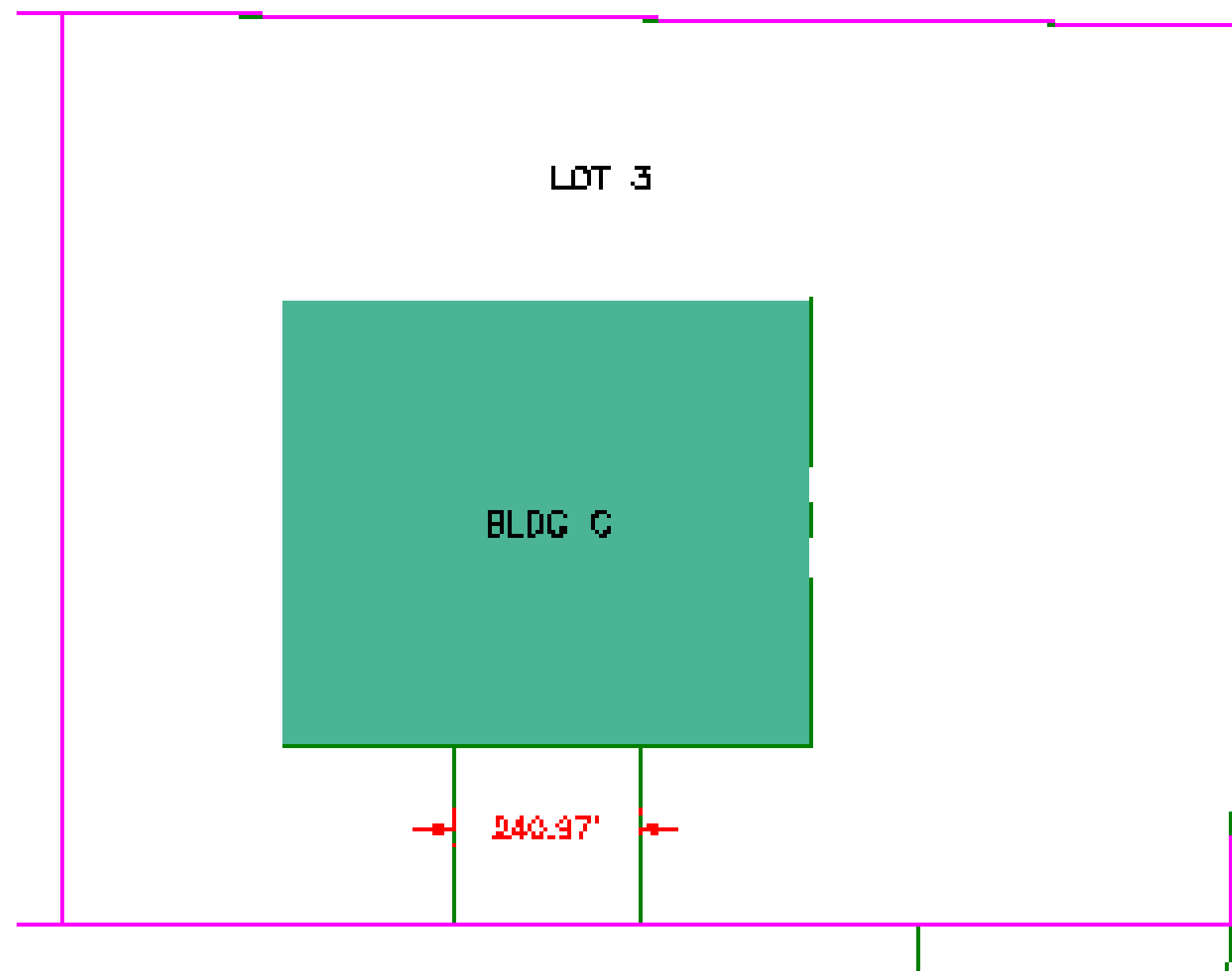

Three things you need to know!

- Annotative Styles set current

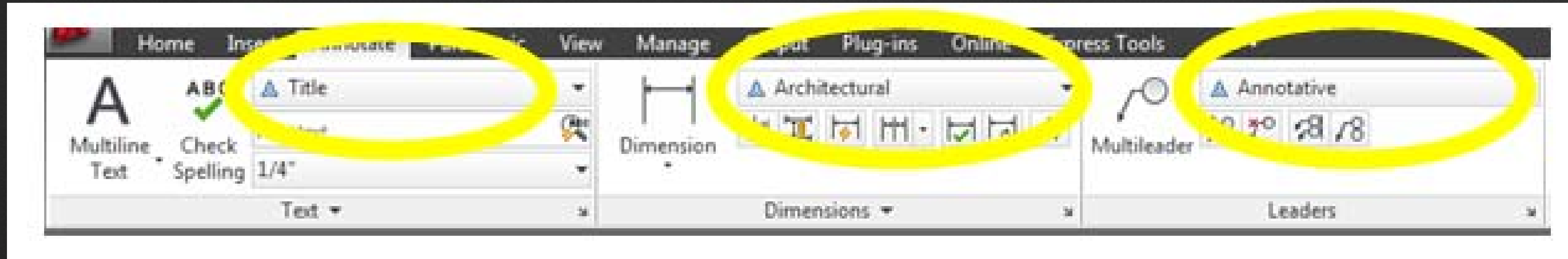

- Annotative Scale set appropriately

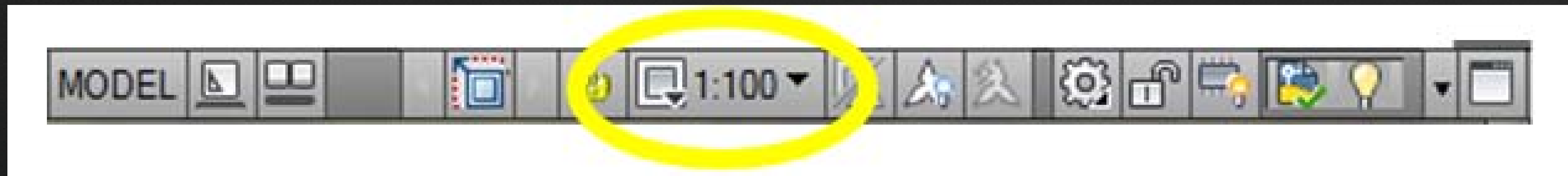

- Understand what ANNOAUTOSCALE does

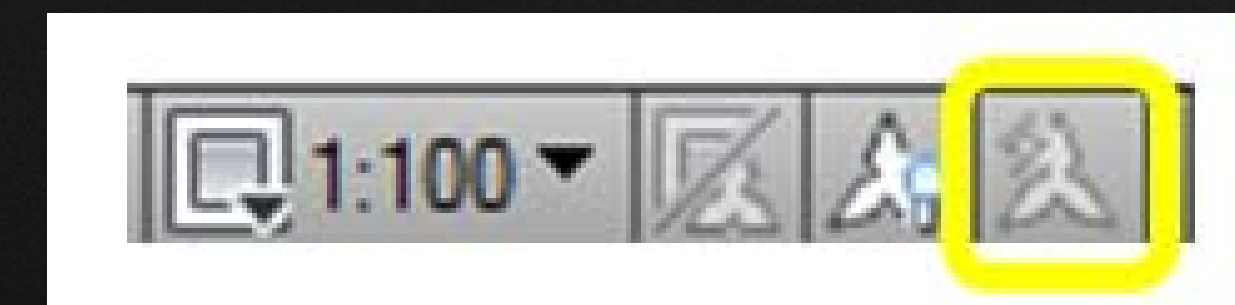

What can be Annotative?

- Linetypes
- Text
- Dimensions
- Multileaders
- Hatches
- Blocks
- Attributes

Annotation Tools

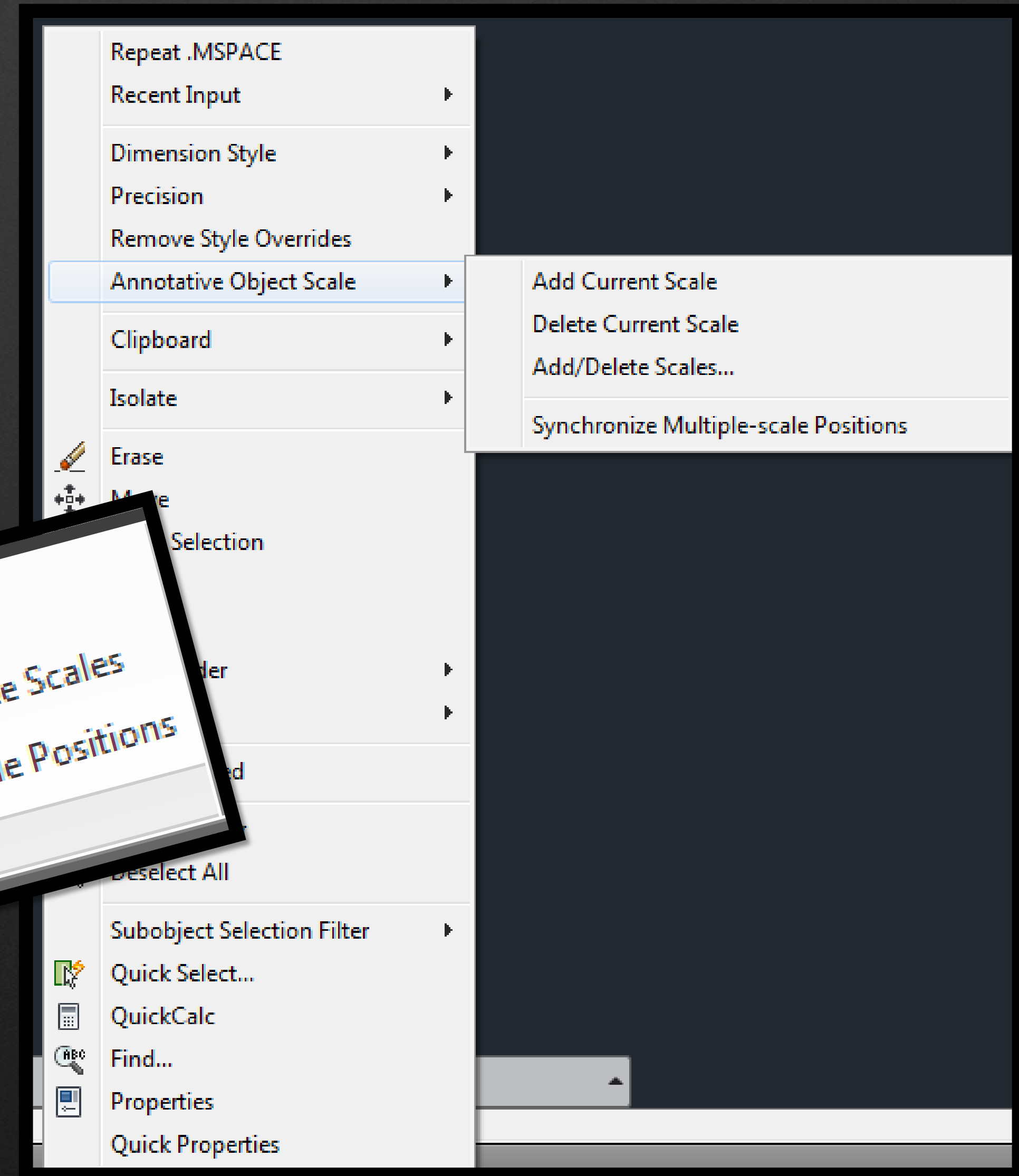
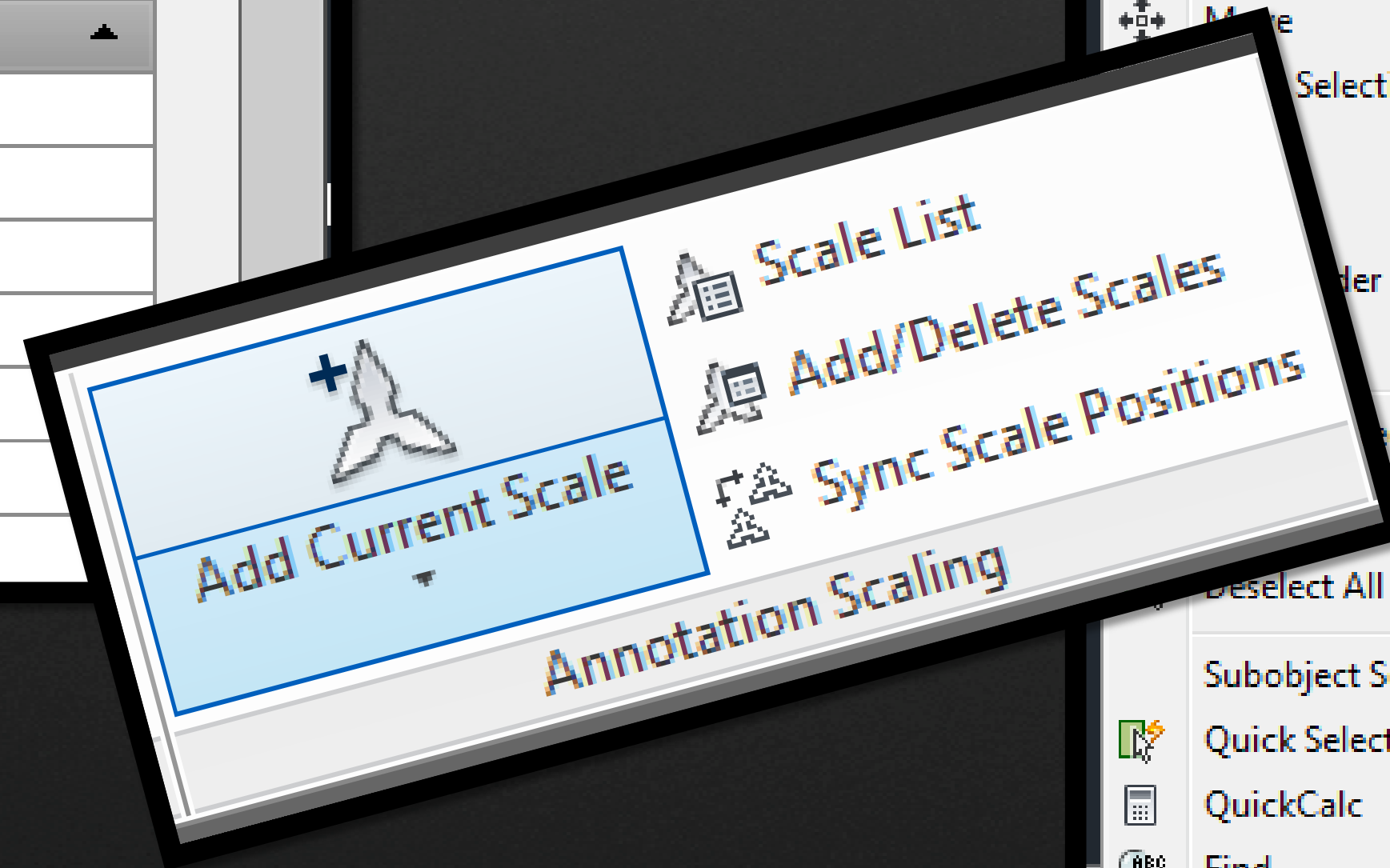
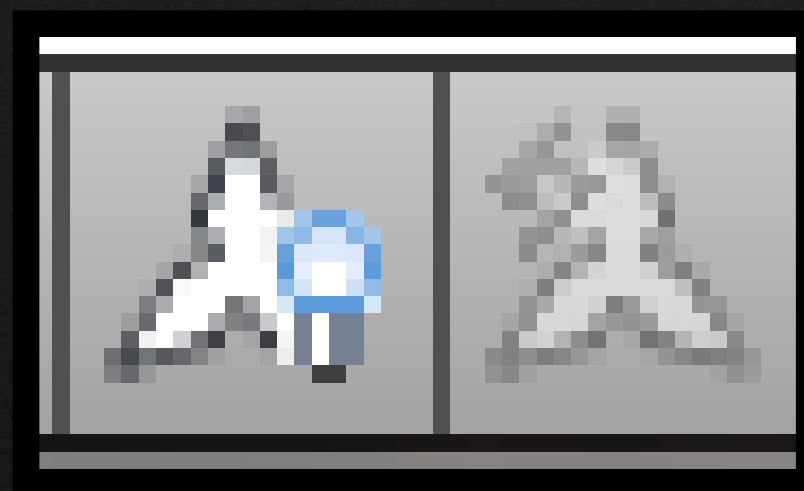
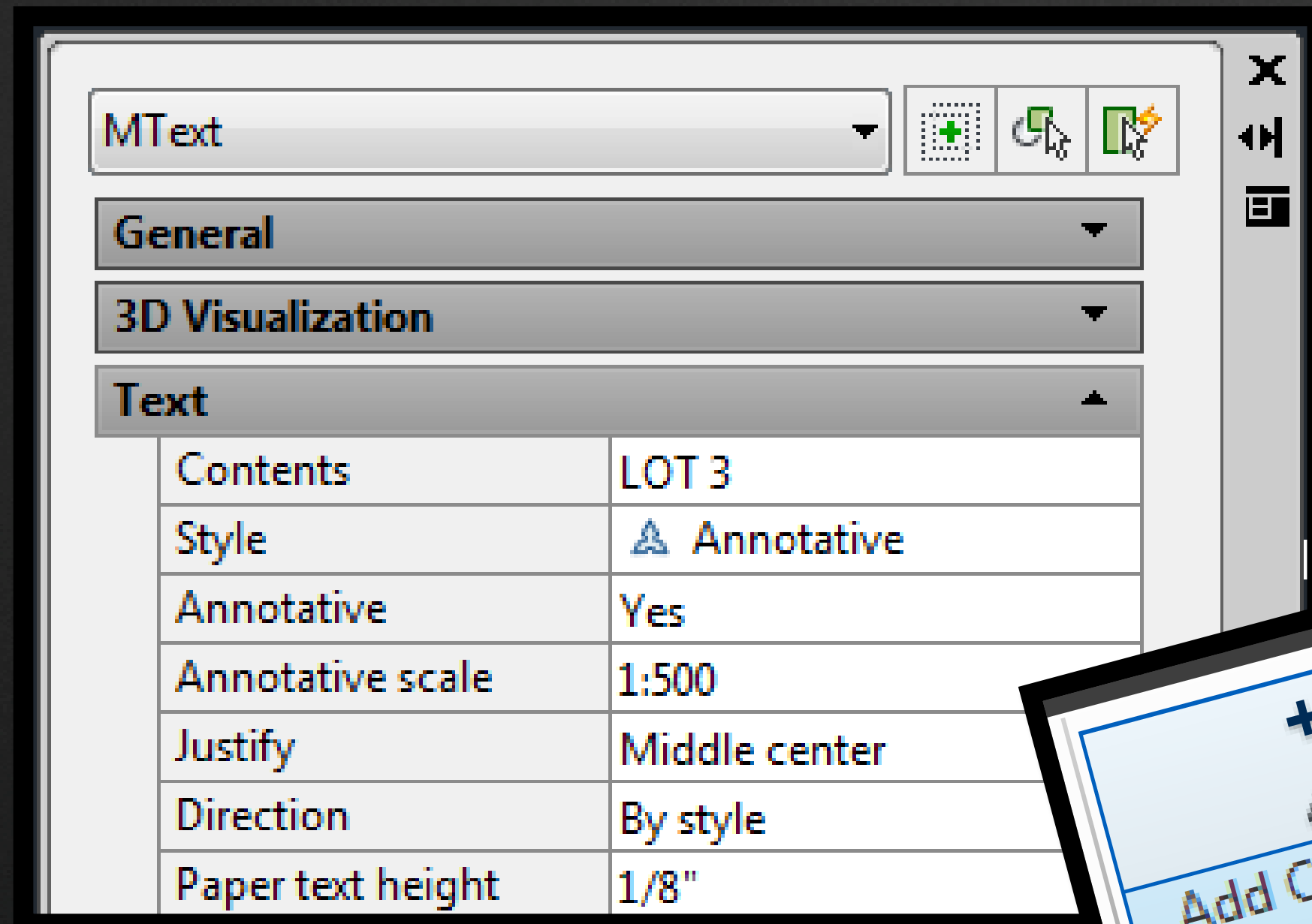

Changing Existing Drawings to Annotative Scaling

1. Bring annotative text, dimension, and multileader styles into the current file (try using Design Center!).
2. Identify dimensions, text or multileader objects that need to be converted to annotative objects.
3. Set the annotative scale current that you would like to apply to your objects.
4. Use QSELECT or manually select the objects you want to change.
5. When the objects are selected, go to the PROPERTIES palette.
6. Change the STYLE assigned to the objects to the correct annotative style.
7. If the ANNOTATIVE setting (in Properties) is not set to YES then change it to YES.

Integrating Annotative Scaling into your Organization's Workflow

- What functionality do we need/want?
- Who is going to update the organizations templates and CAD Standards?
- What functionality should be integrated first?
- Should we roll out all functionality at the same time?
- How and when should our CAD users be trained on the new standards?

What “level” of integration do you need?

We only want to “dip our toes” into the annotative pool. **(starting small)**

- Linetype scale integration

We want to use annotative scaling but we only have the resources to “wade” in. **(middle ground)**

- Starting small PLUS Hatches, Text, Dimensions, and Multileaders

We want to use all of the annotative features! We are ready to “dive” in! **(full bore)**

- Middle ground PLUS Annotative Blocks & Attributes

Train everyone who will be using the drawings!

- Meet to discuss changes and demonstrate the new standards and workflows.
- Provide online or live training so that the users can try out the new workflows.
- Provide workflow documentation for the users.

Class Number: AC2512

Presenter: KaDe King

Email: KaDe.King@uscad.com

